

Szklane klamerki typu D 316 polerowane ze stali nierdzewnej (model G102)

1. Szczegółowe informacje dotyczące G102

- MOQ 100 szt
- Do szkła 8-10mm
- Wykończenie ze stali nierdzewnej 304/316, polerowane lub satynowe
- Wymiar 44x44x25mm

2. zdjęcia do klucza kwadratowego typu D 316 z polerowanego szkła nierdzewnego (model G102)







3. różne modele zacisków ze stali szlachetnej typu D 316 ze stali nierdzewnej

| | |
|----------|-------------------------|
| Material | Stainless steel 304/316 |
| Finish | satın / mirror polished |

| | |
|---------------------|-------------------------|
| Material | Stainless steel 304/316 |
| Finish | Satın / mirror polished |
| For glass thickness | 6mm -13.52mm |

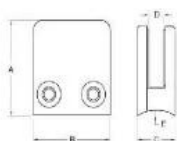

| Model No. | A | B | C | D | E |
|-----------|----|----|----|----|--------|
| G102 | 44 | 44 | 25 | 11 | 0 |
| G102R | 46 | 44 | 25 | 11 | R:21.5 |

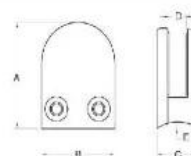

| Model No. | A | B | C | D | E |
|-----------|----|----|----|----|--------|
| G103 | 50 | 40 | 22 | 8 | 0 |
| G104 | 50 | 40 | 28 | 12 | 0 |
| G105 | 55 | 46 | 28 | 14 | 0 |
| G103R | 52 | 40 | 22 | 8 | R:21.5 |
| G104R | 52 | 40 | 28 | 12 | R:21.5 |
| G105R | 56 | 46 | 28 | 14 | R:25.4 |

4. Instrukcja montażu ze stali nierdzewnej

Glass Clamp Installation Guide



Mark and centre punch desired location of blind rivet nut location.



Drill centre punched hole in tube to suit blind rivet nut.

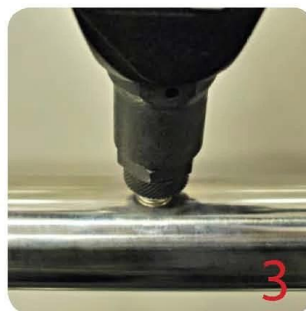

Insert blind rivet nut into tube and fasten with blind rivet tool.



Check installed blind rivet nut is secure and ready for install.



Align half glass clamp with blind rivet nut inline position. Screw in button head cap screw into thread and tighten with hex key.



Select appropriate rubber gasket to suit glass panel thickness. Install rubber gasket into both sides of glass clamp. (Note rubber gasket marked with sizes).



If heavier clamping load is required please use supplied glass clamp pin, during the install process. Note glass panels will require drilling in order to fit glass clamp pins.



Fit glass panel into position, install second half of glass clamp secure with provided hex screws.



Tighten glass clamps with hex key, and check glass panel are secure with no movement.





