

Cable Railing Hardware Wired Accessories Cable Tensioner T804

Product Description

Product Name	Cable railing hardware wired accessories cable tensioner T804
Material	Stainless steel 316 / stainless steel 304
Finish	Mirror polished / satin brushed
For cable diameter	4mm, 5mm,6mm cable/wire rope
Net weight	215g/set
Installation	Could install in steel post and timber Hydraulic crimper required to tighten cable
Payment Term	PayPal, West Union, T/T
Manufacture Method	CNC machining (high quality)
Packaging Details	1) One piece into one bubble bag 2) 15 sets into one cardboard carton Or packing as customers' requirements
Application	Staircase cable railing,balcony cable railing,deck cable railing,wire rope railing,cable railing system,cable railing hardware
Factory Inspection	Welcome
Sample	Available before order
MOQ	No limited. You can order as per your job requirement.
OEM & ODM Service	Available

Cable Tensioner T804 Details

1) Cable tensioner T804 photos

Cable tensioner T804 with screw fixing into timber



Cable tensioner T804 with bolt fixing into steel post.



2) Cable tensioner T804 dimension

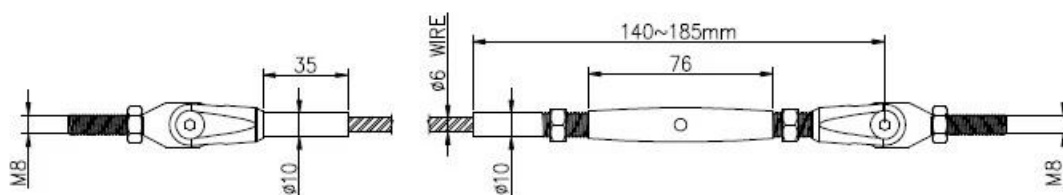

3) Cable tensioner T804 project for cable railing

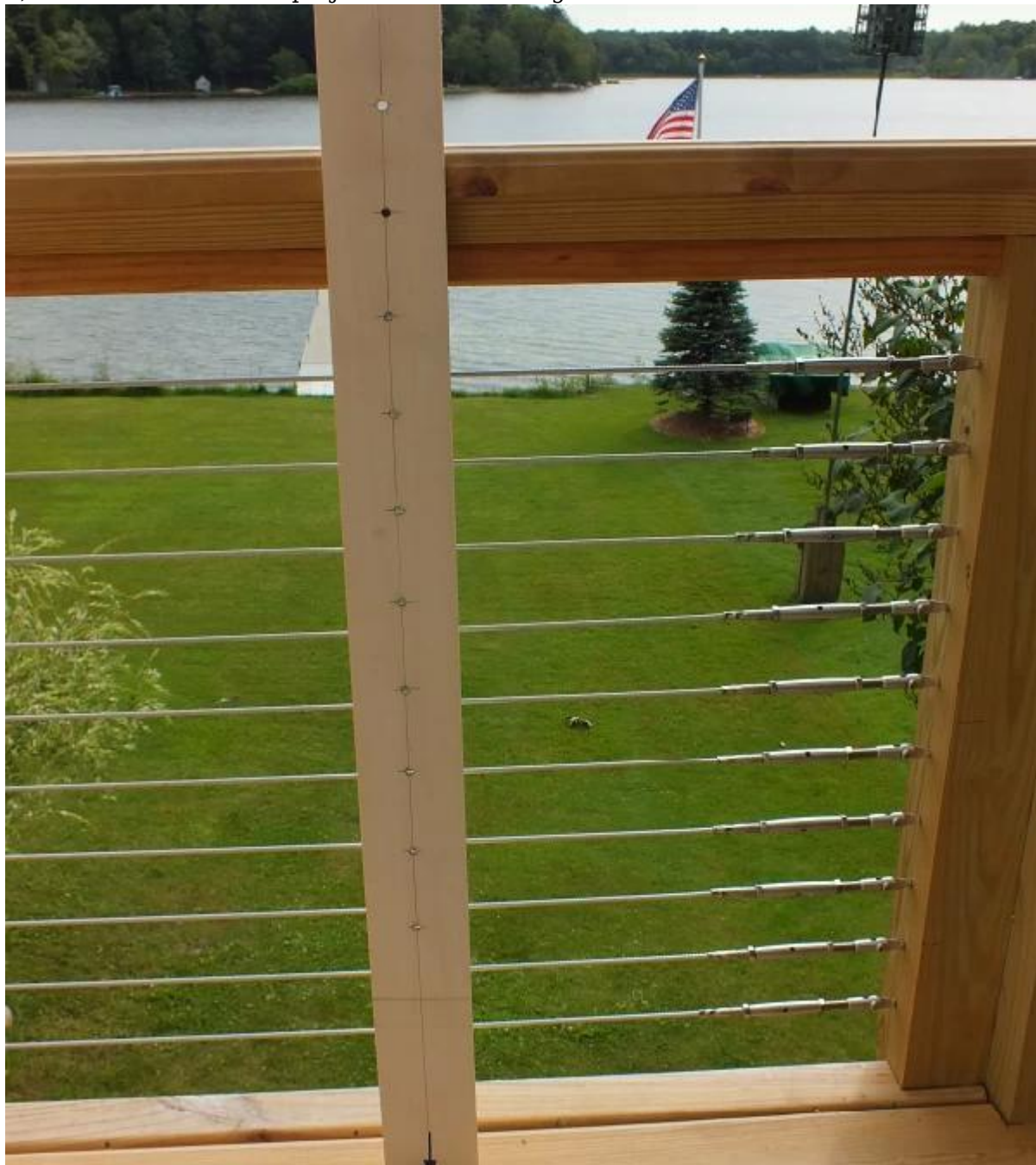





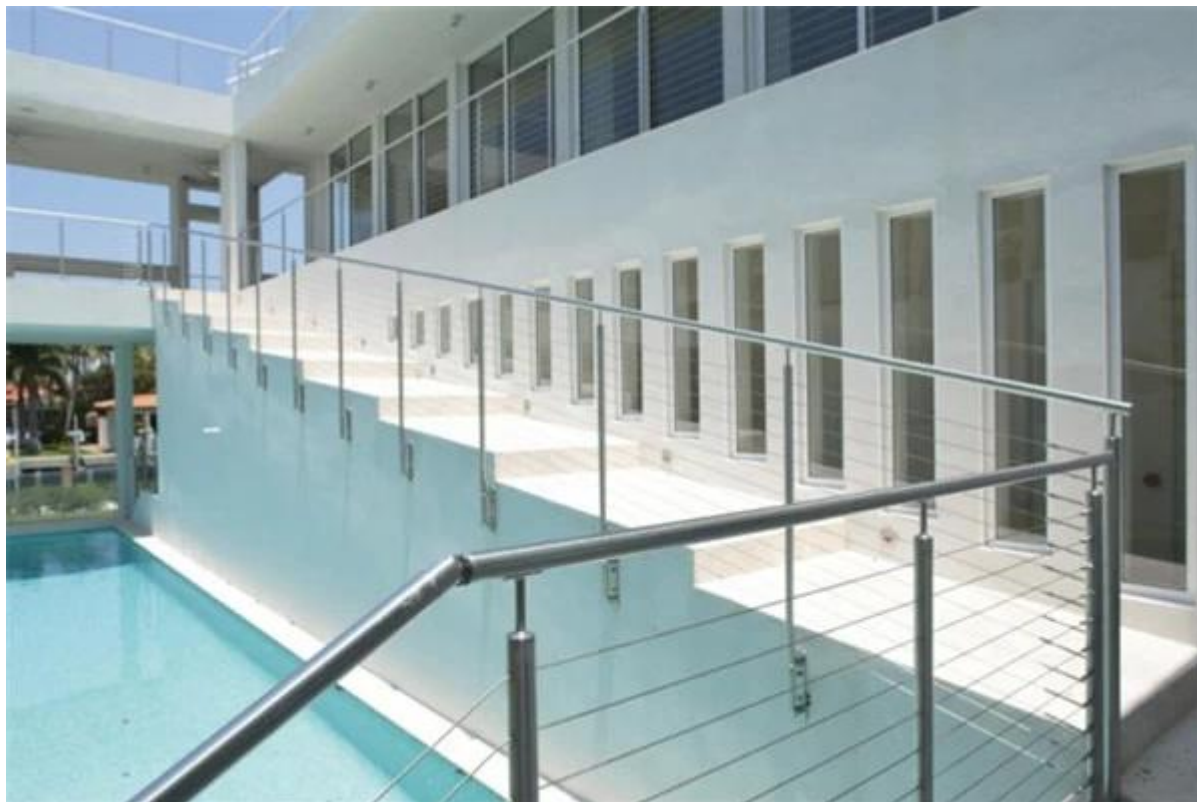

We also provide other produces for cable railing:

- 1) Cable railing balustrade post
- 2) Stainless steel wire rope
- 3) Different designs cable tensioner

Cable Tensioner T804 Safety Packaging

1. One piece into one bubble bag, 15 sets into one cardboard carton.
2. Packing as customers' requirements.

PACKAGING & DELIVERY



FAQ

1.Are you factory?

Yes, we are factory.

2.Do you offer free samples?

Yes, we offer free samples, but customers need to pay express charges.

3.What materials do you have?

We have the material of stainless steel 304, 316, 316L and Duplex 2205.

4.What is your MOQ?

MOQ of order required is 1 pc.

5.What kind of payment do you accept?

We accept the payment of T/T, LC, PayPal, West Union, etc.

6.What is your payment term?

Our payment term is T/T 100% or 30/70 or L/C at sight .

7.What is your delivery time?

Our delivery time is from 5 days to 30 days based on your quantity.

8.Do you offer OEM & ODM service?

Yes we offer OEM&ODM service.

9.Do you offer after-sales service?

Yes, we offer after-sales service. Any complaint for orders will be dealt with in time within 12 hours.

Contact

Any enquiries or questions, please leave a message. Will get back to you as soon as possible!

For any urgent enquiry, please get in touch below:

-Email: sales04@launch-china.cn

-Tel: (86-755) 8603 7559

-Skype: launch_04

-Mob/whats APP: +86-13530506265



董 萍 Doris Dong

Senior Sales Representative

☎ (86) 135 3050 6265

深圳市南山区南山大道1092号亿利达大厦B区3栋5003

Room 5003, Building 3, Yilida Building, No.1092
Nanshan Road, Nanshan District, Shenzhen, China
postal code 518054

☎ (86-755) 8603 7559

☎ (86-755) 8637 2611

✉ sales04@launch-china.cn

💻 www.launch-china.com

www.chinabalustrade.com