

Easy To Assemble Stainless Steel Metal Square Tube Connector Joints Connector Fittings



Description

- Made of stainless steel 304/316
- Finish: polished/brushed /gold/black/other required colors
- Dimension: 30*30*1.5mm, 40*40*1.5mm, 50*50*1.5mm, 40*20*1.5mm, 51*51*3.2mm, 25*25.1.2mm
- Customer size connectors available (Minimum order quantity: 10 pieces)

Real product photo in difference finish

- Tube connector in satin brushed



- Tube connector in mirror polished

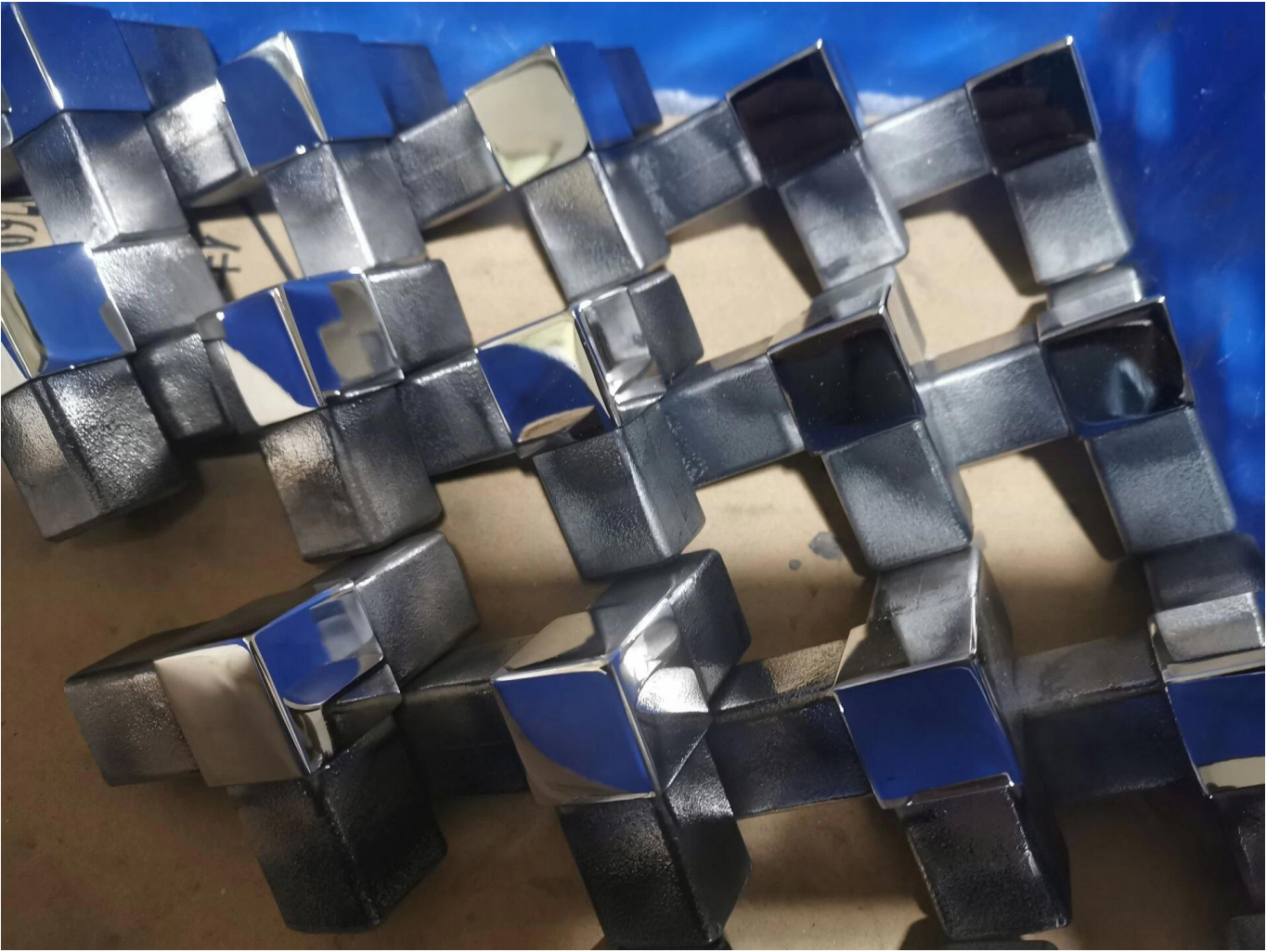

- Tube connector in black powder coating



- Tube connector in gold electroplated



Available Dimensions, custom welcome.

2-way tube connector



For tube dimensions Model
40×20×1.5(mm) S400
40×40×1.5(mm) S401
50×50×1.5(mm) S501
51×51×3.2(mm) S511
25×25×1.2(mm) S251
50×50×3.0(mm) S511A

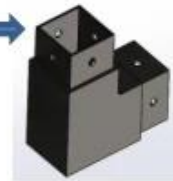

3-way tube connector



For tube dimensions Model
40×40×1.5(mm) S402
51×51×3.2(mm) S512
25×25×1.2(mm) S252
50×50×3.0(mm) S512A



3-way tube connector



For tube dimensions Model
30×30×1.5(mm) S303
40×40×1.5(mm) S403
50×50×2.0(mm) S503
51×51×3.2(mm) S513
25×25×1.2(mm) S253
50×50×3.0(mm) S513A



4-way tube connector



For tube dimensions Model
40×40×1.5(mm) S404
50×50×2.0(mm) S504
51×51×3.2(mm) S514
25×25×1.2(mm) S254
50×50×3.0(mm) S514A

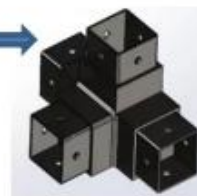

4-way tube connector



For tube dimensions	Model
40×40×1.5(mm)	S405
25×25×1.2(mm)	S255
51×51×3.2(mm)	S515

Round Type Stainless Steel Pipe Corner Connector / Pipe Elbow:

Stainless Steel Round Tube Connector



E301



E302



E303



E304



B502

--cross bar holder

Delivery & Packaging

--Delivery: 3-5 days by air. 10-15 days by sea

--Packing: one piece into one plastic bag, 3 pieces into one box.

--Regular lead time: 3-5 days if goods are in stock. 15-20 days if goods are not in stock. (It depends on quantity)



Contact now for more information:

Wendy: sales04@launch-china.cn

Mob/Whatsapp: +8615989339827