

1. Description

--Model No.: CB-80x35

--Glass to glass clamp

--Size: \varnothing 60mm

--For glass thickness: 10-12mm

2. Product picture



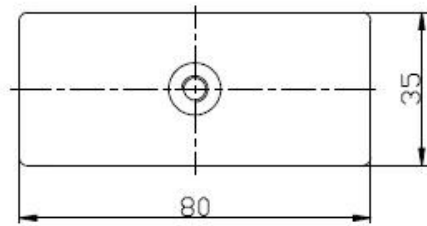
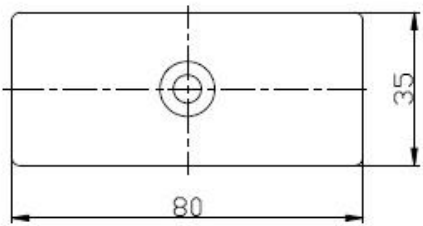
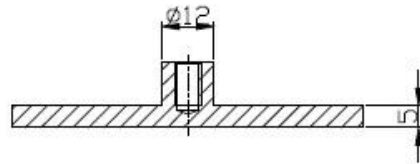
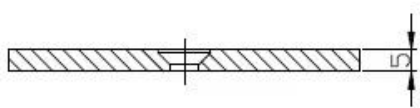



3. Project show











3.Delivery & Packing

Delivery: 3-5 days by express. 10-15 days by shipping

Packing: one pc into one plastic bag. 10 pcs into one box.

Lead time: about 20 days after payment. (It depent on quantity)



packing	plastic bag+box+carton
production lead time	30-45 days ; also depending on your qty.
Shippment	 
	 
	 
payment	 

5. Factory & Certification





6. Customers





**build &
renovating
expo**

Friday 4 July - Sunday 6 July 2014
Melbourne Exhibition Centre



7.Contact

KEBIL 科比奥®

深圳市朗驰商贸有限公司
SHENZHEN LAUNCH CO., LTD.

朗驰国际有限公司
LAUNCH INTERNATIONAL LIMITED.

董 萍 Doris Dong

Senior Sales Representative

☎ (86) 135 3050 6265

深圳市南山区南山大道1092号亿利达大厦B区3栋5003

Room 5003, Building 3, Yilida Building, No.1092
Nanshan Road, Nanshan District, Shenzhen, China
postal code 518054

☎ (86-755) 8603 7559

☎ (86-755) 8637 2611

✉ sales04@launch-china.cn

🌐 www.launch-china.com

www.chinabalustrade.com

Thank you for visiting. Please do not heasite to contact us for factory direct price and professional advises.