

Description

- Dimension: diameter 50mm, 1265mm high or as per your requirements.
- Aluminum post wall thickness: 3mm
- For glass thickness: 8-12mm
- 2 types aluminum post
 1. Fixing into concrete (1800mm high or as per your requirement)
 2. With base plates (1265mm high or as per your requirement)
- Application: pool fence, balcony semi-frameless aluminum railing, deck aluminum glass railing, garden fencing, aluminum railing system, aluminum balustrade
- For both commercial and modern house home design
- For both wholesale and retail (We are factory)
- Sample is always available
- Have passed strength test

4 types aluminum post



Round 1 way



**Round 2 way
180 degree**



**Round 2 way
135 degree**



**Round 2 way
90 degree**



Details

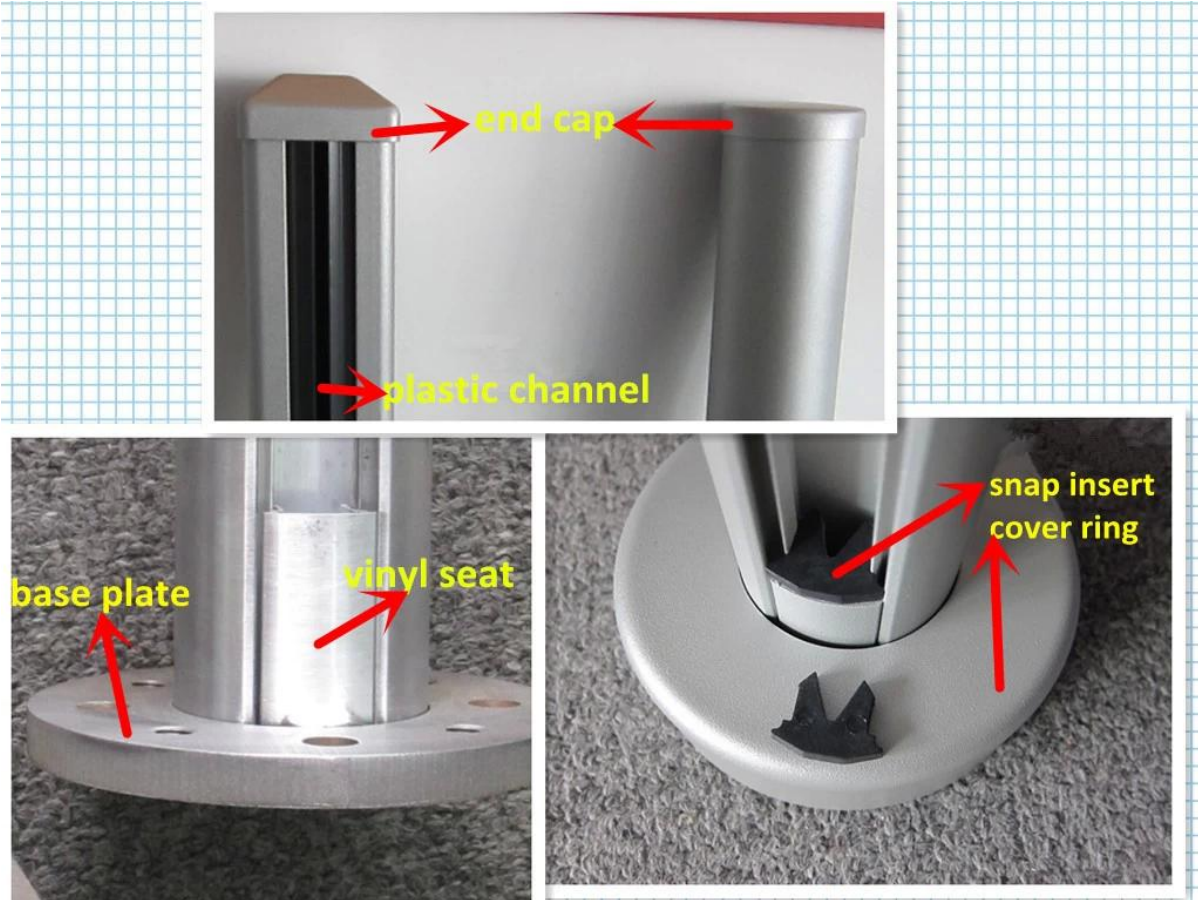



Side mounting bracket



Side mounting bracket

Finish



Project

Aluminum post for pool fencing (normally used with [hinge](#) and [latch](#))





Balcony and deck aluminum railing





Staircase aluminum railing



Factory & Certification













Packaging & Delivery

--one pc into one plastic bag, then into one box.

--3-5 days delivery by express. 10-15 days shipping by sea



packing	plastic bag+box+carton
production lead time	30-45 days ; also depending on your qty.
Shippment	 
	 
	 
payment	 

Customers



Why choose Launch--advantages

1. Various ranges of items for your selection
2. Provide professional services (3D & AUTOCAD)
3. Special designs by customer can be made
4. Competitive price with good discount
5. Superb quality control, production inspected one by one
6. Timely delivery, usually within a month
7. Good service before, during and after sales
8. OEM, ODM available

Thank you for visiting!

Need a quote or any questions, please leave a message, will get back to you ASAP!

Or contact me as below info.

KEBIL 科比奥®

深圳市朗驰商贸有限公司
SHENZHEN LAUNCH CO., LTD.

朗驰国际有限公司
LAUNCH INTERNATIONAL LIMITED.

董 萍 Doris Dong

Senior Sales Representative

☎ (86) 135 3050 6265

深圳市南山区南山大道1092号亿利达大厦B区3栋5003

Room 5003, Building 3, Yilida Building, No.1092
Nanshan Road, Nanshan District, Shenzhen, China
postal code 518054

☎ (86-755) 8603 7559

☎ (86-755) 8637 2611

✉ sales04@launch-china.cn

🌐 www.launch-china.com

www.chinabalustrade.com

For more beautiful aluminum railing pictures, go [here](#)