

Stainless Steel Short [Handrail Post for Glass Railing](#)

Product Description

Product Name	Stainless steel short handrail post for glass railing
Material	Stainless steel 304/316
Finish	Mirror polished or satin brushed
Drill glass hole size	Diameter 16mm hole required in glass
Height	400mm or customers' height
Handrail post size	50x50mm square handrail post, 1.5mm wall thickness.
Top Rail	No top rail required. End cap on top or as customer's requirements
Mounting	Surface mounting, floor mounting,fascia mounting
Minimum Order Quantity	one piece
Sample	Available to check quality and finish before order
Factory Inspection	Available
Sold as A Kit	Yes, ready to install. (Could be sold individually as well.)
Certified	Yes, meets and exceeds guard rail load requirements
OME & ODM Service	Available

Glass Railing Handrail Post Details

Short handrail post photos





Short handrail post dimension

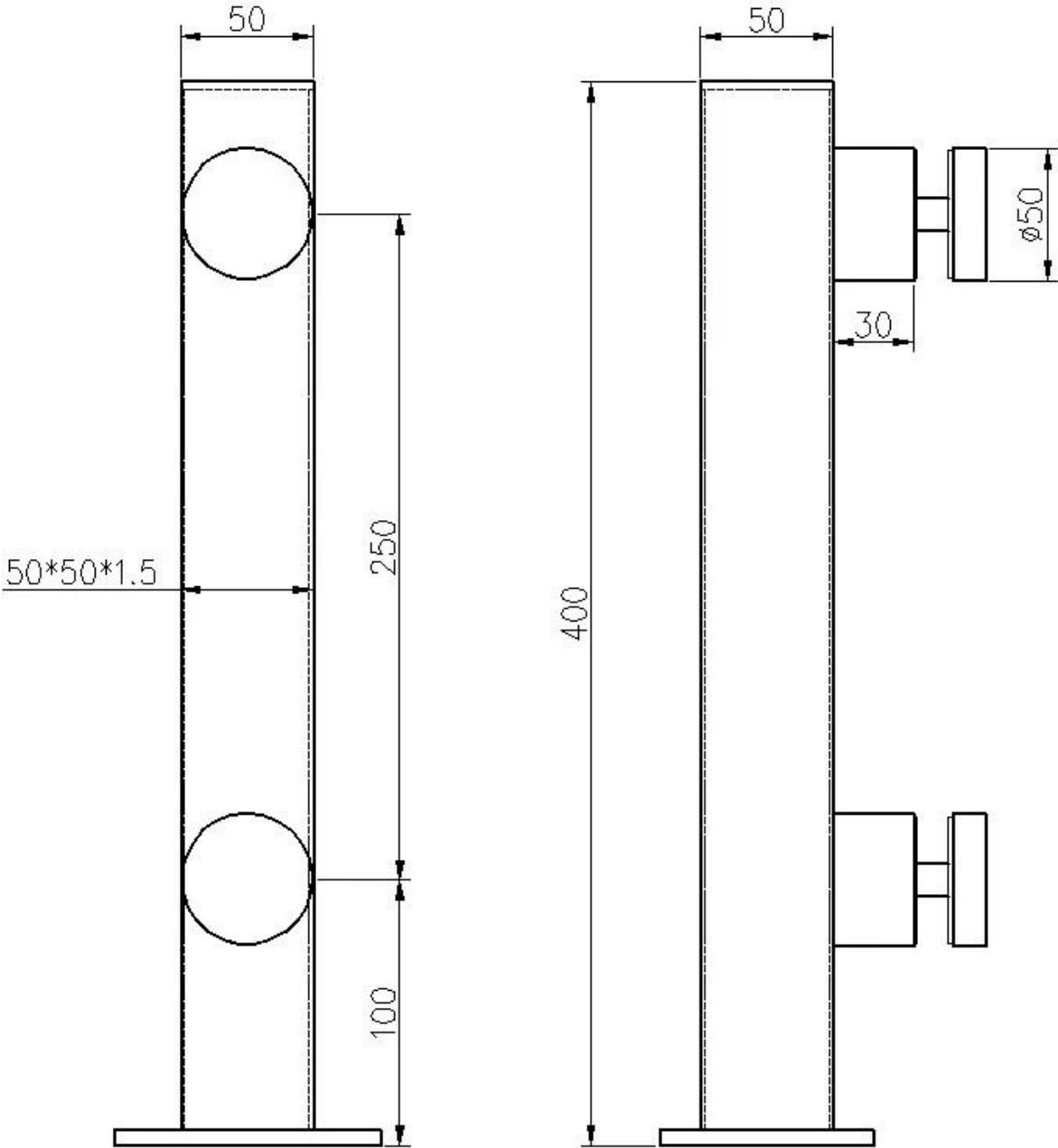

Regular height handrail post



LCH-120



Glass Railing Handrail Post Projects



Short handrail post you might be interested. Please click below picture for more information.



We are stainless steel glass railing factory with technical background, could design for customer's projects according to customer's idea and measurements. Technical drawing will be offered before producing.

Glass Railing Handrail Post Packaging

1. One piece into one bubble bag, then into one cardboard box, 10-12 pieces into one carton.
2. Or packing as customers' requirements.



FAQ

1.Are you factory?

Yes, we are factory.

2.Do you offer free samples?

Yes, we offer free samples, but customers need to pay express charges.

3.What materials do you have?

We have the material of stainless steel 304, 316, 316L and Duplex 2205.

4.What is your MOQ?

MOQ of order required is 1 pc.

5.What kind of payment do you accept?

We accept the payment of T/T, LC, PayPal, West Union, etc.

6.What is your payment term?

Our payment term is T/T 100% or 30/70 or L/C at sight .

7.What is your delivery time?

Our delivery time is from 5 days to 30 days based on your quantity.

8.Do you offer OEM & ODM service?

Yes we offer OEM&ODM service.

9.Do you offer after-sales service?

Yes, we offer after-sales service. Any complaint for orders will be dealt with in time within 12 hours.

Contact

Any enquiries or questions, please leave a message. Will get back to you as soon as possible!
For any urgent enquiry, please get in touch below:

-Email: sales04@launch-china.cn
-Tel: (86-755) 8603 7559
-Skype: launch_04
-Mob/whats APP: +86-13530506265



深圳市朗驰商贸有限公司
SHENZHEN LAUNCH CO., LTD.

朗驰国际有限公司
LAUNCH INTERNATIONAL LIMITED.

董 萍 Doris Dong

Senior Sales Representative

☎ (86) 135 3050 6265

深圳市南山区南山大道1092号亿利达大厦B区3栋5003

Room 5003, Building 3, Yilida Building, No.1092
Nanshan Road, Nanshan District, Shenzhen, China
postal code 518054

☎ (86-755) 8603 7559

☎ (86-755) 8637 2611

✉ sales04@launch-china.cn

💻 www.launch-china.com

www.chinabalustrade.com