

FRAMELESS GLASS BALUSTRADE SYSTEMS **KEBIL** is widely used on balcony, staircase deck frameless glass balustrade systems.

Specifications as below:

Model with mounting plate	SF-50T
Model without base plate	SF-50
Material	304/316 stainless steel
Finish	Brushed or polished
size for SF-50T	50mm dia , 100*200mm base plate
size for SF-50	50mm dia , M12*120 bolt
Apply	4 -6 pcs glass standoff for 1 pc glass panel
MOQ	10 PCS
SEA PORT	SHENZHEN
Payment terms	Paypal , TT

Photo for glass standoff bracket SF-50 , satin finish

KEBIL 科比奥®



Photo for glass standoff bracket SF-50 , mirror finish

KEBIL 科比奥®



glass standoff bracket SF-50 with wood screw

KEBIL 科比奥®



Dimensions for glass standoff bracket

Standoff with concrete base, A 50-55

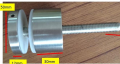

Standoff with wood screw, A 50-55

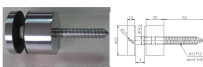

glass standoff bracket with mounting plate

KEBIL 科比奥®



Drawing for SF-50T

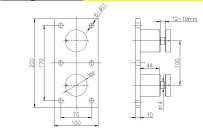

Glass standoff brackets installed on balcony staircase



Feel free to call tel. 86-755-86032558 or MOB 86-13590273543 to enquire price directly!

Contact : Celia

