

Frameless glass standoff railing for balcony

50mm diameter glass standoff bolts wall mount , uninterrupted views !

Glass standoff railing is composed of stainless steel glass standoff bolts , tempered glass panels ( 10-19mm thickness clear tempered glass or ultra clear tempered glass ) , top handrails optional .

Features of glass standoff bolts -

- Model no. SF-50
- Material : 304/316 stainless steel
- brushed or polished
- 50\*12mm cap , 50\*30mm body , M12\*120 bolt
- made by cnc machining
- solid standoff bolts
- weight 715g
- other diameters of standoff bolts also available 30mm , 38mm , 40mm etc.

photos of glass standoff bolts for balcony frameless glass railings -







**SF-50**



## **SF-50**

drawing of frameless glass standoff bolts-

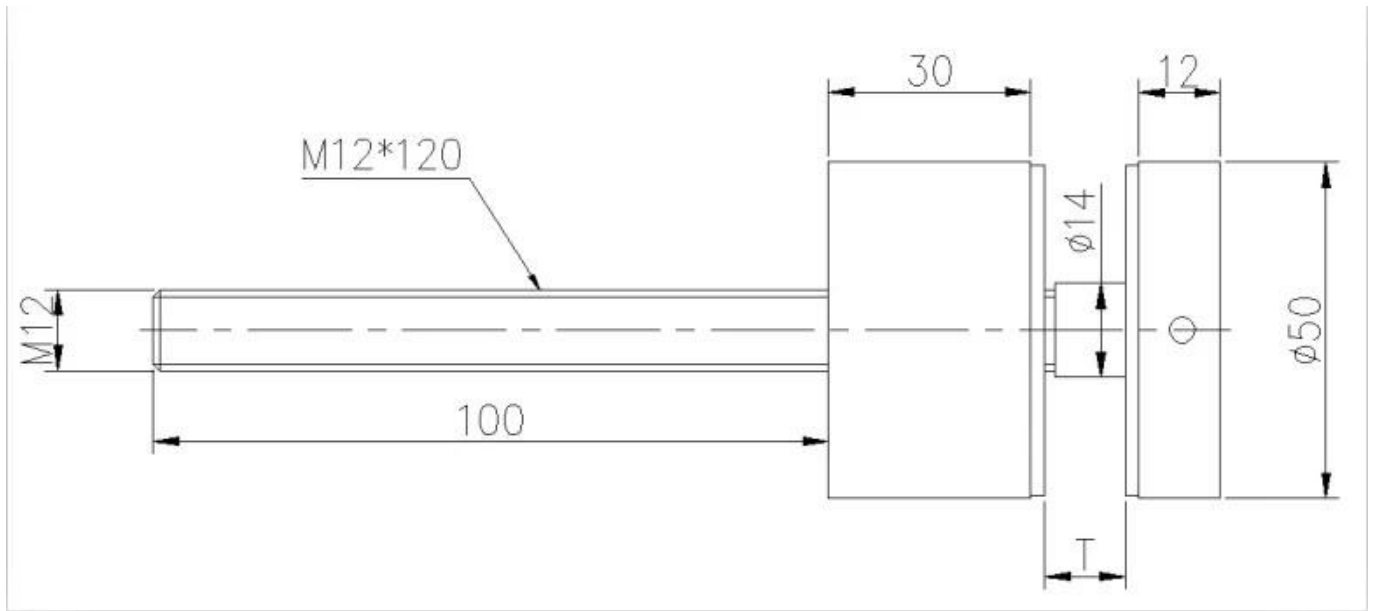

Packing photos of frameless glass standoff -



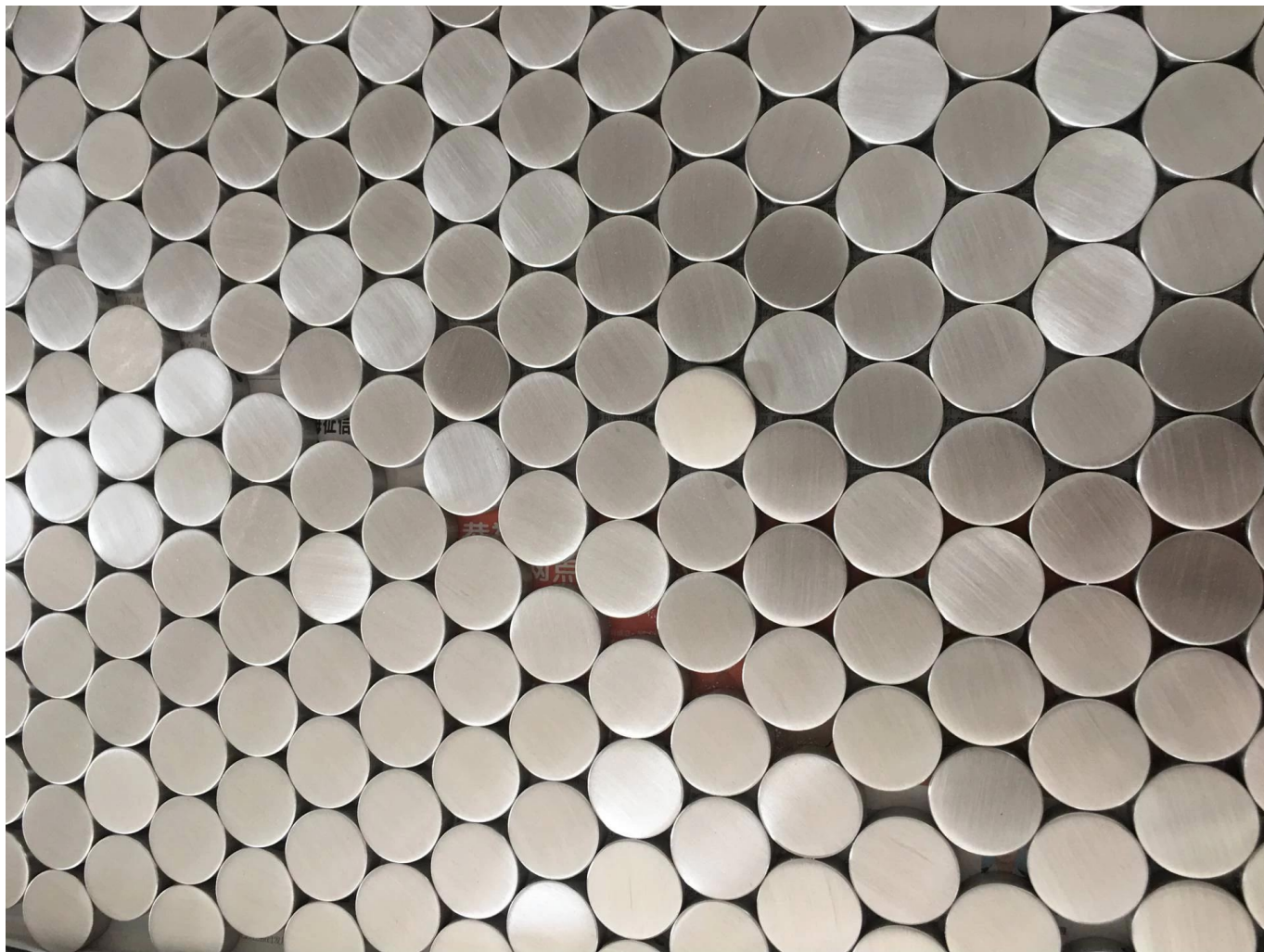





Project photos of frameless glass railings with our glass standoff bolts-







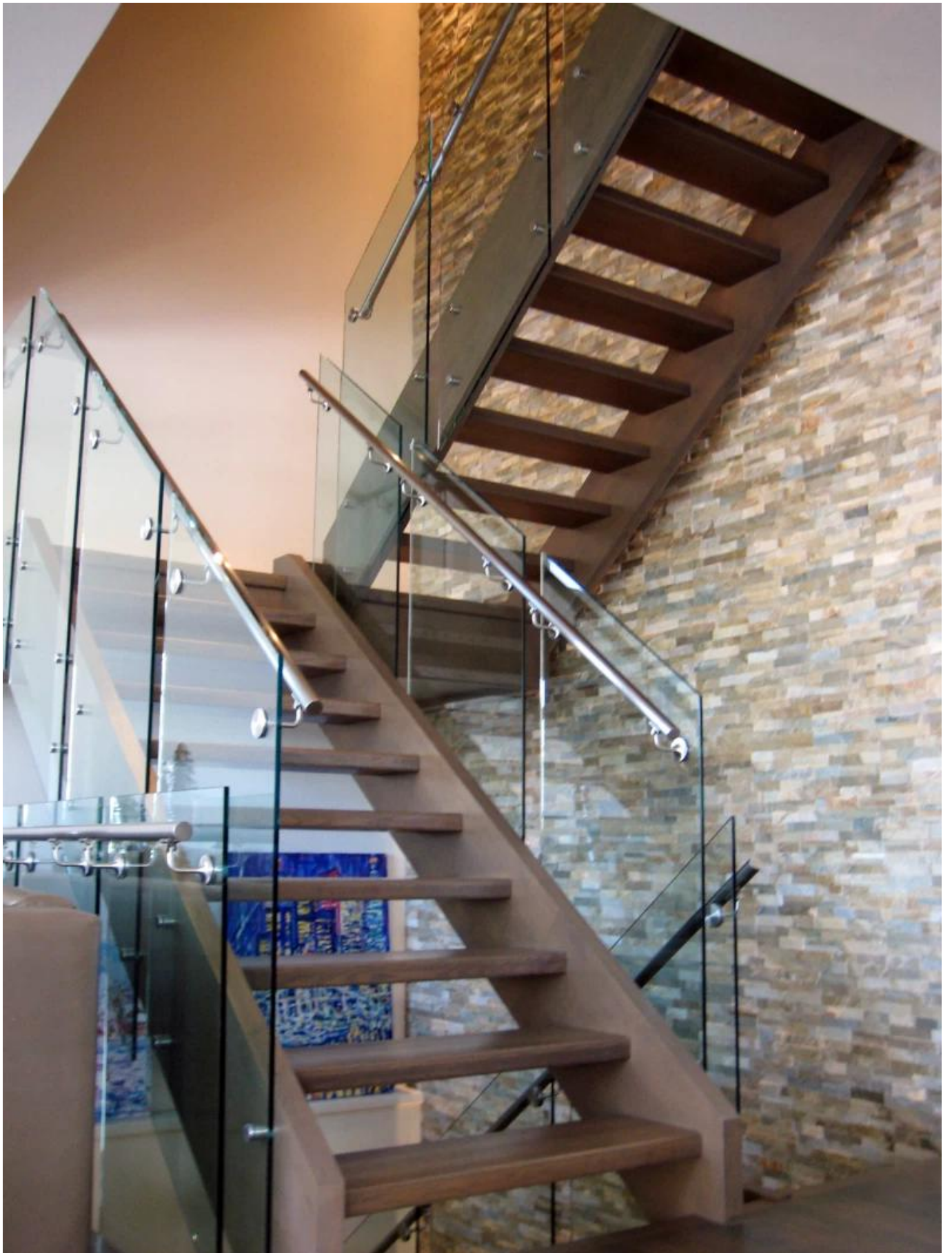





More about SHENZHEN LAUNCH CO. LTD-



# Company profile

Shenzhen Launch Co., Ltd was founded in the year 2004, with full experience in below production lines:

1. Construction materials including stainless steel railing materials , handrail fittings ,clamps, brackets, flanges , stainless steel tubing /sheet etc.
2. Professional OEM services such as laser cutting, precision casting (Stainless steel and Titanium), metal punch, cold rolling precision tube ( tolerance for inner and outer diameter can be controlled within plus/minus0.01mm), CNC machining, Al, Zinc alloy die casting, hardware welding, tube bending, water heater accessories, solar energy equipment accessories, auto parts, etc.

We have been supplying middle and high end construction materials / OEM fabrication parts to our main market in Europe , North America , Oceania , for more than 15 years . Recent years we have also been supplying our materials to Middle East , South America .



## Laser cutting workshop



## CNC machine workshop



## Sheet metal & bending machine workshop





# Stamping shop



160T 宽台面冲床 模具加工尺寸800\*1800mm



# Die making shop



## Sample Show room



## Project reference- Hot dip galvanizing parts for USA







## Welding handrails for Australia



SS Front panel project for building in Australia





## SS sheet panels



## Steel tubing for USA



# SS HANDRAIL FOR CANADA





**Office address:** B5-003, 5/F-Block 3, Yilida Building, No. 1092 Nanshan Road, Nanshan District, Shenzhen, China, postal code 518054

Tel: 86-755-86037559 Fax:86-755-86372611

**Factory address in Dongguan :** 1st floor, Building A, Ruixin Hengye No.3 industrial area, Taixing Road, Shigu Town, Tangxia district, Dongguan

**Contacts:**

Gao Binfeng –Managing director E. [admin@launch-china.cn](mailto:admin@launch-china.cn) PH. 86-755-86037559

Celia Chen – Sales manager E. [sales01@launch-china.cn](mailto:sales01@launch-china.cn) PH. 86-755-86037559 MOB .+8613590273543

Jacky Pei – Chief Engineer PH . 86-755-86037559

