

Shenzhen Launch

.

.
.
. 32 * 32 12 * 12 40 * 40 40 * 80
. DIY
.	1

. -

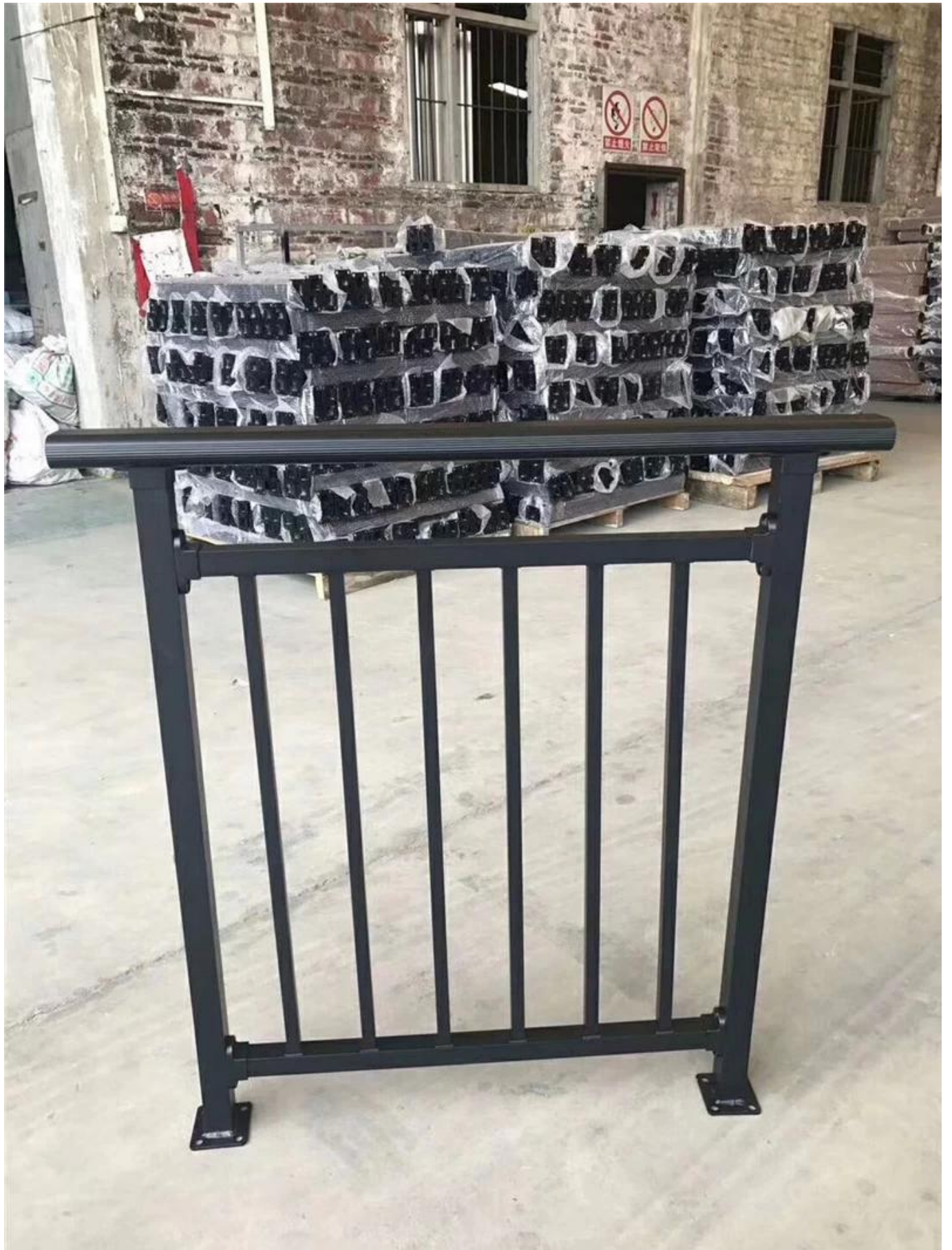





□□□□□□ □□□□□□ □□□□ □□ □□□□□□ □□□□□□□□ □□□□ □□□□ □□□□□□□□-

Guard Rail Assembly Instructions

Tools Required: Electrical Power Drill
(Impact Drill Preferred)

Overview: Assemble the rail and position it before marking holes for drilling. Improper installation can lead to failure of rail system or injury.

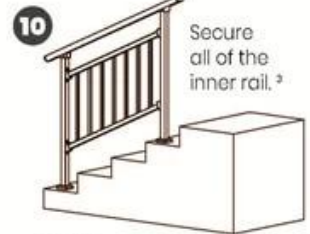
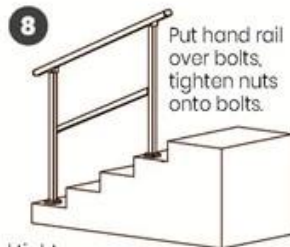
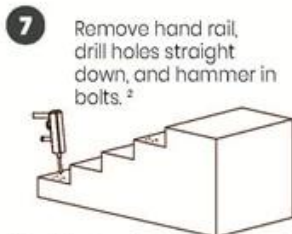
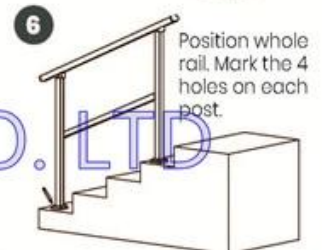
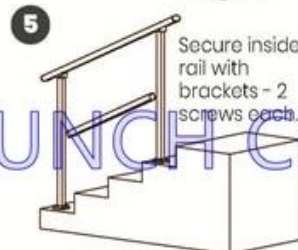
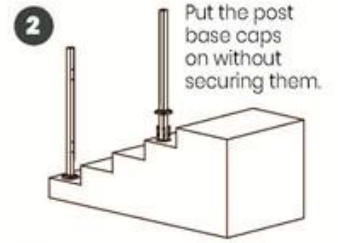
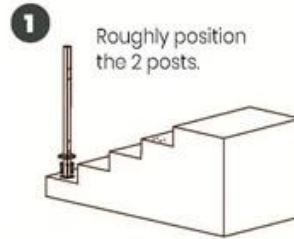
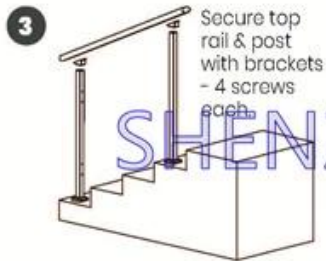

¹ Inside rail will be loose until each post is secured to the ground.

² Double check posts are parallel and tight against inside rail before marking holes for drilling.

³ Push and pull top rail & inside rail to ensure all is secure.

SHENZHEN LAUNCH CO. LTD





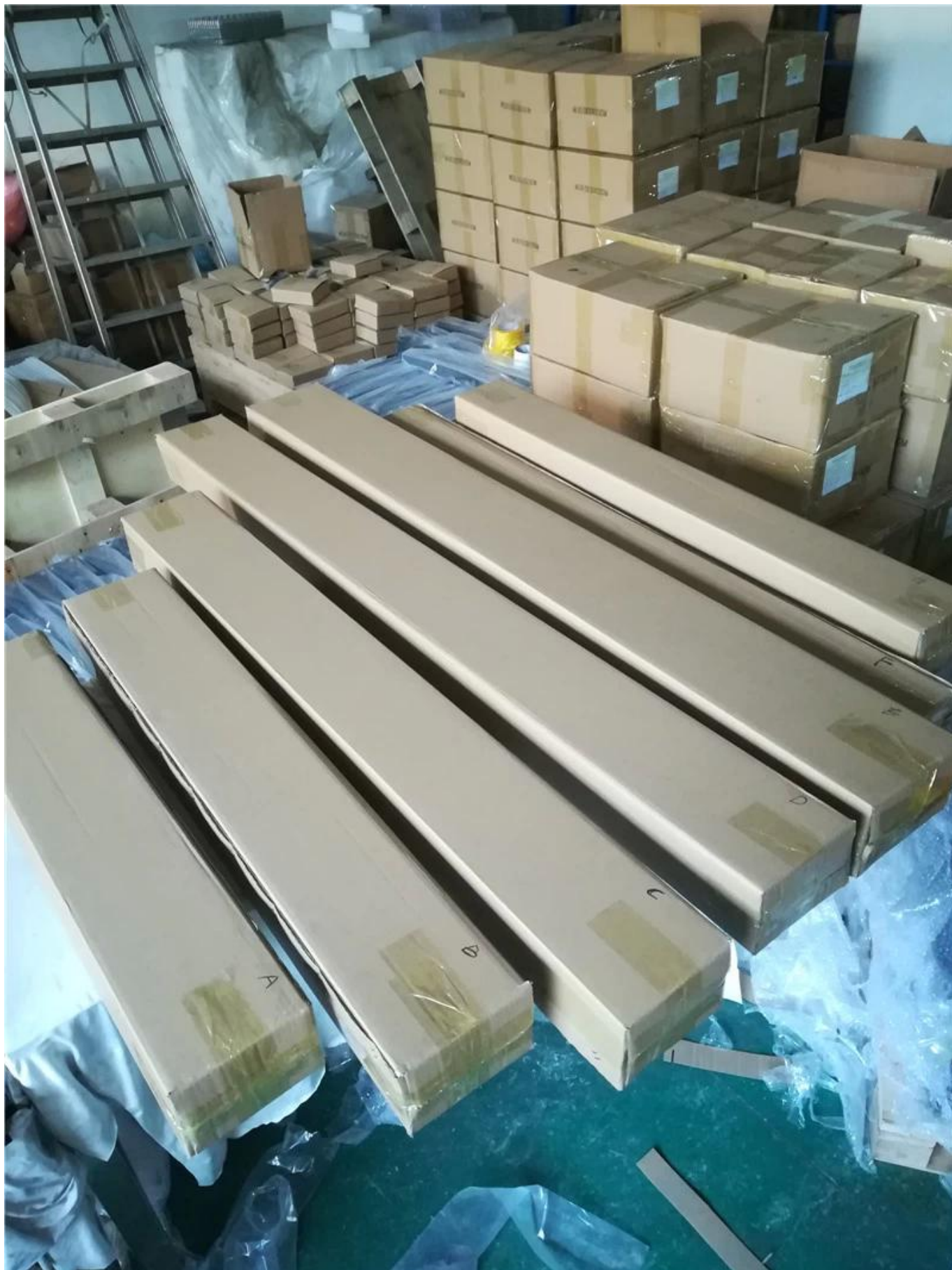





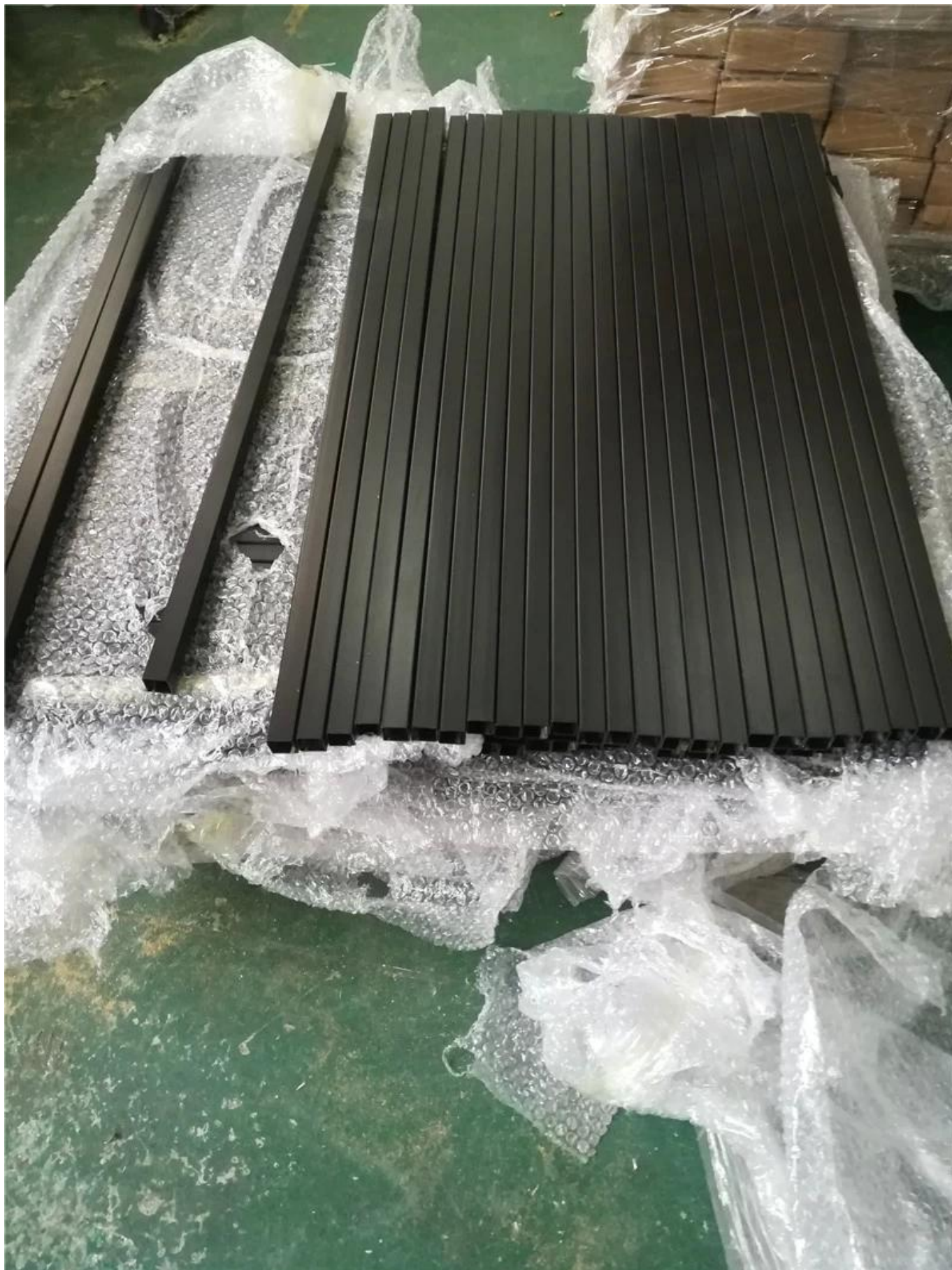

□□□□□□ □□□□ □□□□ -

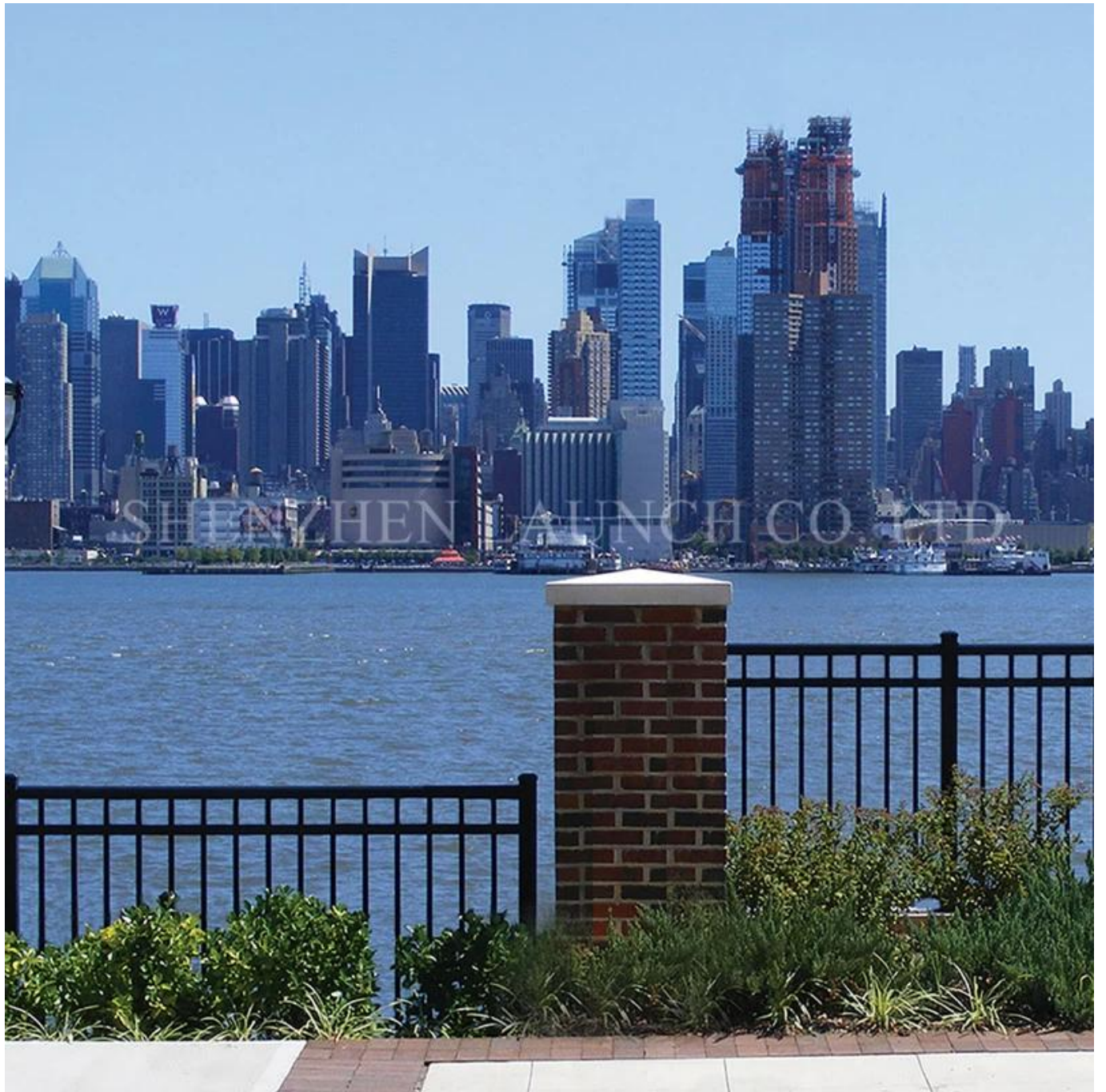



www.chinabalustrade.com

