

## Modern Exterior Handlauf Baluster Laminated Deck Balkon Glasgeländer Design



1	Material & Finish	Edelstahl 304/316; Satin oder Hochglanz
2	Höhe	1000MM / Benutzerdefinierte Größe
3	Pfostenpfosten	D50,8 * 1,5 (mm) Rohr; 4-fach verstellbare obere Schienenhalterung; Quadratische oder runde Glasklemme.
4	Obere Schiene	D50,8 * 1,5 (mm) Hohlrohr
5	Sicherheitsgeländer	10 mm / 12 mm gehärtete Klarglasscheibe
6	Verwendung & Ort	Baluster, Balustrade, Geländer, Zaun, Handlauf, Geländer; Balkon, Brücke, Terrasse, Garten, Terrasse, Pool, Veranda, Treppe, Terrasse
7	Installation	Oben / seitlich montiert
8	Paket	EPE + Innenverpackung + Karton



**LCH-106**

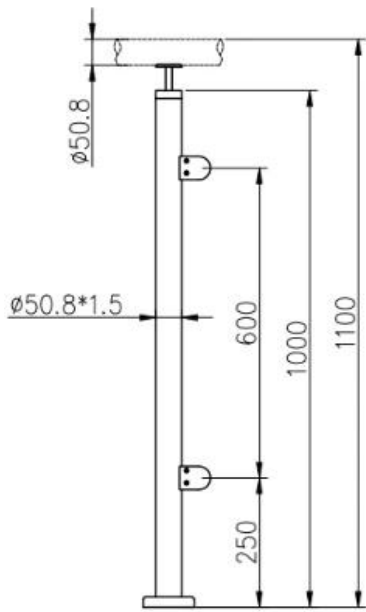

**LCH-107**

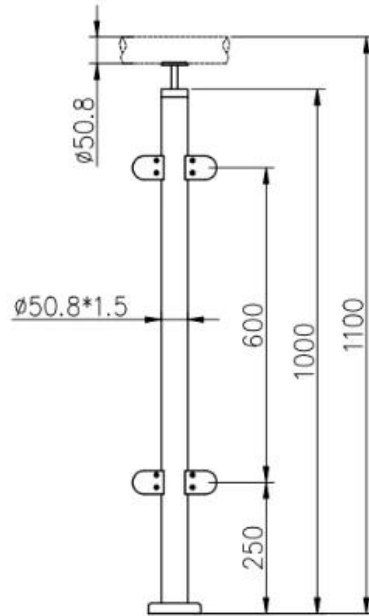

**LCH-108**

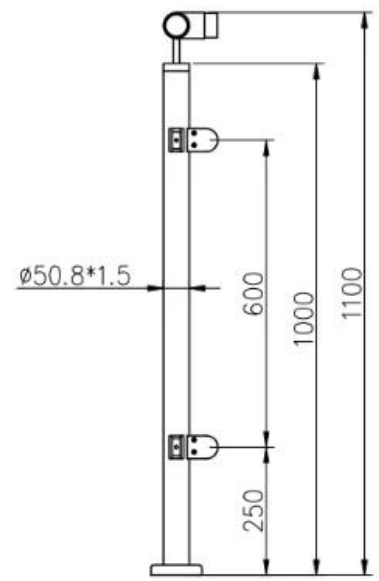

Installation:

## Glass Clamp Installation Guide

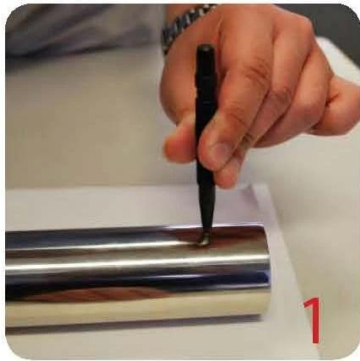

Mark and centre punch desired location of blind rivet nut location.



Drill centre punched hole in tube to suit blind rivet nut.

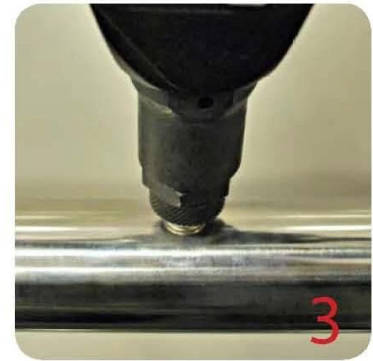

Insert blind rivet nut into tube and fasten with blind rivet tool.



Check installed blind rivet nut is secure and ready for install.



Align half glass clamp with blind rivet nut inline position. Screw in button head cap screw into thread and tighten with hex key.



Select appropriate rubber gasket to suit glass panel thickness. Install rubber gasket into both sides of glass clamp. (Note rubber gasket marked with sizes).



If heavier clamping load is required please use supplied glass clamp pin, during the install process. Note glass panels will require drilling in order to fit glass clamp pins.



Fit glass panel into position, install second half of glass clamp secure with provided hex screws.



Tighten glass clamps with hex key, and check glass panel are secure with no movement.

## Projektshow





Zum Balkon Geländer Designs:

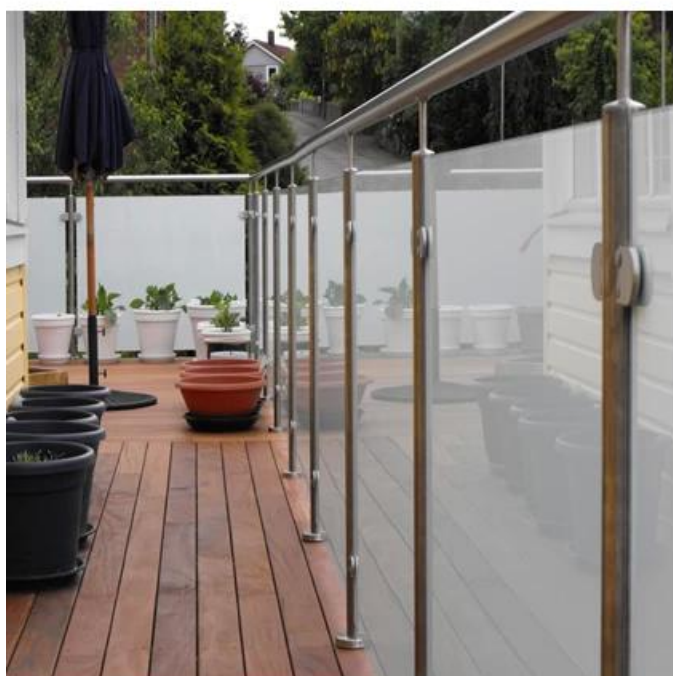
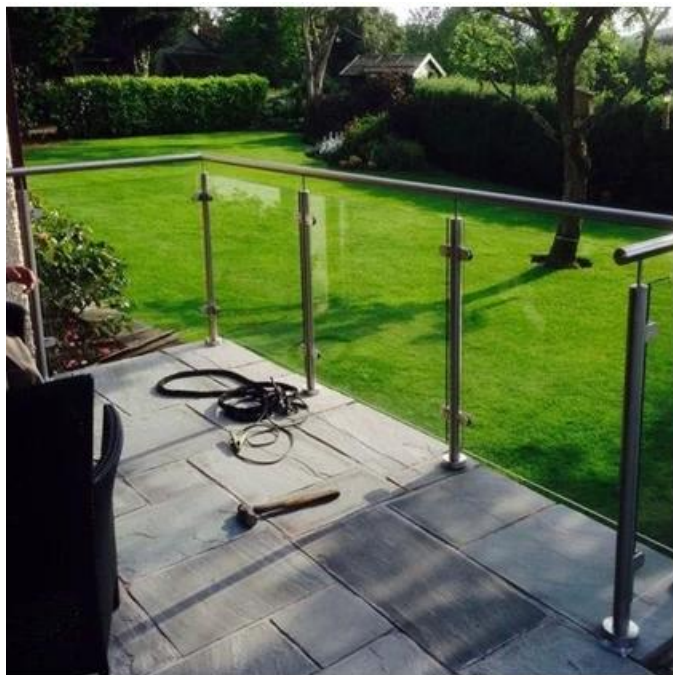

**Willkommen zu Kontakt uns:**

**Eve Chow**

**[sales03@launch-china.cn](mailto:sales03@launch-china.cn)**

**HP / WhatsApp / WeChat: +8613686807796**