

Shenzhen Launch kann federbelastete Glasscharniere für den Kot von Schwimmbädern herstellen, ein Paar Glasscharniere kann 30 kg Glastor tragen, Torwandstärke bevorzugt 8-12 mm. Hier werden einige Typen für Ihre Bewertung vorgestellt. Begrüßen Sie Ihre Anfragen.

### **Produkt Show**

Glas zu Glastyp

Modell Nr.:G-G

**KEBIL** 科比奥®



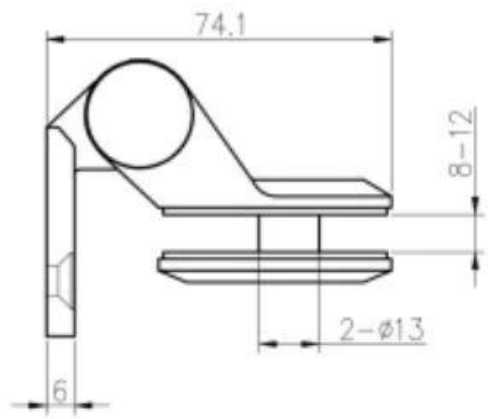
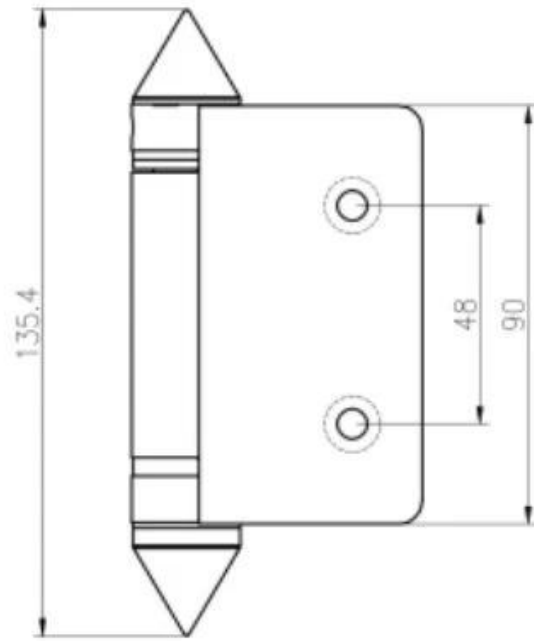
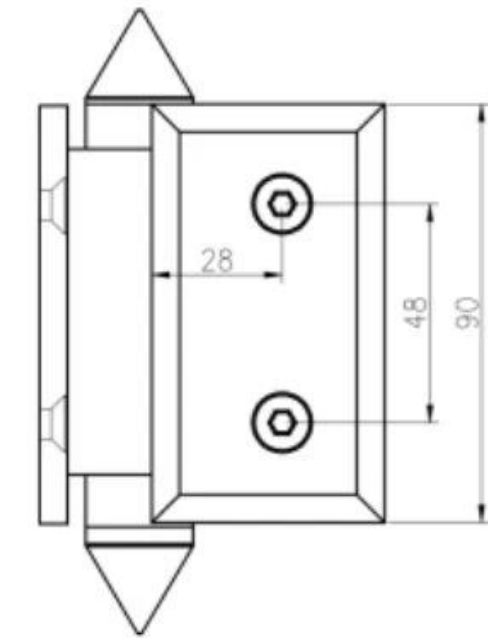

G-W

## Instructions for adjusting tension on Glass to Glass hinge

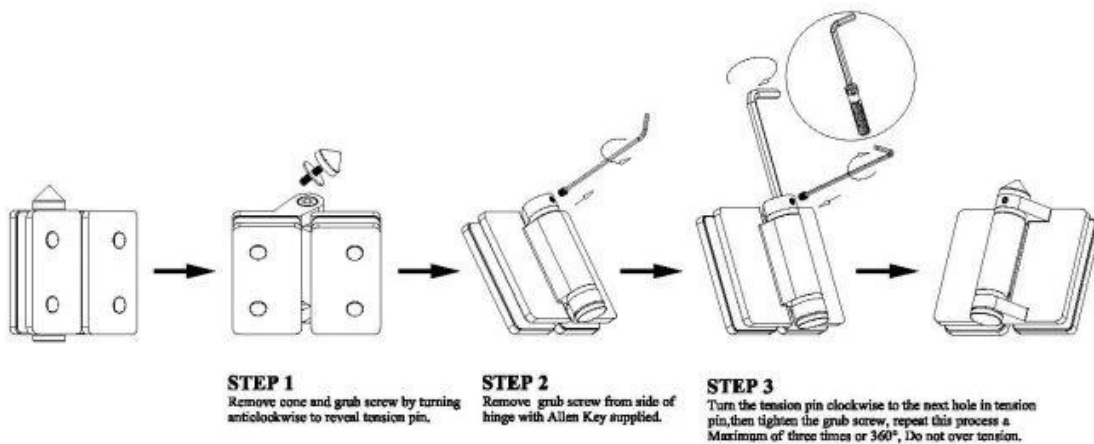

Glas zu Wand Typ

Modell Nr.:G-W

**KEBIL** 科比奥®



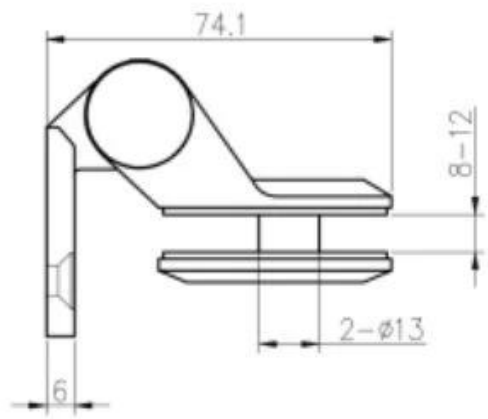
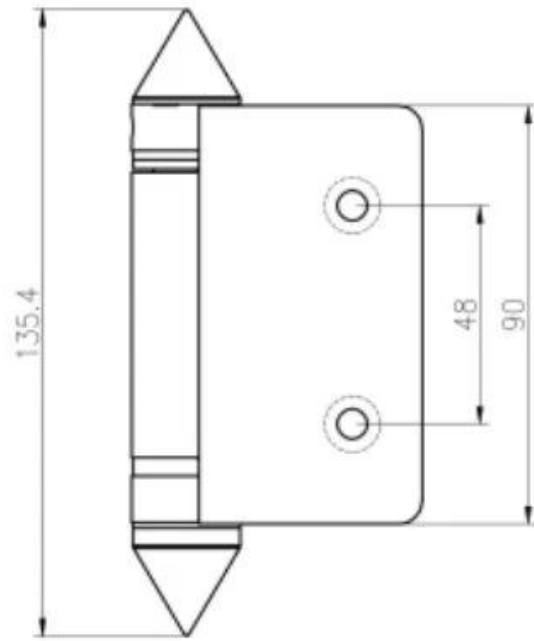
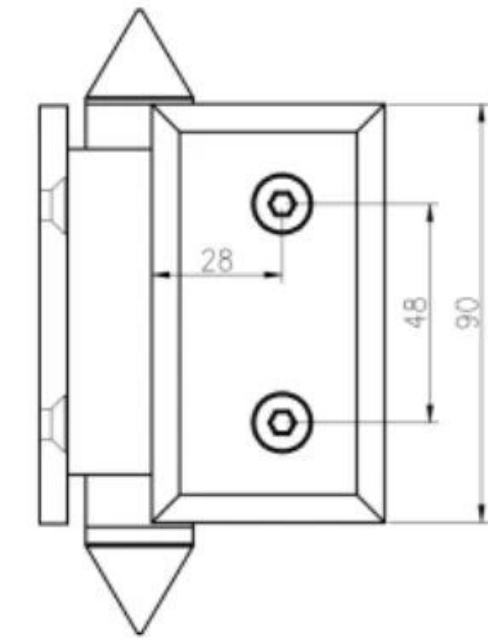

G-W

## Instructions for adjusting tension on Glass to Wall hinge

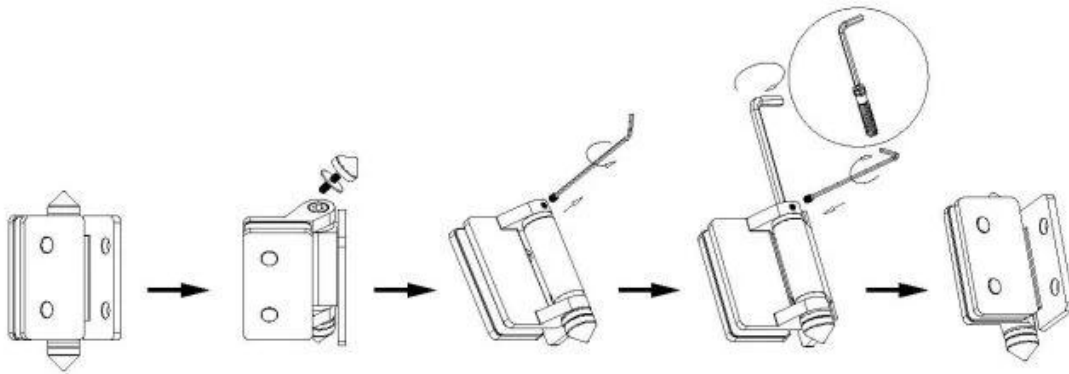

**STEP 1**  
Remove cone and grub screw by turning anticlockwise to reveal tension pin.

**STEP 2**  
Remove grub screw from side of hinge with Allen Key supplied.

**STEP 3**  
Turn the tension pin clockwise to the next hole in tension pin, then tighten the grub screw, repeat this process a Maximum of three times or 360°, Do not over tension.

Glas bis runder Typ

Modell Nr.:GR

**KEBIL** 科比奥®



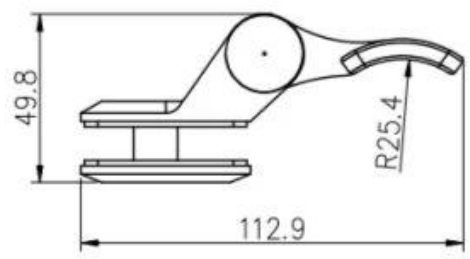
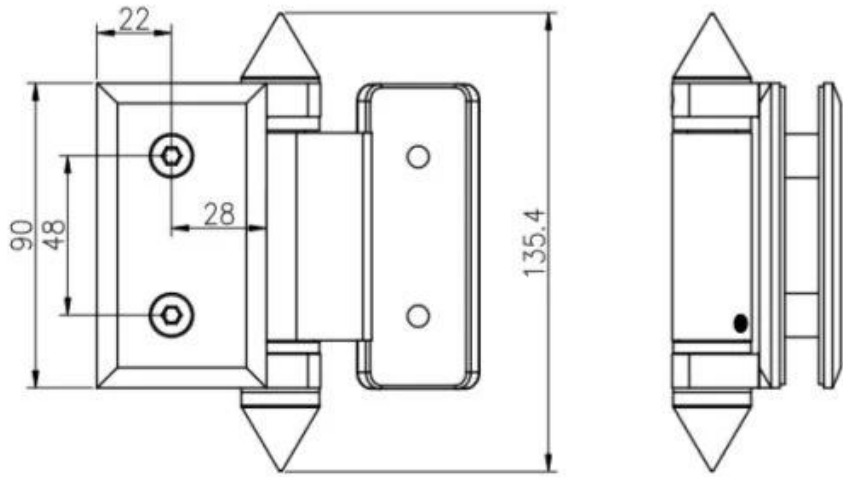

深圳市朗驰商贸有限公司 SHENZHEN LAUNCH CO., LTD.		表面处理	比例
设计	Jacky	材料	1:1.5
校对	图号:G-R	未注实体尺寸公差	
工艺		X	±0.1
审核		XX	±0.1
批准	版次	XXX	±0.1
	V001	X	±1°
		角度公差	XX
			±0.5°



### Instructions for adjusting tension on Glass to Round post hinge

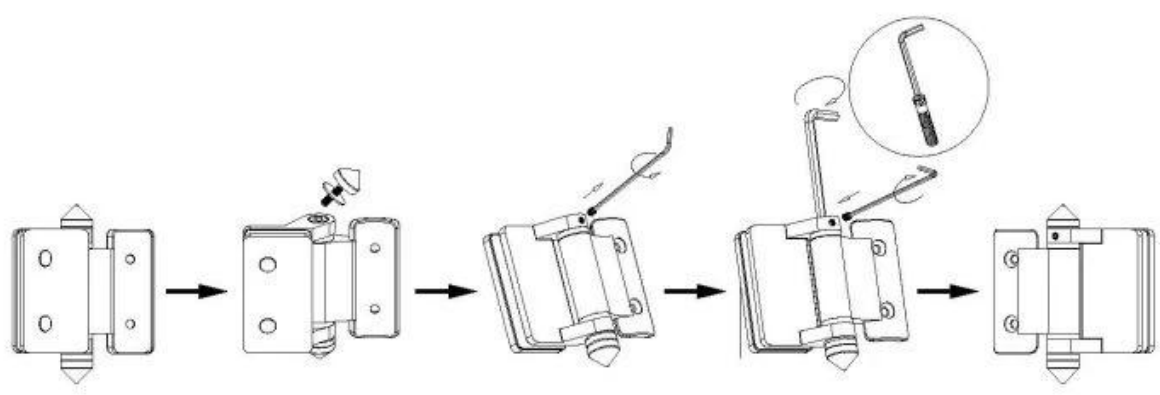

- STEP 1**  
Remove cone and grub screw by turning anticlockwise to reveal tension pin.
- STEP 2**  
Remove grub screw from side of hinge with Allen Key supplied.
- STEP 3**  
Turn the tension pin clockwise to the next hole in tension pin, then tighten the grub screw, repeat this process a Maximum of three times or 360°, Do not over tension.



## Massenproduktion





VerpackungBildgeber







**Anwendungsbildner**







Wenn Sie irgendwelche Interessen haben, können Sie mich gerne kontaktieren.

Frank Fang

Telefon / Wechat / WhatsApp: +8615906261741

E-Mail: [sales02@launch-china.cn](mailto:sales02@launch-china.cn)