

Moderno polvo recubierto de hierro forjado terraza balcón barandilla fábrica diseños

ProductoDescripción

Productoshow









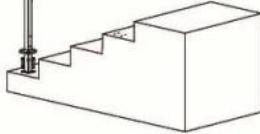
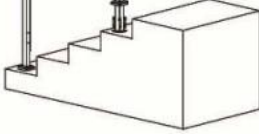

Instalación

Guard Rail Assembly Instructions

Tools Required: Electrical Power Drill
(Impact Drill Preferred)

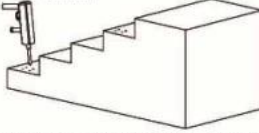
Overview: Assemble the rail and position it before marking holes for drilling. Improper installation can lead to failure of rail system or injury.

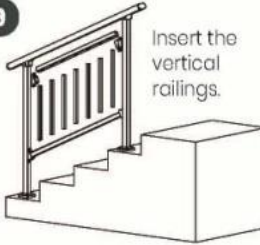
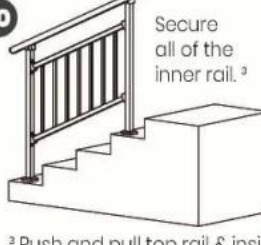
- 1** Roughly position the 2 posts.
- 2** Put the post base caps on without securing them.
- 3** Secure top rail & post with brackets - 4 screws each.
- 4** Add the ends to the top rail.
- 5** Secure inside rail with brackets - 2 screws each.¹
- 6** Position whole rail. Mark the 4 holes on each post.
- 7** Remove hand rail, drill holes straight down, and hammer in bolts.²
- 8** Put hand rail over bolts, tighten nuts onto bolts.
- 9** Insert the vertical railings.
- 10** Secure all of the inner rail.³

¹ Inside rail will be loose until each post is secured to the ground.

² Double check posts are parallel and tight against inside rail before marking holes for drilling.

³ Push and pull top rail & inside rail to ensure all is secure.

Producción y Embalaje



Solicitud

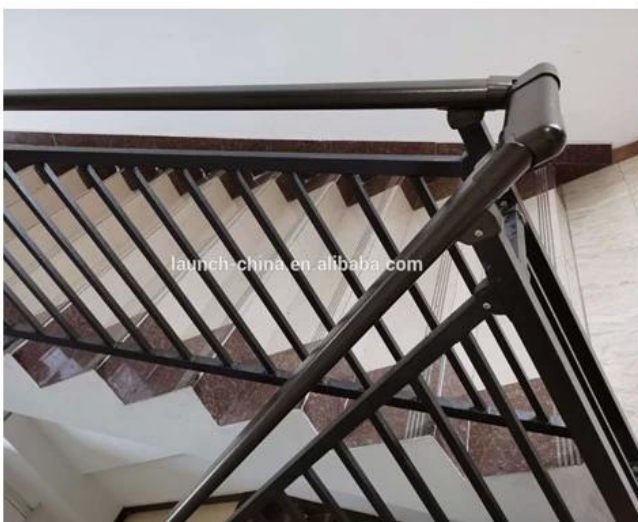
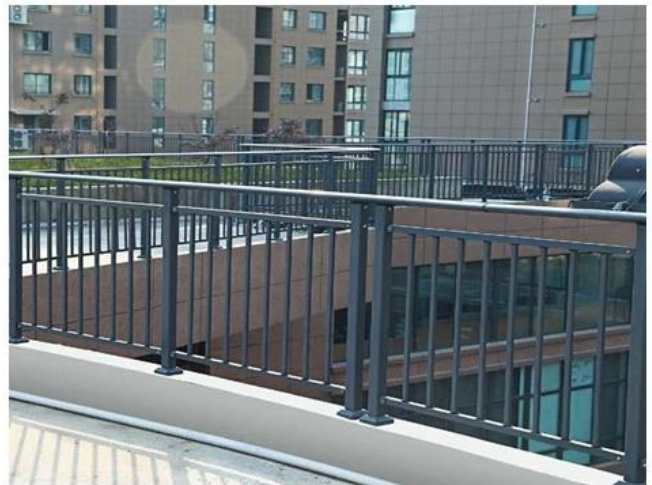
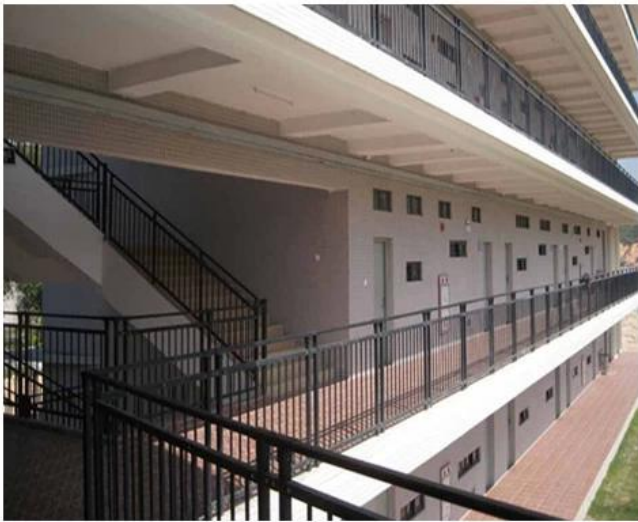

Contactos

¡Gracias por su visita!

Necesita cotización o cualquier pregunta, por favor deje un mensaje. Le responderemos dentro de las 24 horas.

Para cualquier pregunta urgente, póngase en contacto a continuación:

Wendy E-mail: sales04@launch-china.cn

MOB / What's App: +86 15989339827