

Shenzhen Launch valmistaa helposti asennettavan mustan jauhemaalatu mustan teräsarkkitehtuurisuunnittelun ulkovarteen. Tarjoamme asiakkaillemme täydelliset tarvikesarjat asennuksen helpottamiseksi.

Ulkovarteen kiskopakettin ominaisuudet-

Materiaali	Galvanisoitu teräs
Suurittaa loppuun	musta jauhemaalali
Koko	Yläkaide 80 * 40mm; 40 * 40 mm pylväs, 12 * 12 mm pystykiskot, 32 * 32 mm keskikisko
Kokoaminen	helppo DIY
MOQ	1 metri

Musta teräsarkkitehtuurisuunnittelu ulkovarteen kiskosarja-

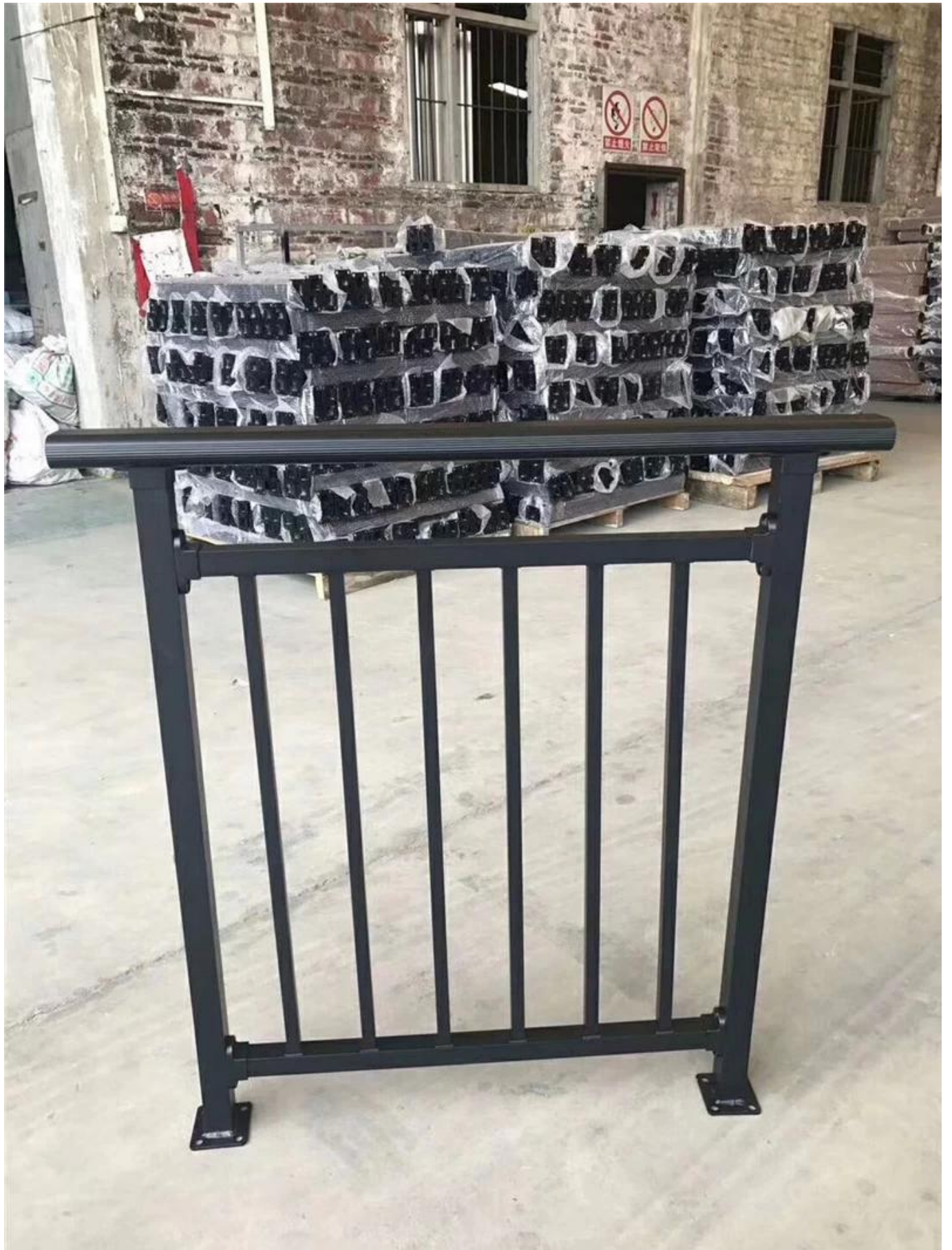





Suojakiskon asennusohjeet-

Guard Rail Assembly Instructions

Tools Required: Electrical Power Drill
(Impact Drill Preferred)

Overview: Assemble the rail and position it before marking holes for drilling. Improper installation can lead to failure of rail system or injury.

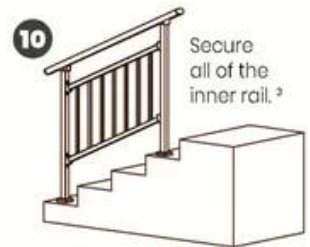
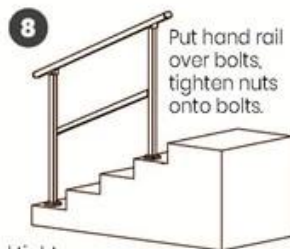
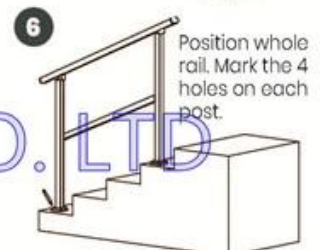
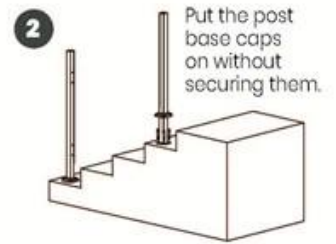
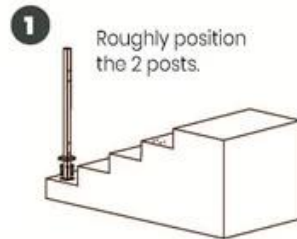

² Double check posts are parallel and tight against inside rail before marking holes for drilling.

¹ Inside rail will be loose until each post is secured to the ground.

³ Push and pull top rail & inside rail to ensure all is secure.

Tuotantovalokuvat galvanoitua terässuojakiskopakettia -





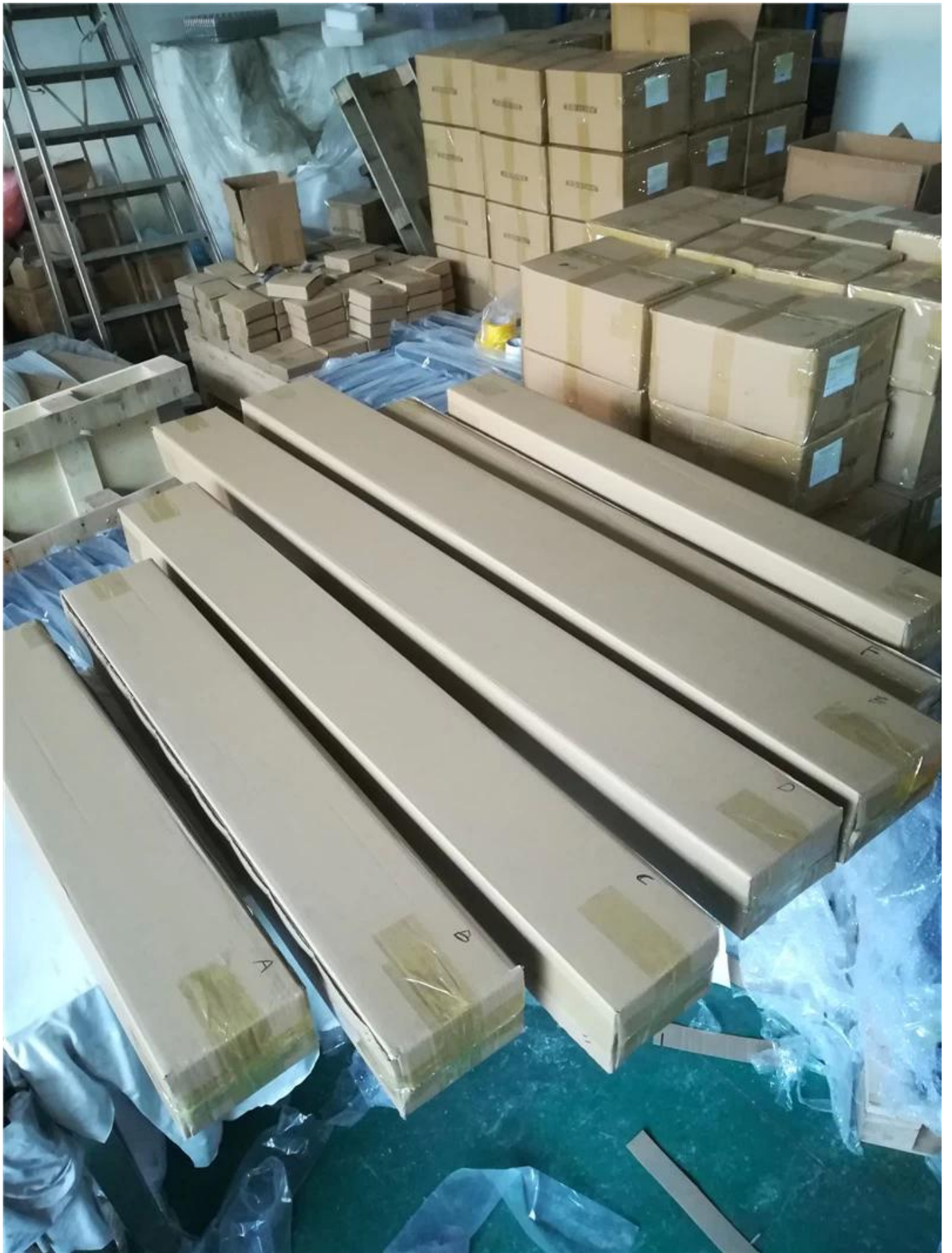





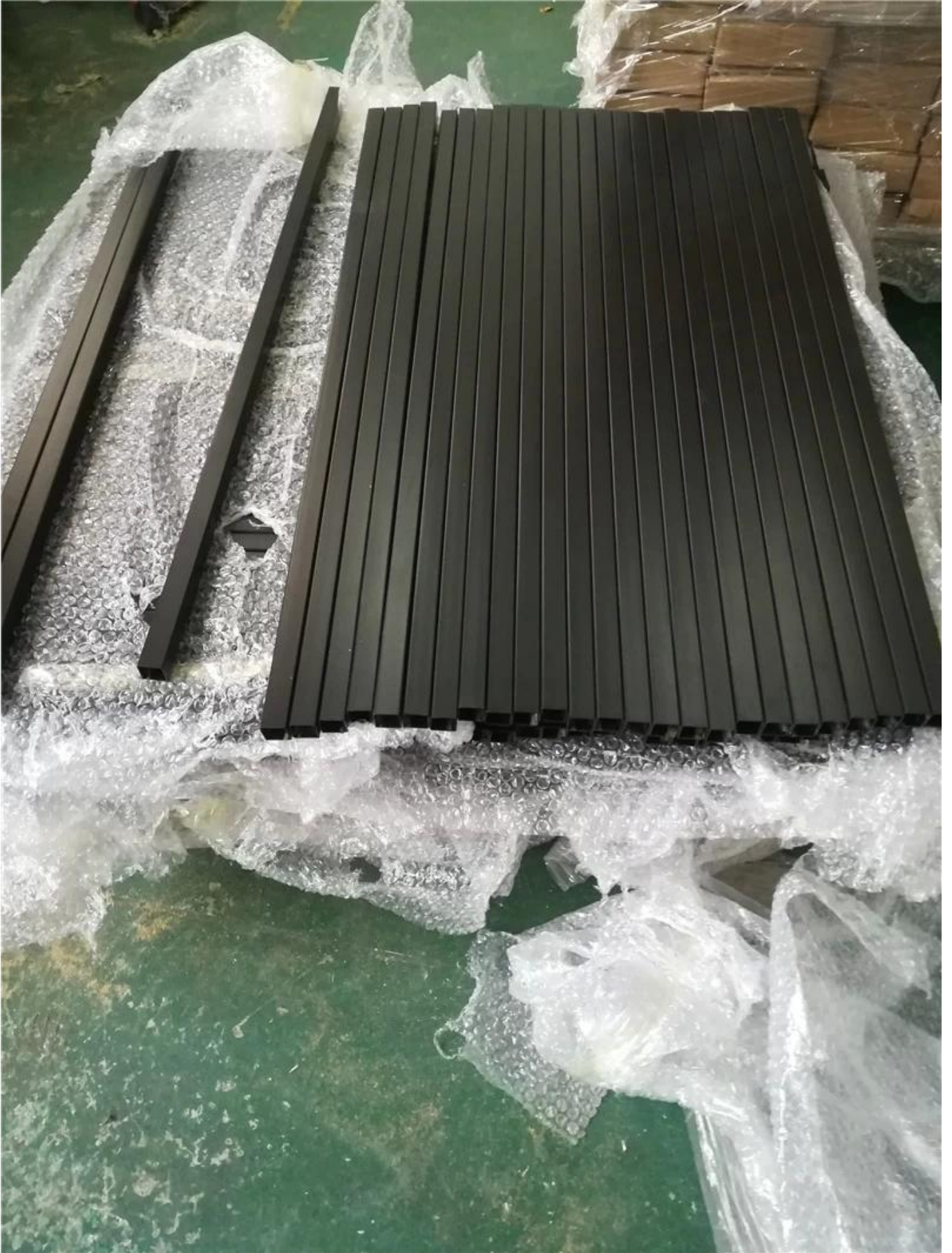

Guard Rail -galleriat -

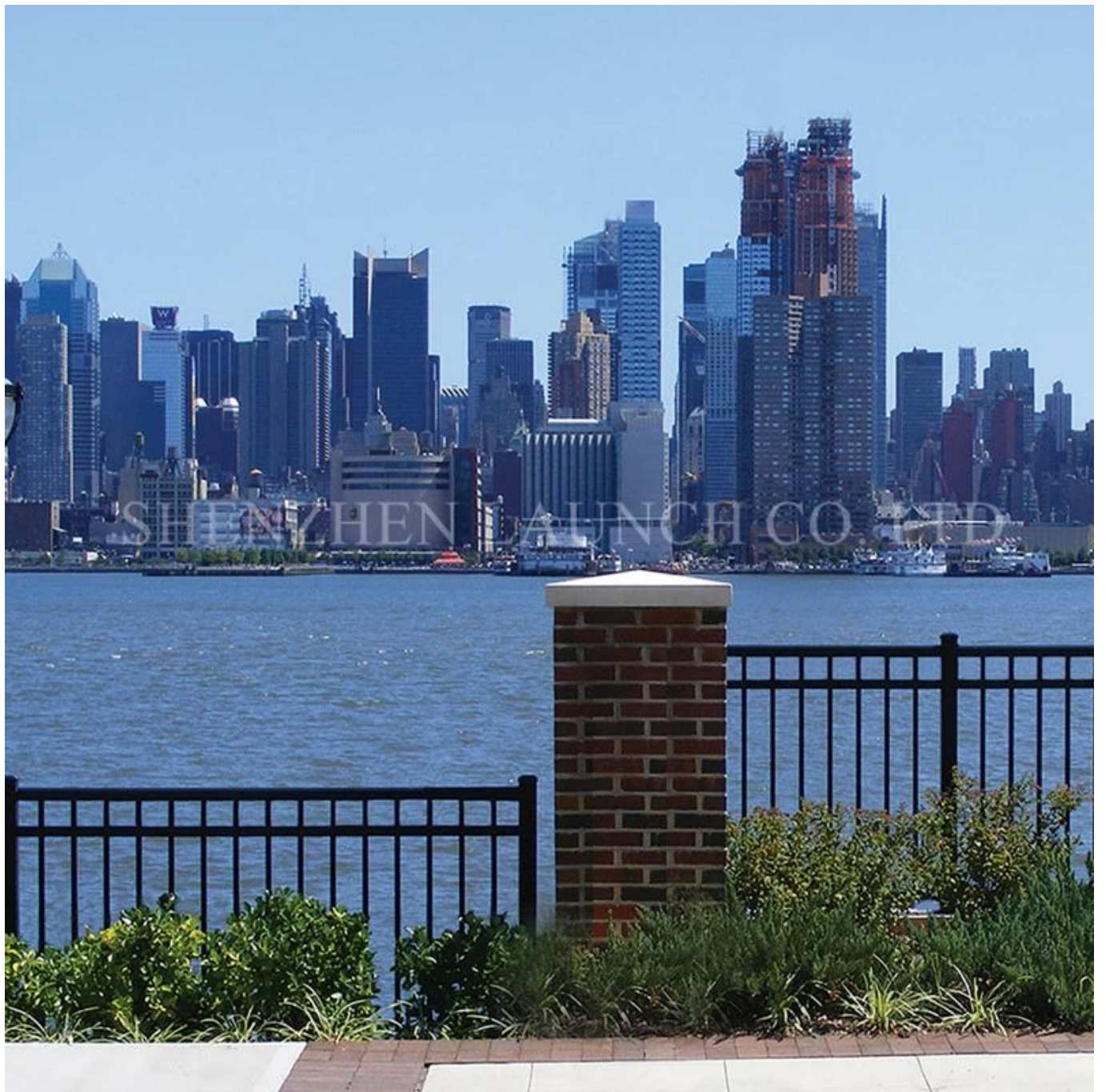



www.chinabalustrade.com

