

Moderni jauhe päällystetty takorauta terassi parveke kaide tehdas mallit

TuoteKuvaus

Tuotenäytä









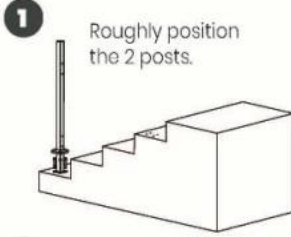
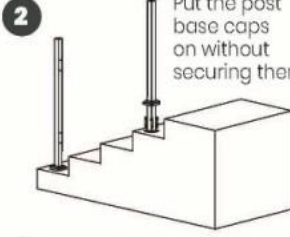

Asennus

Guard Rail Assembly Instructions

Tools Required: Electrical Power Drill
(Impact Drill Preferred)

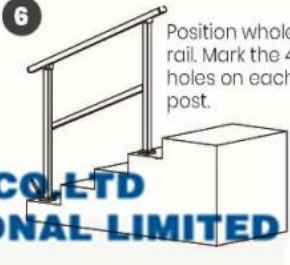
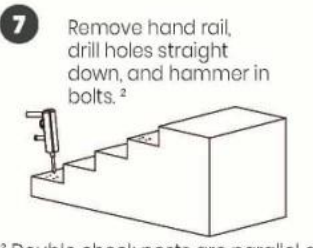
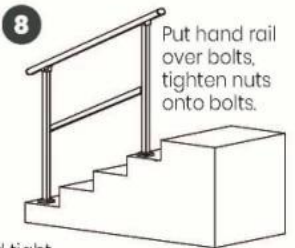
Overview: Assemble the rail and position it before marking holes for drilling. Improper installation can lead to failure of rail system or injury.

- 
- 1** Roughly position the 2 posts.
- 
- 2** Put the post base caps on without securing them.
- 
- 3** Secure top rail & post with brackets - 4 screws each.
- 
- 4** Add the ends to the top rail.
- 
- 5** Secure inside rail with brackets - 2 screws each.¹
- 
- 6** Position whole rail. Mark the 4 holes on each post.
- 
- 7** Remove hand rail, drill holes straight down, and hammer in bolts.²
- 
- 8** Put hand rail over bolts, tighten nuts onto bolts.
- 
- 9** Insert the vertical railings.
- 
- 10** Secure all of the inner rail.³
- ¹ Inside rail will be loose until each post is secured to the ground.
- ² Double check posts are parallel and tight against inside rail before marking holes for drilling.
- ³ Push and pull top rail & inside rail to ensure all is secure.

KEBIL 科比奥 **SHENZHEN LAUNCH CO. LTD**
LAUNCH INTERNATIONAL LIMITED

TuotantojaPakkaus



KEBIL 科比奥 SHENZHEN LAUNCH CO., LTD
LAUNCH INTERNATIONAL LIMITED



KEBIL 科比奥 SHENZHEN LAUNCH CO., LTD
LAUNCH INTERNATIONAL LIMITED



Sovellus

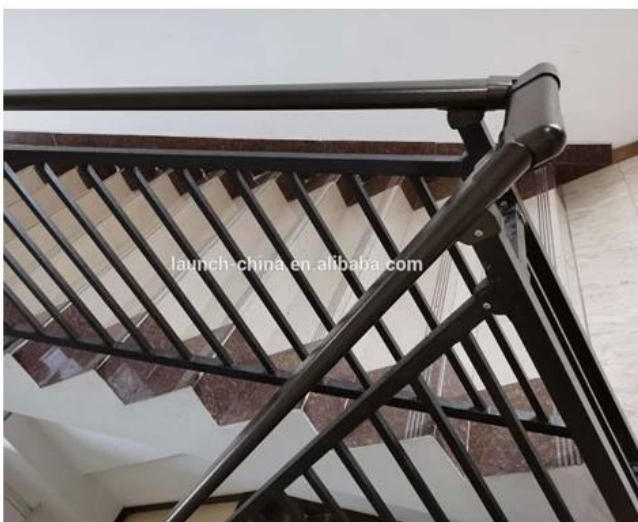
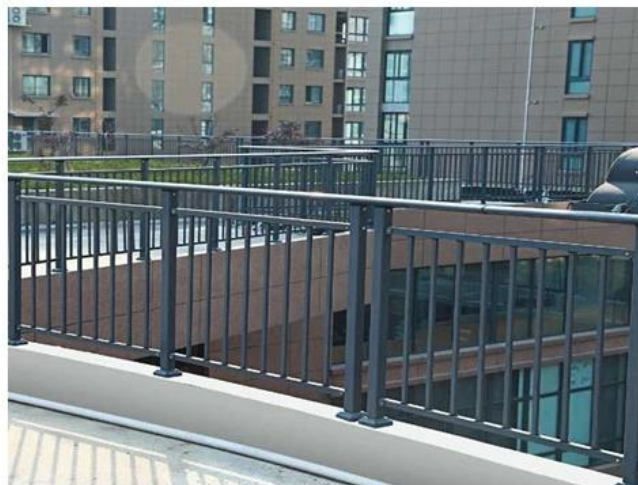
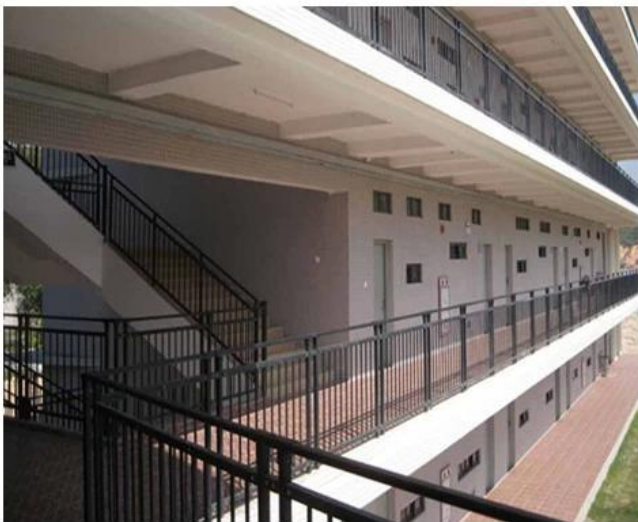

Yhteystiedot

Kiitos vierailusta!

Tarvitsetko tarjouksen tai kysymyksiä, jätä viesti. Tulemme takaisin sinulle 24 tunnin kuluessa.

Kaikki kiireelliset tiedustelut, ota yhteyttä alla:

Wendy Sähköposti: sales04@launch-china.cn

MOB / Mikä sovellus: +86 15989339827