

Type de verre de verre carré de type D 316 miroir en acier inoxydable poli
(modèle G102)

1. Informations détaillées pour G102

- MOQ 100 pcs
- Pour verre de 8-10mm
- 304/316 en acier inoxydable, brillant ou satiné
- Dimension 44x44x25mm

2. photos pour la pince en verre type D type 316 miroir en acier inoxydable poli
(modèle G102)







3. différents modèles de pince en verre carré type D 316 en acier inoxydable

Material	Stainless steel 304/ 316
Finish	satın / mirror polished

Material	Stainless steel 304/ 316
Finish	Satın / mirror polished
For glass thickness	6mm -13.52mm

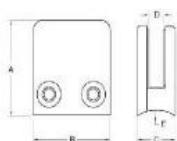

Model No.	A	B	C	D	E
G102	44	44	25	11	0
G102R	46	44	25	11	R:21.5

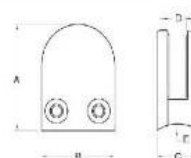

Model No.	A	B	C	D	E
G103	50	40	22	8	0
G104	50	40	28	12	0
G105	55	46	28	14	0
G103R	52	40	22	8	R:21.5
G104R	52	40	28	12	R:21.5
G105R	56	46	28	14	R:25.4

4. Instructions d'installation des pinces en verre en acier inoxydable

Glass Clamp Installation Guide



Mark and centre punch desired location of blind rivet nut location.



Drill centre punched hole in tube to suit blind rivet nut.

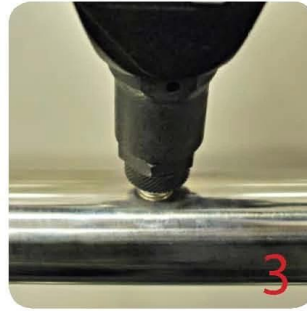

Insert blind rivet nut into tube and fasten with blind rivet tool.



Check installed blind rivet nut is secure and ready for install.



Align half glass clamp with blind rivet nut inline position. Screw in button head cap screw into thread and tighten with hex key.



Select appropriate rubber gasket to suit glass panel thickness. Install rubber gasket into both sides of glass clamp. (Note rubber gasket marked with sizes).



If heavier clamping load is required please use supplied glass clamp pin, during the install process. Note glass panels will require drilling in order to fit glass clamp pins.



Fit glass panel into position, install second half of glass clamp secure with provided hex screws.



Tighten glass clamps with hex key, and check glass panel are secure with no movement.





