

3/8" stainless steel square glass clamp china manufacturer G102

specification

1.dimension:44*44*25mm

2 square glass clamp in 304SS and 316SS material

3.finish:satin and mirror

4.to suit 40*40/50*50mm square post with 1.5-2mm wall thickness

5.to fit.glass thickness:3/8"

6.MOQ:1pc

7.other handrail fittings such as end cap,tube connector,handrail bracket,base and cover available

8.tech:made by casting

9.country:China

Product show



G102

Material

Stainless steel 304/ 316

Finish

satin / mirror polished

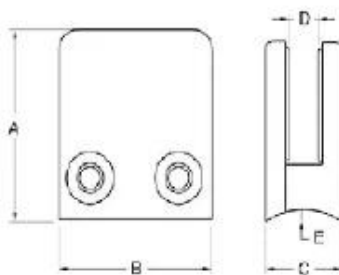

Model No.	A	B	C	D	E
G102	44	44	25	11	0
G102R	48	44	25	11	R-21.5



General information about glass clamp

product name	D glass clamp
	square glass clamp
glass thickness	6-13.52mm
pipe	glass clamp with arc base for round pipe
	glass clamp with flat base for square pipe
material	stainless steel 304/316
finish	satin/mirror
MOQ	1pc
tech	by casting
country	China

[D glass clamp](#)



G105R

packing pic



Packaging details:

10 pcs/ box (210*60*60mm)

10 boxes/carton(325*220*140mm).

Other handrail fittings as below

tube connector

[stainless steel elbow for round handrail pipe](#),[stainless steel round handrail post elbow for stair](#)



E306

handrail bracket

[stainless steel 12mm glass to round handrail bracket for stair, stainless steel glass to round handrail post bracket for balcony](#)



P707

end cap

[stainless steel end cap for round handrail pipe, stainless steel round handrail post end cap for stair](#)



LCH-213

cable tensor

[stainless steel indoor wire rope railing system for staircase design,](#)
[inox304/316 cable railing with cable tensor for stair and balcony](#)



glass standoff

[frameless stainless steel glass standoff for balcony, balcony design stainless steel outdoor glass standoff](#)

