

## Description

[Certified \*\*square\*\* aluminum railing handrail posts for 10-12mm glass.](#)

- Dimension: 50x50mm, post wall thickness 3mm
- Hight: 1100mm or as per your requirement
- Finish: Anodizing, powder coating
- Handrail type: end cap required or top rail required
- Mounting: surface mounting (fixing into ground post is available)
- For both commerical and modern house home handrail design
- For both wholesale and retail ( we are factory)
- Sample: always available
- Application: balcony,deck,pool fence,stair case aluminum glass railing

A kit of aluminum handrail posts

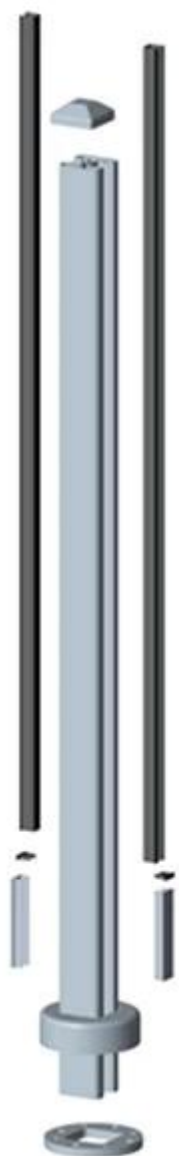

**Square 1 way**



**Square 2 way  
180 degree**



**Square 2 way  
135 degree**



**Square 2 way  
90 degree**



Details  
Optional finish

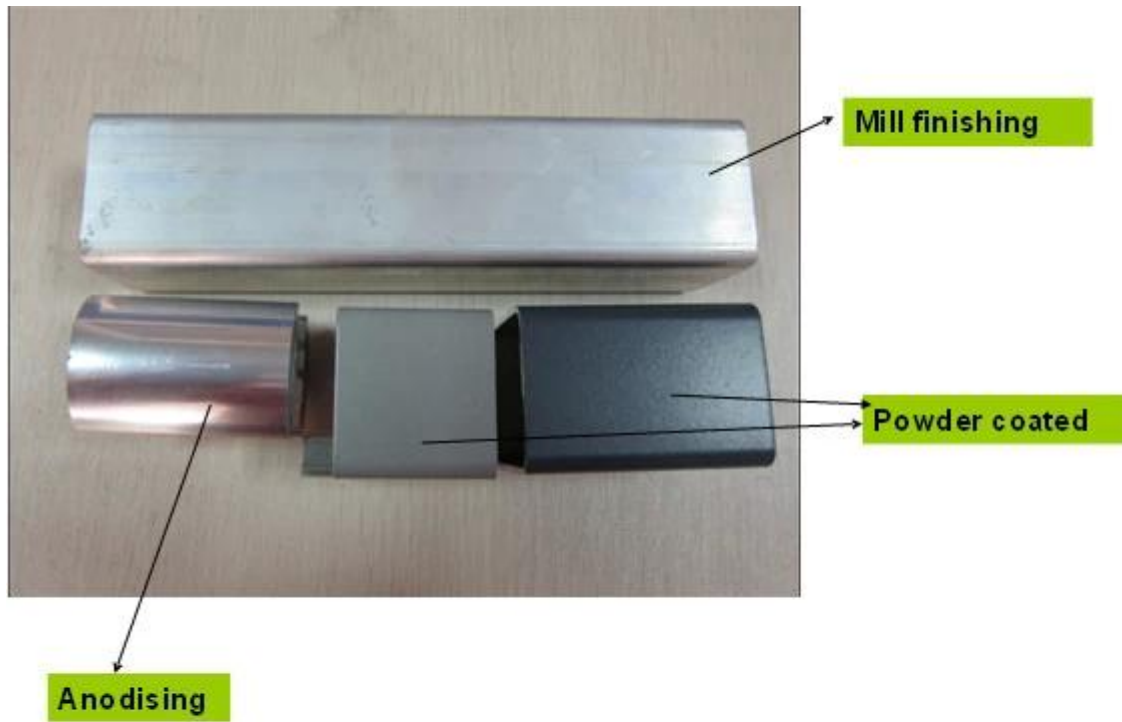

## Base plate and fittings

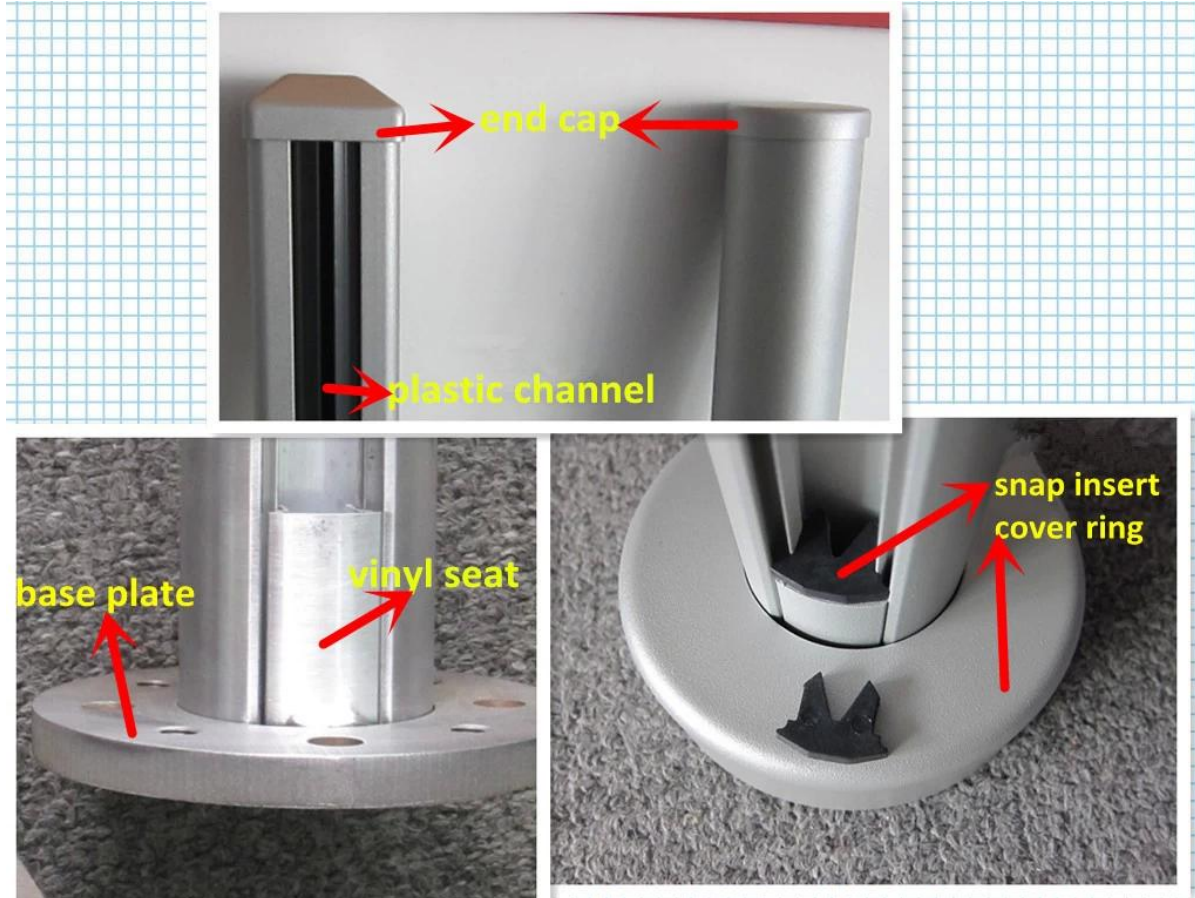

## Project



Aluminum handrail for outdoor deck railing



Side mounted aluminum handrail post project in Norway



## Aluminum handrail posts for safety swimming pool fence



## Packaging & Delivery

--Delivery time: 5-7 days by air, 15-20 days by sea

--Regular lead time: 10-15 days if goods are in stock, 20-25 days if goods are not in stock. It depends on quantity.

--Packaging: plastic bag →cardboard→carton





Factory&Certification





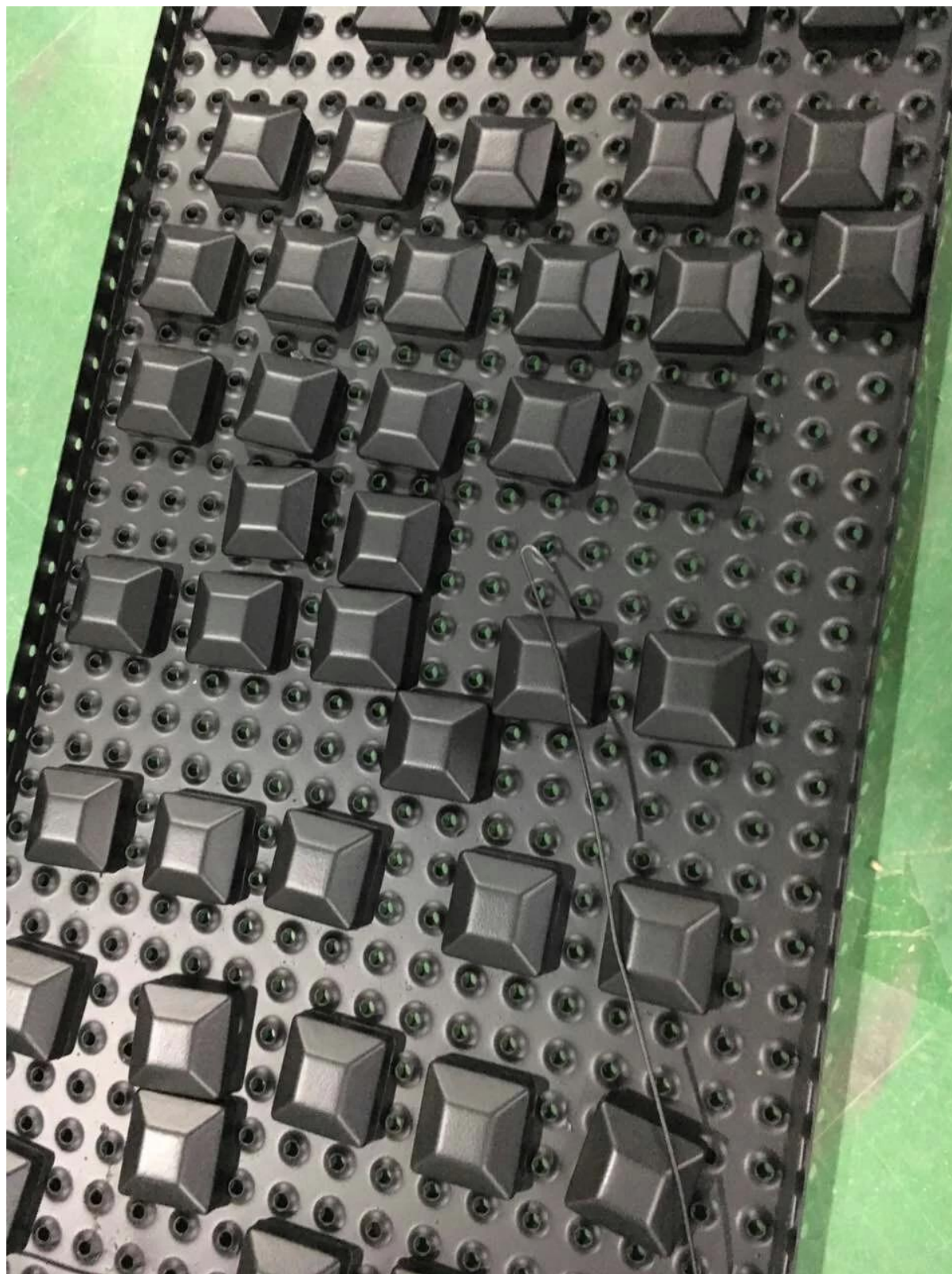







## Shenzhen Launch Co.,Ltd



**www.launch-china.cn**

Need a quote or any questions, please leave a message.

Or contact me as below info. will get back to you as soon as possible!

For any urgent enquiry, please get in touch on wechat: 973219879 or what's up: +86-13530506265





深圳市朗驰商贸有限公司  
SHENZHEN LAUNCH CO., LTD.

朗驰国际有限公司  
LAUNCH INTERNATIONAL LIMITED.

**董 萍** Doris Dong

Senior Sales Representative

☎ (86) 135 3050 6265

---

深圳市南山区南山大道1092号亿利达大厦B区3栋5003

Room 5003, Building 3, Yilida Building, No.1092  
Nanshan Road, Nanshan District, Shenzhen, China  
postal code 518054

---

☎ (86-755) 8603 7559

☎ (86-755) 8637 2611

✉ sales04@launch-china.cn

💻 www.launch-china.com

www.chinabalustrade.com