

1.Description

- Has pass the strength test
- For glass thickness: 8-12mm
- Post thickness: 3mm
- Glass to ground distance: 50mm
- 2 fixing aluminum post
 - 1.Fixing into concrete (1800mm high)
 - 2.With base plates (1265mm high)

2.Products show

- Round aluminum post



Round 1 way



**Round 2 way
180 degree**



**Round 2 way
135 degree**



**Round 2 way
90 degree**



--Square aluminum post

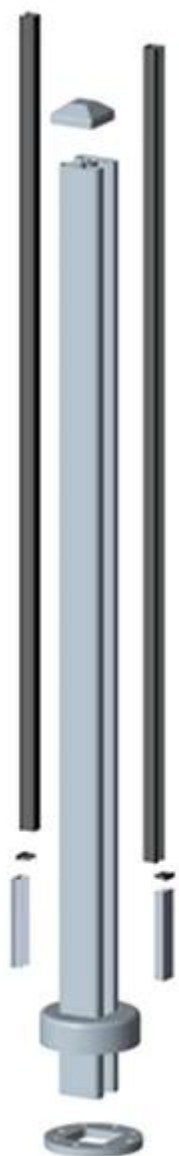

Square 1 way



**Square 2 way
180 degree**



**Square 2 way
135 degree**



**Square 2 way
90 degree**



3.Project

Aluminum post for pool fencing (normally used with [hinge](#) and [latch](#))





Aluminum post for deck railing



Aluminum post for balcony railing



Aluminum post for staircase railing



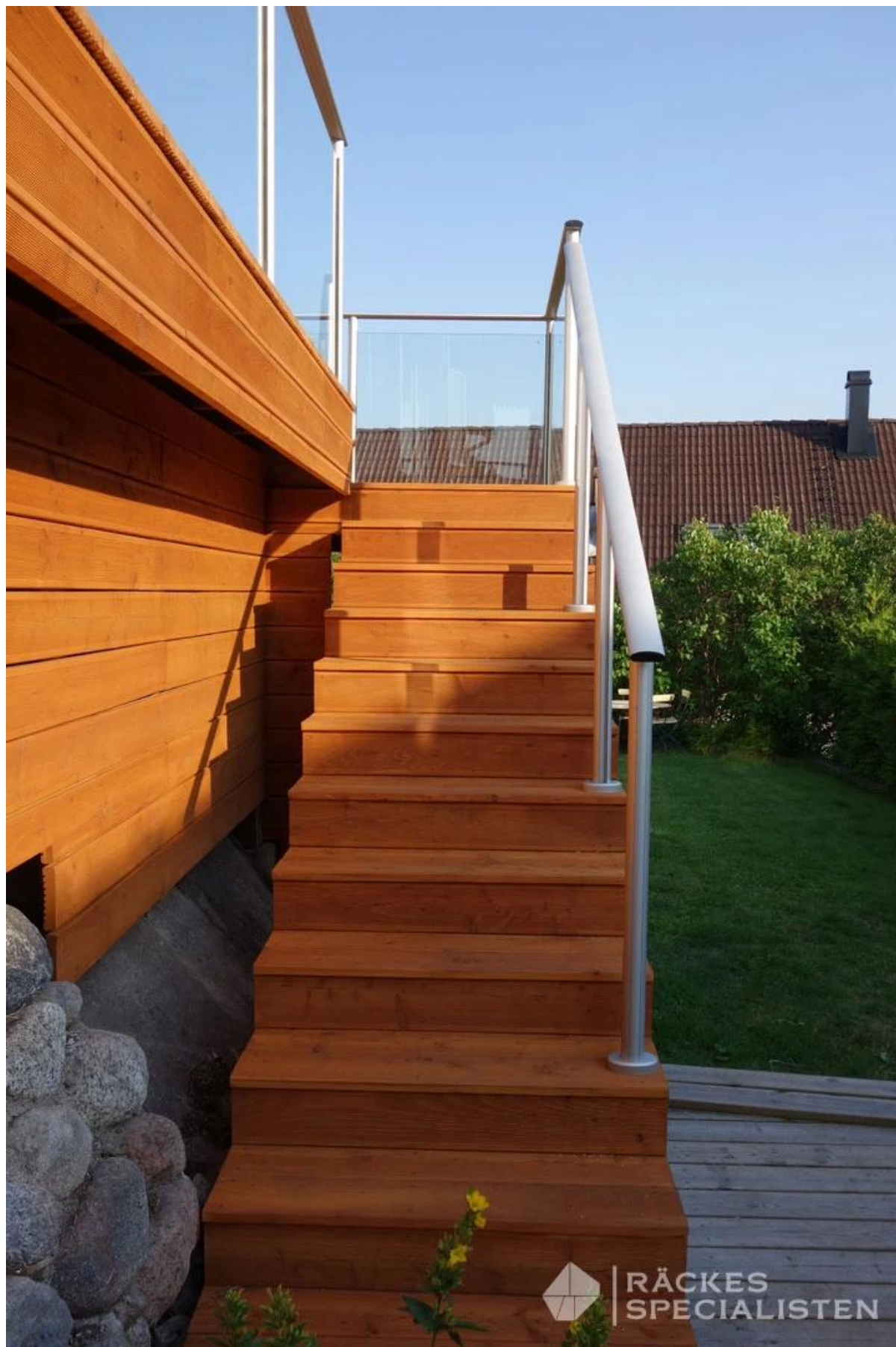

RÄCKES
SPECIALISTEN



4.Aluminum post top rail (with or without top rail, it depends on customers requirement)

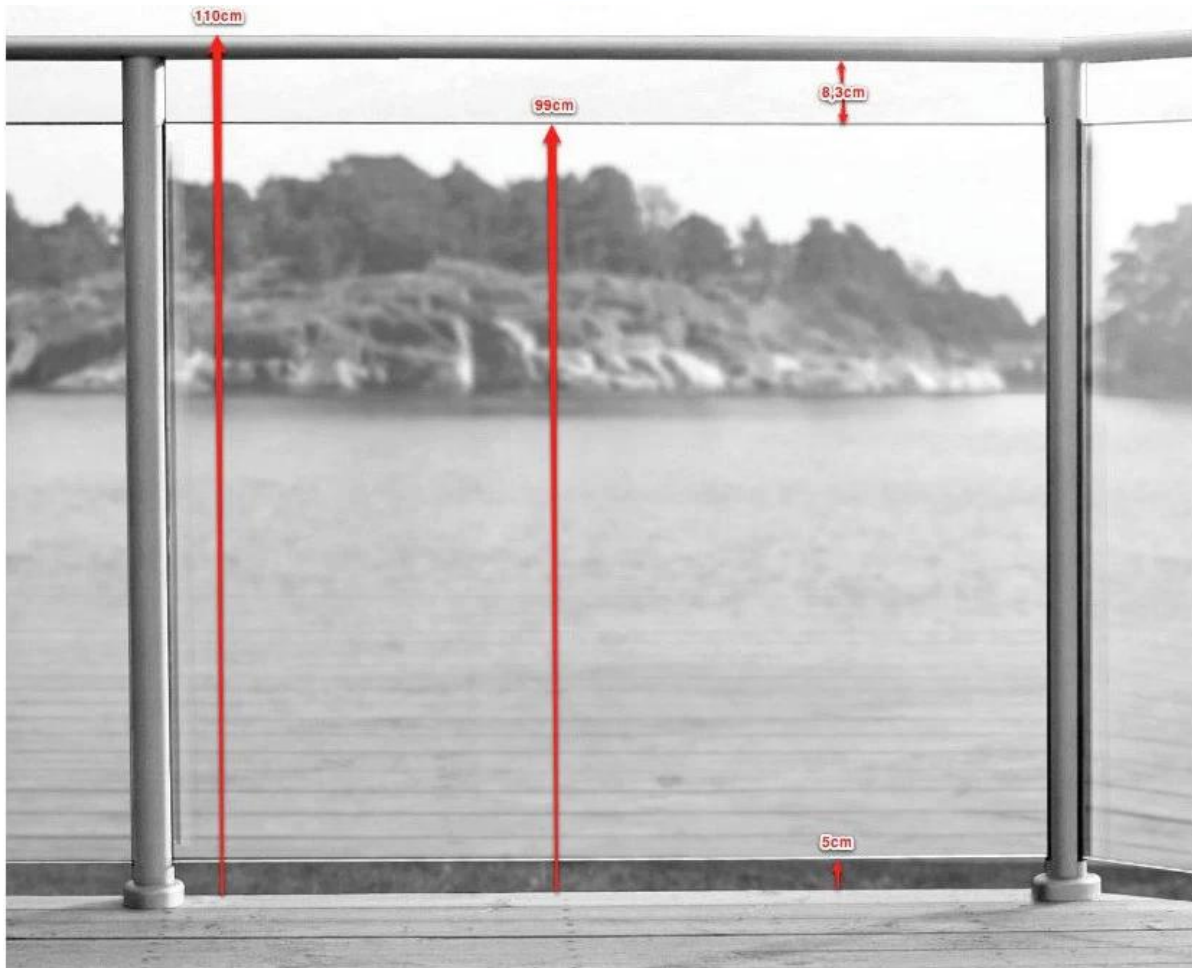
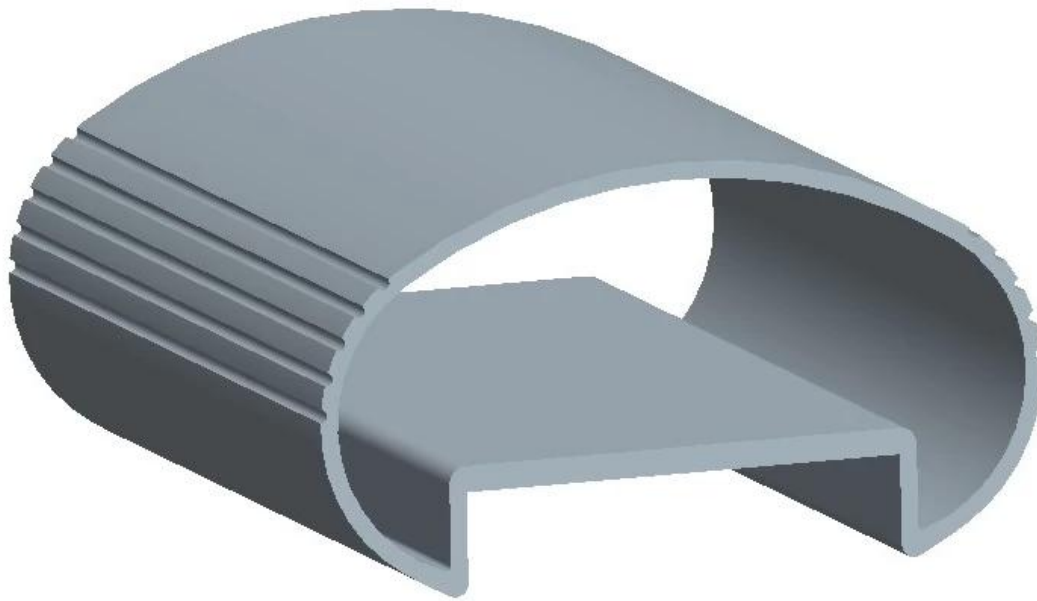



5.Details

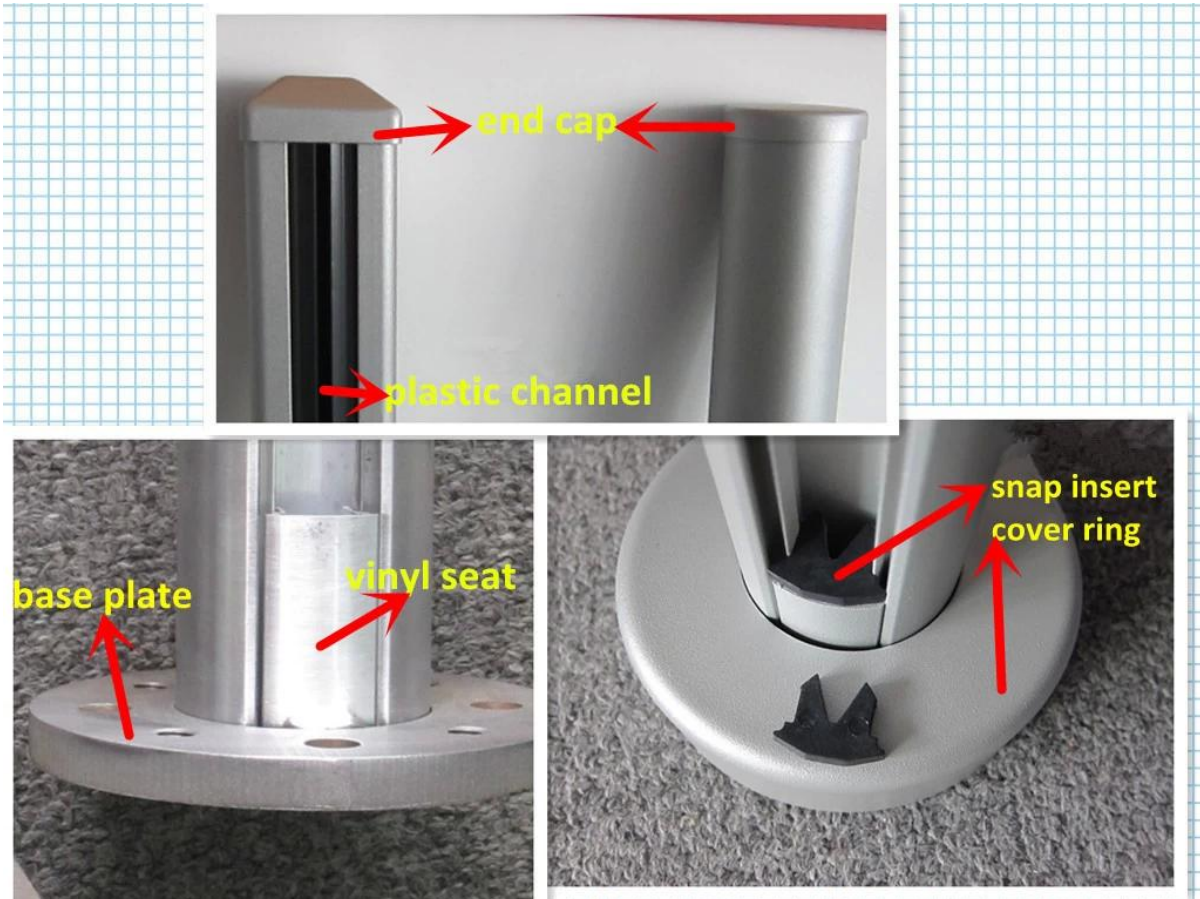

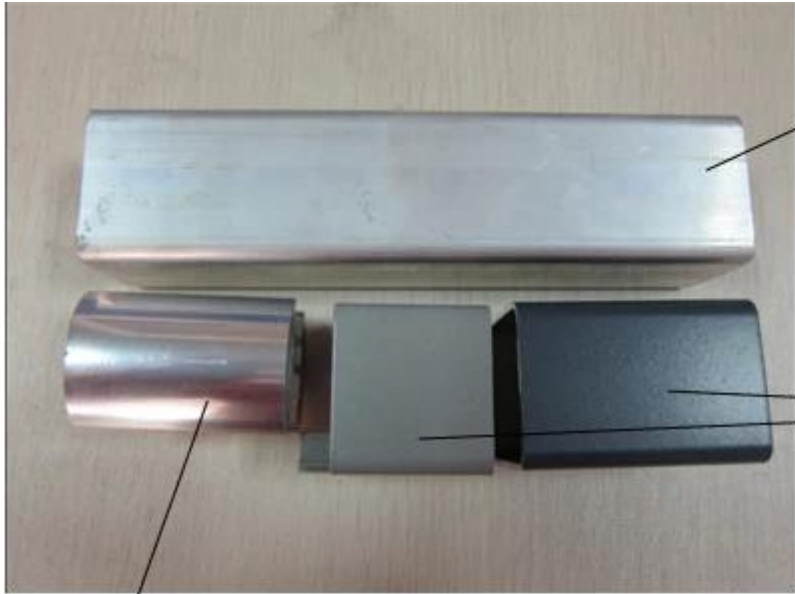

Mill finishing

Powder coated

Anodising









6.Factory





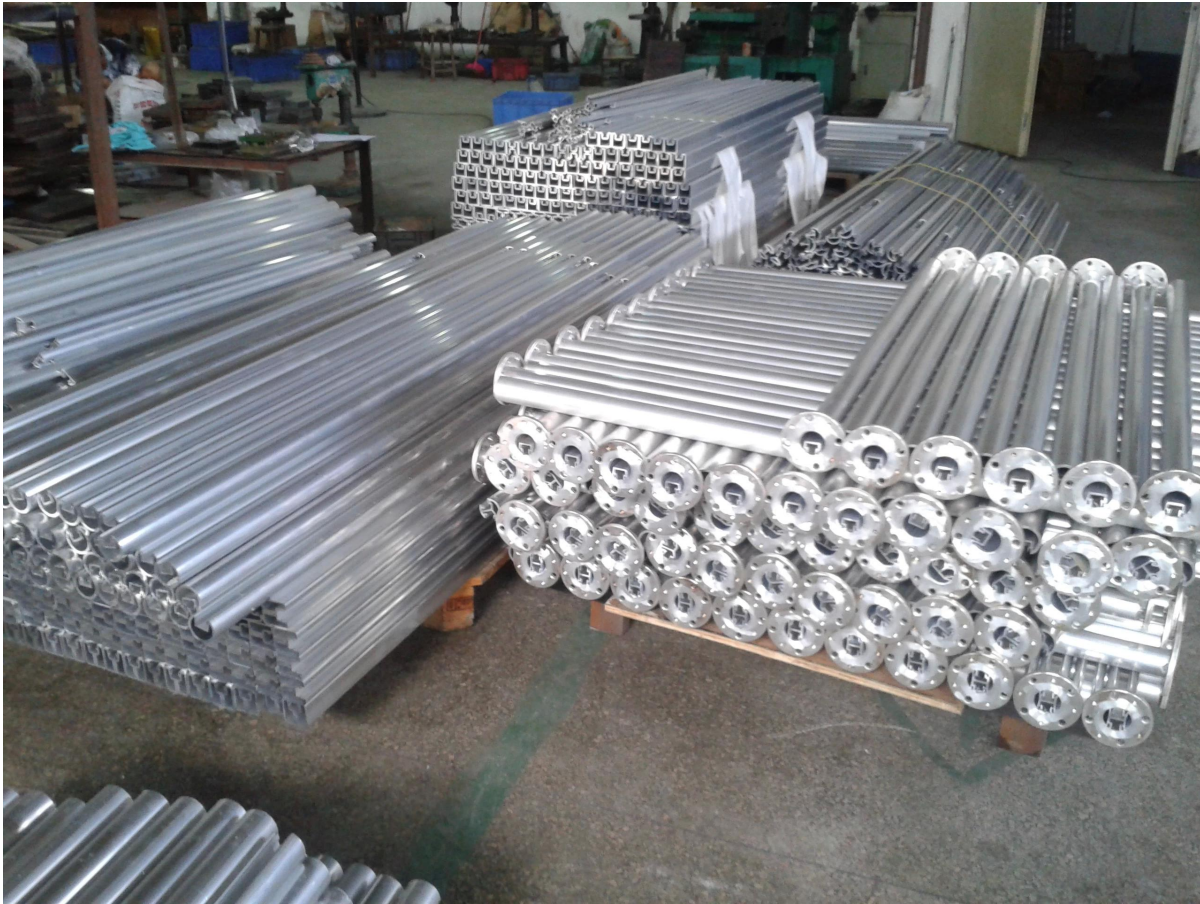







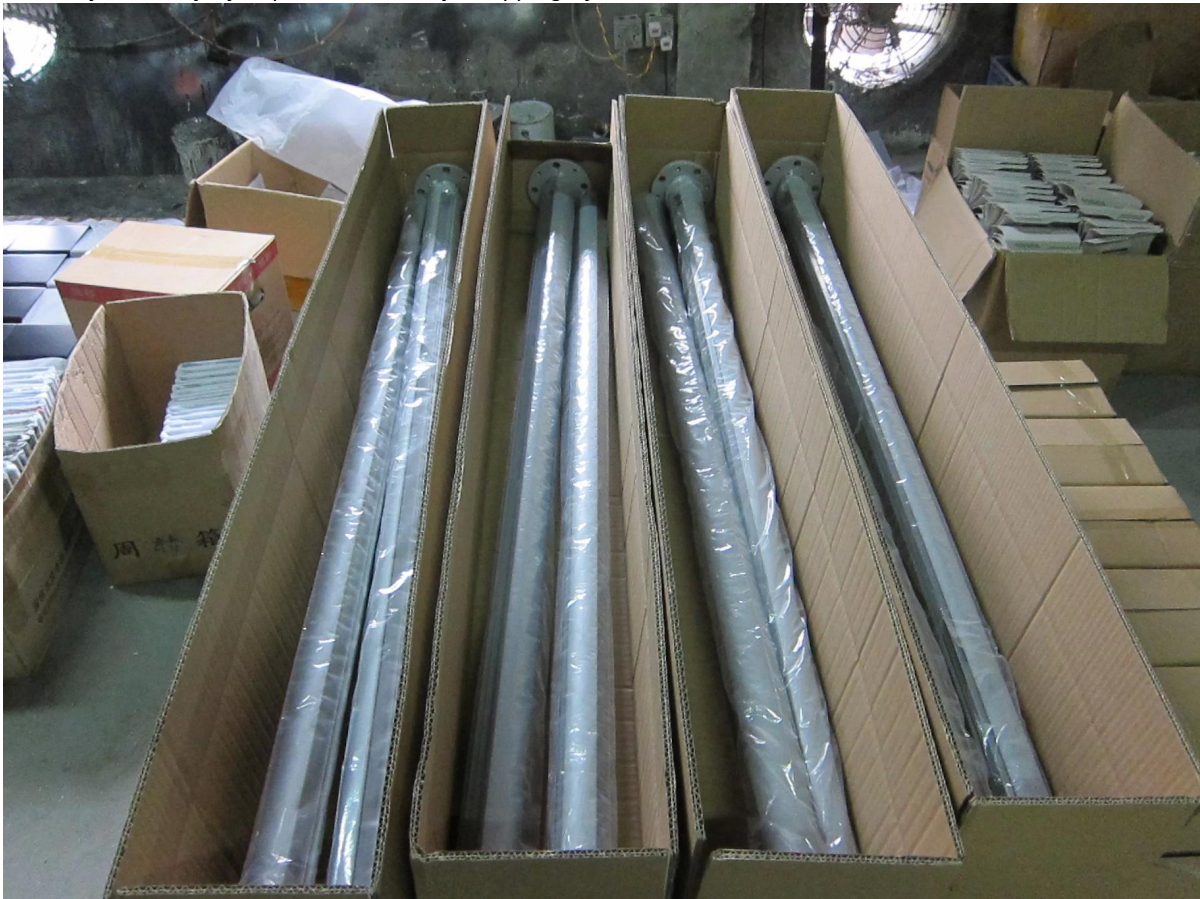

7. Packaging & Delivery

--one pc into one plastic bag, then into one box.

--3-5 days delivery by express. 10-15 days shipping by sea





packing	plastic bag+box+carton
production lead time	30-45 days ; also depending on your qty.
Shippment	 
	 
	 
payment	 

8.Customers



Why choose Launch--advantages

1. Various ranges of items for your selection
2. Provide professional services (3D & AUTOCAD)
3. Special designs by customer can be made
4. Competitive price with good discount
5. Superb quality control, production inspected one by one
6. Timely delivery, usually within a month
7. Good service before, during and after sales
8. OEM, ODM available

9. Associated products



10.Certifactions



Thank you for visiting. Please do not hesitate to contact us for a quote and professional advises.



董 萍 Doris Dong

Senior Sales Representative

☎ (86) 135 3050 6265

深圳市南山区南山大道1092号亿利达大厦B区3栋5003

Room 5003, Building 3, Yilida Building, No.1092
Nanshan Road, Nanshan District, Shenzhen, China
postal code 518054

☎ (86-755) 8603 7559

☎ (86-755) 8637 2611

✉ sales04@launch-china.cn

💻 www.launch-china.com

www.chinabalustrade.com

For more beautiful aluminum railing pictures, go [here](#)