

# Architecture [Side Mounting Glass Spigot](#) for Balcony Framelsss Glass Railing Design

## Product Description

---

Product Mame	Architecture side mounting glass spigot for balcony framelsss glass railing design
Material	Stainless steel 316
Finish	Mirror polished / satin brushed
For Glass Thickness	8-13.52mm
Height	143mm
Drill glass hole	Diameter 14mm hole required in glass
Payment Term	PayPal, West Union, T/T
Manufacture Method	CNC machining (high quality)
Packaging Details	1) One piece into one bubble bag, then into one white box 2) 12 pieces into one cardboard carton Or packing as customers' requirements
Application	Balcony glass railing, staircase railing, deck railing design, swimming pool fence, balustrade frameless glass railing
Factory Inspection	Welcome
Sample	Available before order
Mount	Fascia mounting, side mounting glass spigot fixing into concrete or timber
MOQ	No limited. You can order as per your job requirement.
OEM & ODM Service	Available

## Side Mounting Glass Spigot Destails

---

1) Side mounting glass spigot real shot photos









2) Side mounting glass spigot size

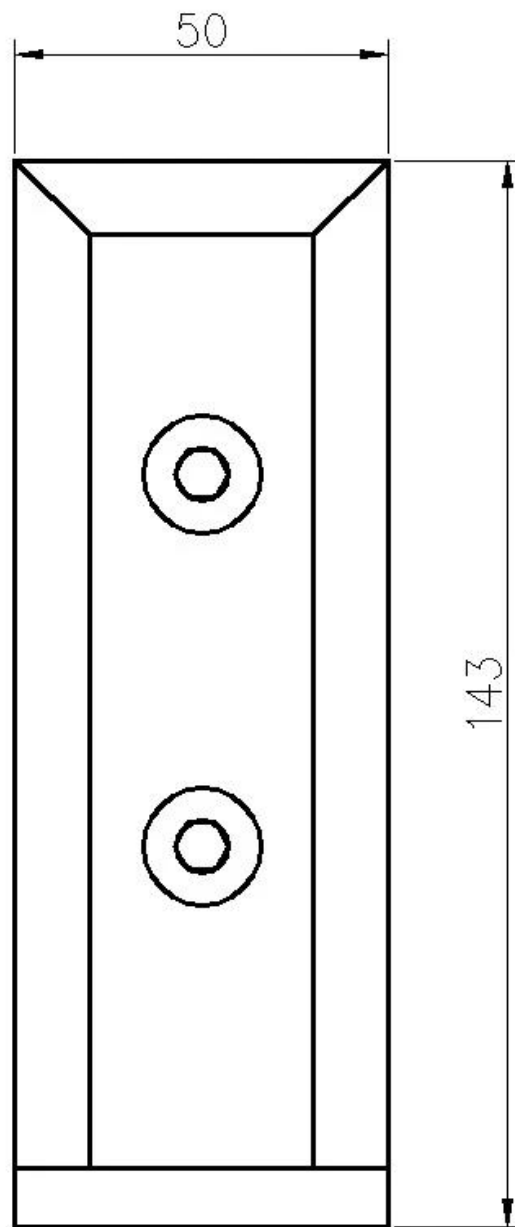
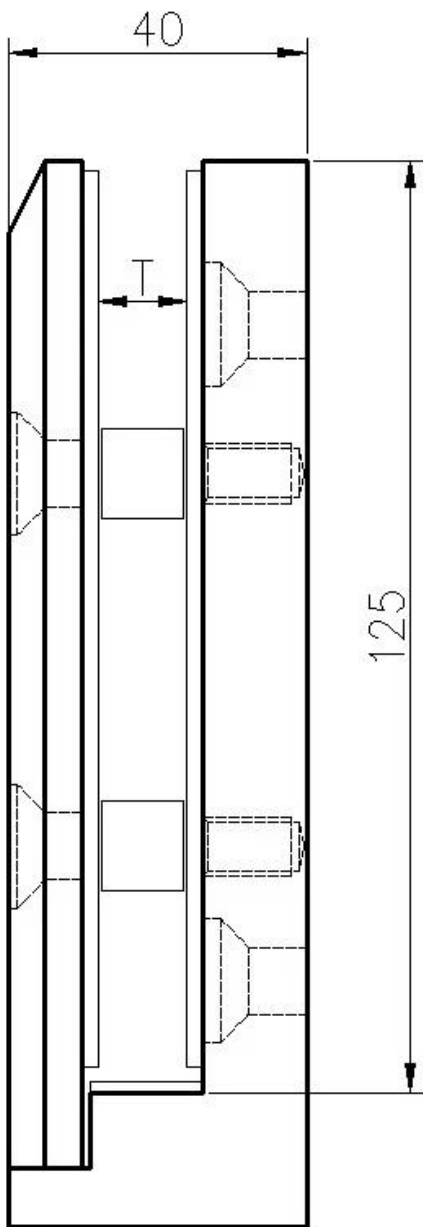

3) Side mounting glass spigot project





### **Side Mounting Glass Spigot Safety Packaging**

---

1. One piece into one bubble bag, then into one white box.  
12 pieces into one cardboard carton.
2. Packing as customers' requirements.



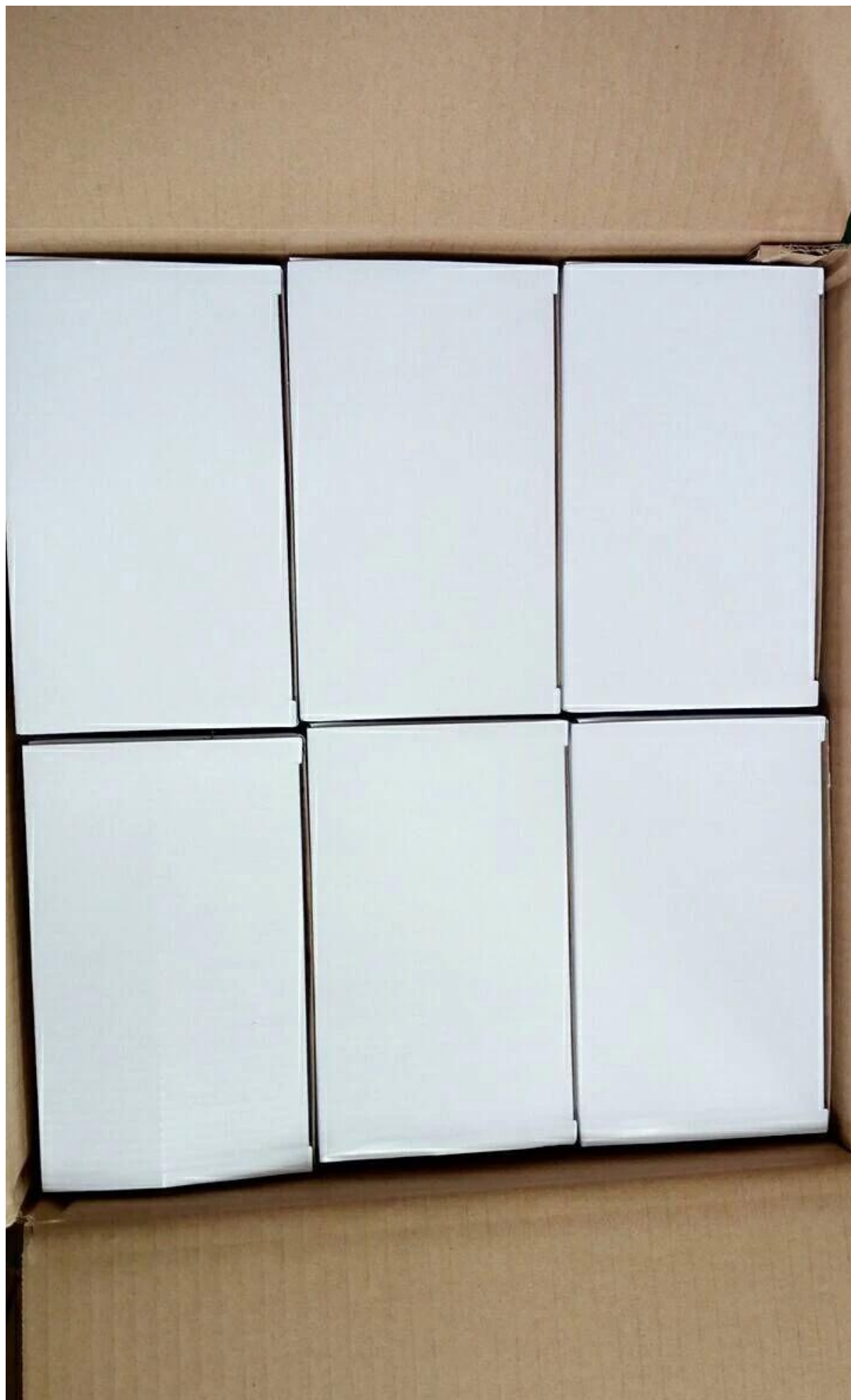

## FAQ

---

### 1.Are you factory?

Yes, we are factory.

### 2.Do you offer free samples?

Yes, we offer free samples, but customers need to pay express charges.

### 3.What materials do you have?

We have the material of stainless steel 304, 316, 316L and Duplex 2205.

### 4.What is your MOQ?

MOQ of order required is 1 pc.

### 5.What kind of payment do you accept?

We accept the payment of T/T, LC, PayPal, West Union, etc.

### 6.What is your payment term?

Our payment term is T/T 100% or 30/70 or L/C at sight .

### 7.What is your delivery time?

Our delivery time is from 5 days to 30 days based on your quantity.

### 8.Do you offer OEM & ODM service?

Yes we offer OEM&ODM service.

### 9.Do you offer after-sales service?

Yes, we offer after-sales service. Any complaint for orders will be dealt with in time within 12 hours.

## Contact

---

Any enquiries or questions, please leave a message. Will get back to you as soon as possible!

For any urgent enquiry, please get in touch below:

-Email: sales04@launch-china.cn

-Tel: (86-755) 8603 7559

-Skype: launch\_04

-Mob/whats APP: +86-13530506265



深圳市朗驰商贸有限公司  
SHENZHEN LAUNCH CO., LTD.

朗驰国际有限公司  
LAUNCH INTERNATIONAL LIMITED.

**董 萍** Doris Dong

Senior Sales Representative

☎ (86) 135 3050 6265

---

深圳市南山区南山大道1092号亿利达大厦B区3栋5003

Room 5003, Building 3, Yilida Building, No.1092  
Nanshan Road, Nanshan District, Shenzhen, China  
postal code 518054

---

☎ (86-755) 8603 7559

☎ (86-755) 8637 2611

✉ sales04@launch-china.cn

💻 www.launch-china.com

www.chinabalustrade.com