

316 stainless steel heavy duty CRL Glass Rail Standoff Fitting with Mounting Plate , designed for wood or concrete mount .

Features -

1. Model No. SF-50T
2. Weight around 3.5kg per pc
3. For glass thickness from 10mm upto 21.52mm
4. can be mounted to a wood, concrete, or steel substrate

Photos & drawing of CRL Glass Rail Standoff Fitting with Mounting Plate -





SF-50 T

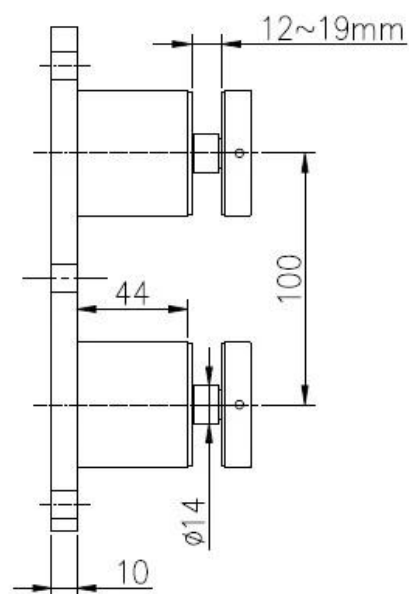
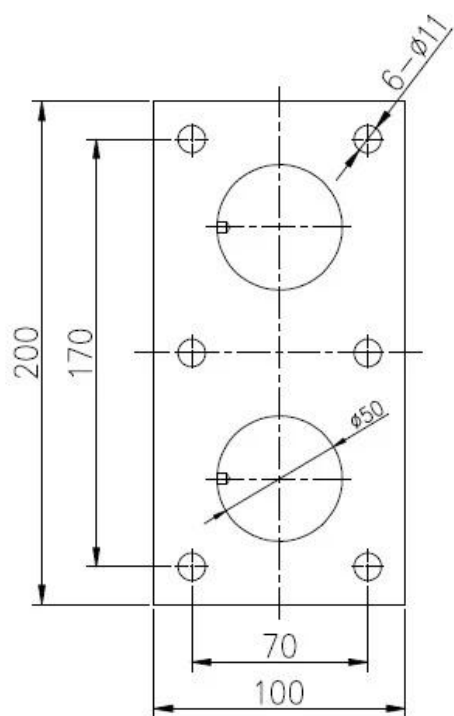



Related items -
Tempered glass for glass railings , click photo for more details-



Glass spigot for glass railings-

Glass spigot



MODEL # SBM



MODEL # SCM



MODEL # RBM



MODEL # RCM