

## **Stainless Steel Frameless Balcony Side Wall Face Mounted SmartGlass Spigots**

### **Product Description**

---

Product Name	Stainless Steel Frameless Balcony Side Wall Face Mounted Smart Glass Spigots
Material	Stainless steel 316
Finish	Mirror polished / satin brushed
For Glass Thickness	10-13.52mm
Height	143mm
Drill glass hole	Diameter 14mm hole required in glass
Payment Term	PayPal, West Union, T/T
Manufacture Method	CNC machining (high quality)
Packaging Details	1) One piece into one bubble bag, then into one white box 2) 12 pieces into one cardboard carton Or packing as customers' requirements
Application	Balcony glass railing, staircase railing, deck railing design, swimming pool fence, balustrade frameless glass railing
Factory Inspection	Welcome
Sample	Available before order
Mount	Fascia mounting, side mounting glass spigot fixing into concrete or timber substrate
MOQ	No limited. You can order as per your job requirement.
OEM & ODM Service	Available

### **Side Wall Face Mounted Smart Glass Spigots Destails**

---

1) Side Wall Face Mounted Smart Glass Spigotsp real shot photos





2) Technical drawing for Side Wall Face Mounted Smart Glass Spigots

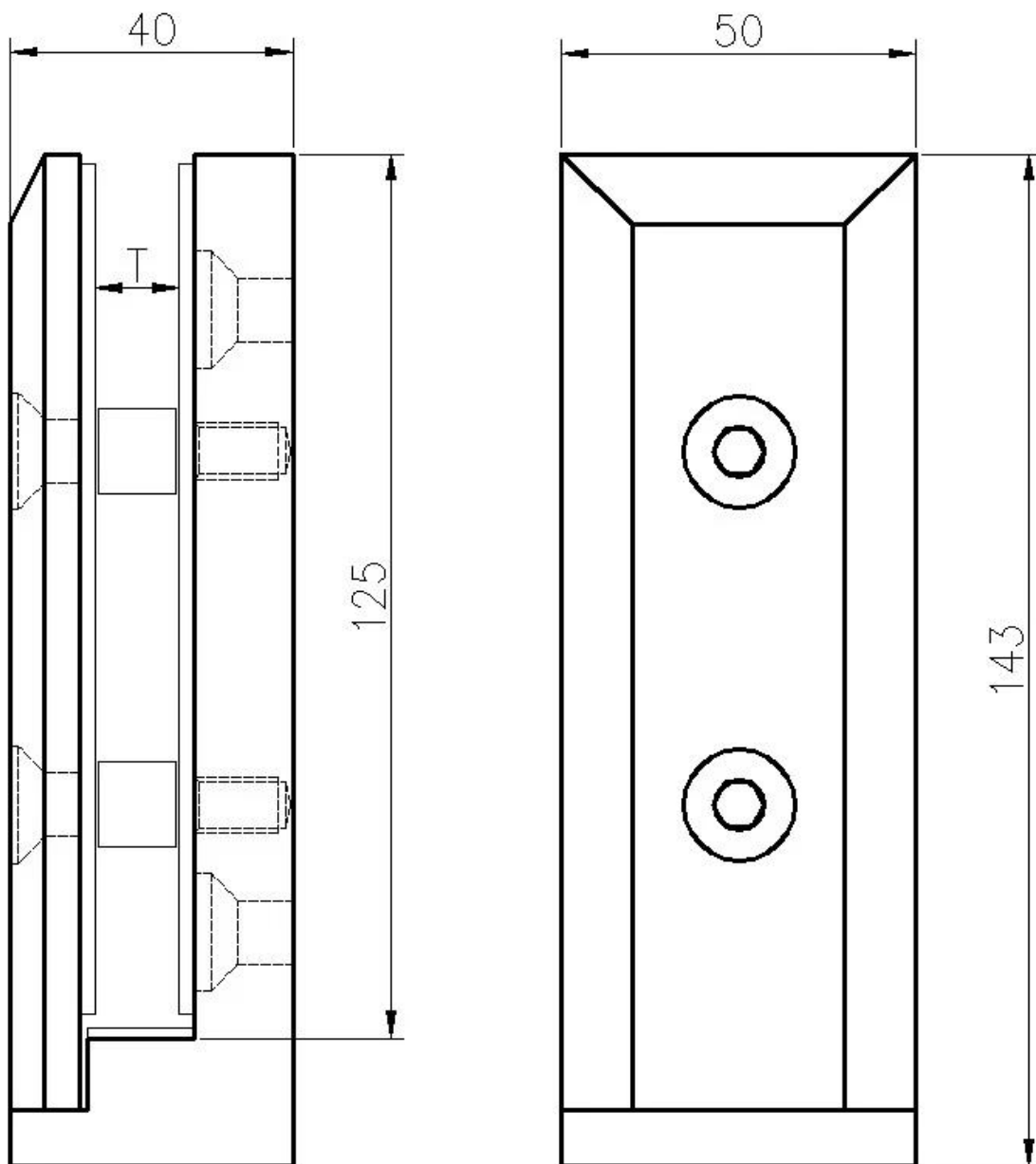

3) Stainless Steel Side Wall Face Mounted Smart Glass Spigots projects









### **Side Wall Face Mounted Smart Glass Spigots Packaging**

1. One piece into one bubble bag, then into one white box.

- 12 pieces into one cardboard carton.
2. Packing as customers' requirements.



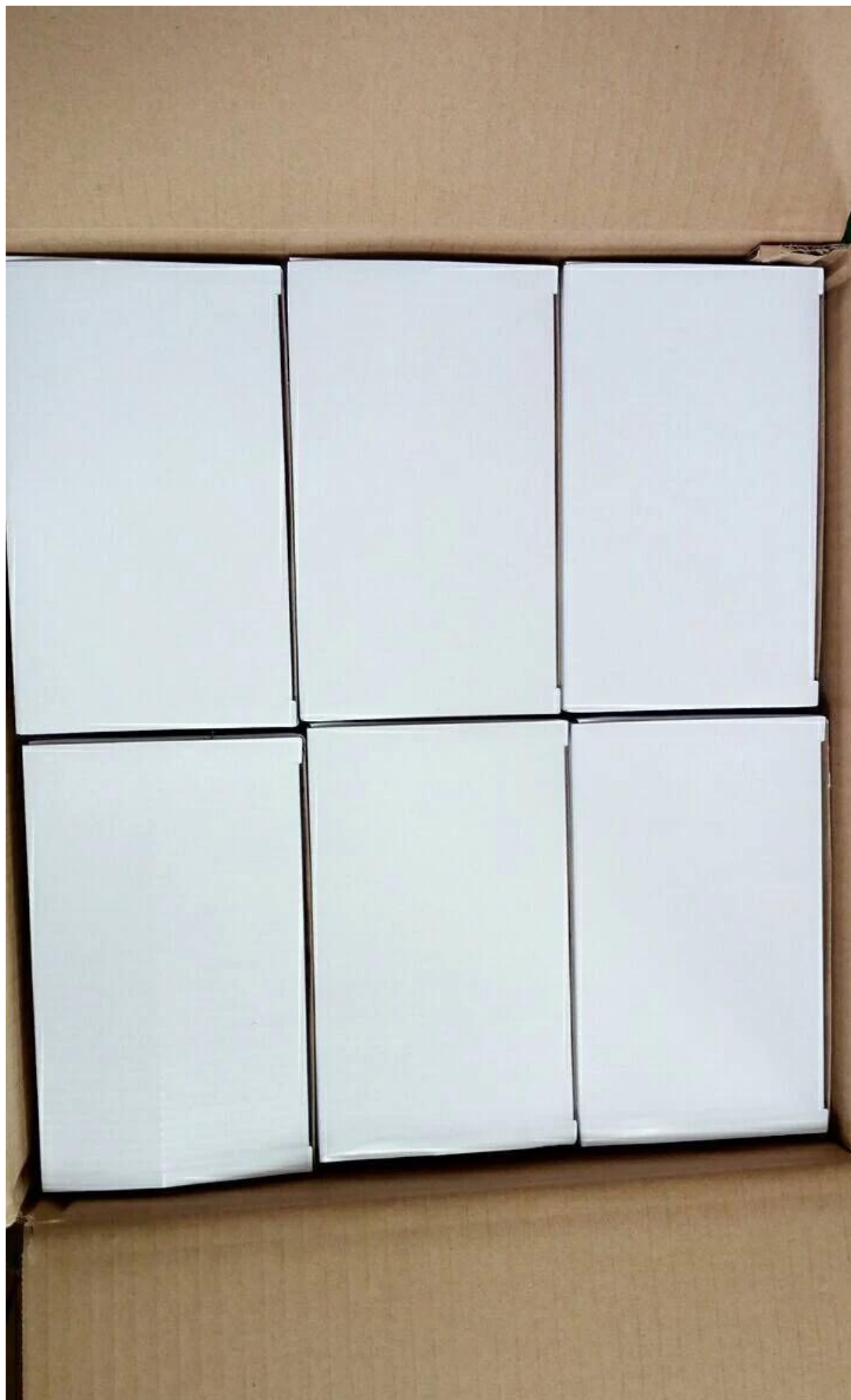



## FAQ

---

### 1.Are you factory?

Yes, we are factory.

### 2.Do you offer free samples?

Yes, we offer free samples, but customers need to pay express charges.

### 3.What materials do you have?

We have the material of stainless steel 304, 316, 316L and Duplex 2205.

### 4.What is your MOQ?

MOQ of order required is 1 pc.

### 5.What kind of payment do you accept?

We accept the payment of T/T, LC, PayPal, West Union, etc.

### 6.What is your payment term?

Our payment term is T/T 100% or 30/70 or L/C at sight .

### 7.What is your delivery time?

Our delivery time is from 5 days to 30 days based on your quantity.

### 8.Do you offer OEM & ODM service?

Yes we offer OEM&ODM service.

### 9.Do you offer after-sales service?

Yes, we offer after-sales service. Any complaint for orders will be dealt with in time within 12 hours.

## Contact

---

Any enquiries or questions, please leave a message. Will get back to you as soon as possible!  
For any urgent enquiry, please get in touch below:

-Email: sales03@launch-china.cn

-Tel: (86-755) 8603 7559

-Skype: launch\_03

-Mob/whats APP: +8613686807796