

Bolt Fixing Stainless Steel Glass Spider Fitting for 20mm glass applied for glass railings or curtain walls . The glass spider fitting is made by precision casting with mould available .

Photos for Glass Spider Standoff -

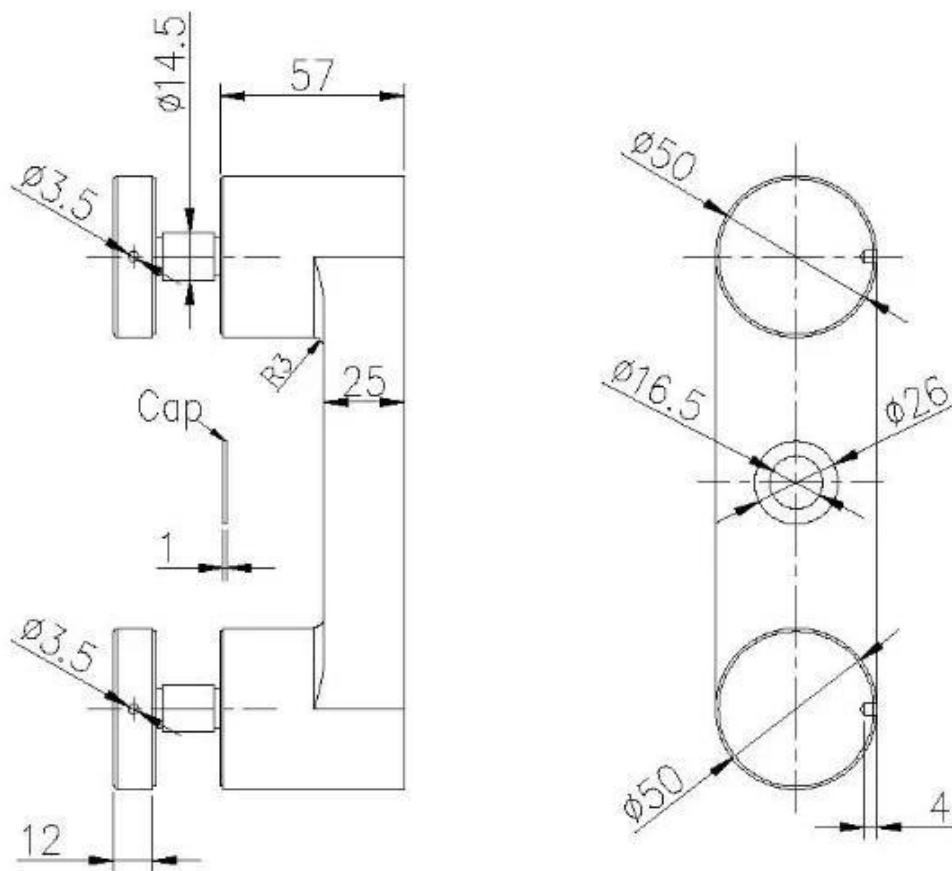

Dimensions for Glass Spider Standoff -



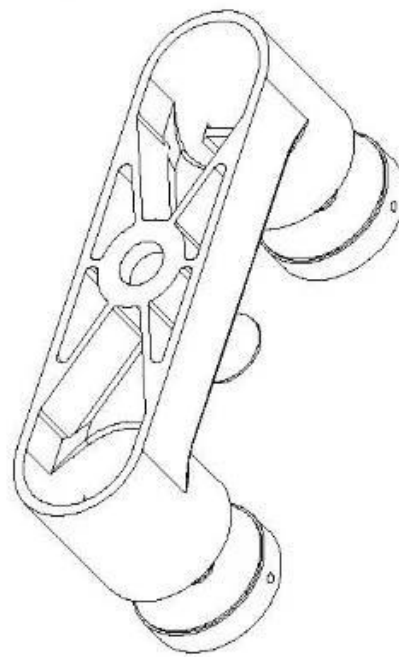
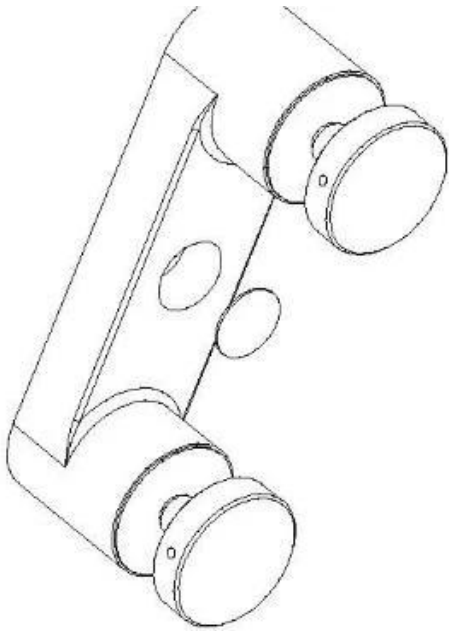

Production photos -





Packaging - 1 pc glass spider fitting in a foam bag , then in a box

