

1. Description

- Stainless steel 301/316 adjustable tube connector for handrail post
- Finish: mirror or satin
- Different size is available (Please send us drawing and qty to help us quote)

2. Product picture

STAINLESS STEEL BALUSTRADE AND FITTINGS

KEBIL 科比奥
SHENZHEN LAUNCH CO., LTD



http://www.chinabalustrade.com

TUBE CONNECTOR



Model No. : E301	
Material	Stainless steel 304/ 316
Finish	Satin or mirror polished
For tube size	Φ42mm or Φ50.8mm



Model No. : E302	
Material	Stainless steel 304/ 316
Finish	Satin or mirror polished
For tube size	Φ43mm or Φ50.8mm



Model No. : E303	
Material	Stainless steel 304/ 316
Finish	Satin or mirror polished
For tube size	Φ43mm or Φ50.8mm



Model No. : E304	
Material	Stainless steel 304/ 316
Finish	Satin or mirror polished
For tube size	Φ12mm , Φ20mm , Φ38mm , Φ43mm , Φ50.8mm



Model No. : E305	
Material	Stainless steel 304/ 316
Finish	Satin or mirror polished
For tube size	Φ12mm , Φ20mm



Model No. : E306	
Material	Stainless steel 304/ 316
Finish	Satin or mirror polished
For tube size	Φ50.8mm



Model No. : E307	
Material	Stainless steel 304/ 316
Finish	Satin or mirror polished
For tube size	Φ43mm



Model No. : B502	
Material	Stainless steel 304/ 316
Finish	Satin or mirror polished
For tube size	Φ12mm



Model No. : S401	
Material	Stainless steel 304/ 316
Finish	Satin or mirror polished
For tube size	40*40mm , 50*50mm , 40*70mm



Model No. : S402	
Material	Stainless steel 304/ 316
Finish	Satin or mirror polished
For tube size	40*40mm



Model No. : S403	
Material	Stainless steel 304/ 316
Finish	Satin or mirror polished
For tube size	40*40mm



Model No. : S404	
Material	Stainless steel 304/ 316
Finish	Satin or mirror polished
For tube size	40*40mm

3. Drawing

--Model No.:E305



E305/12

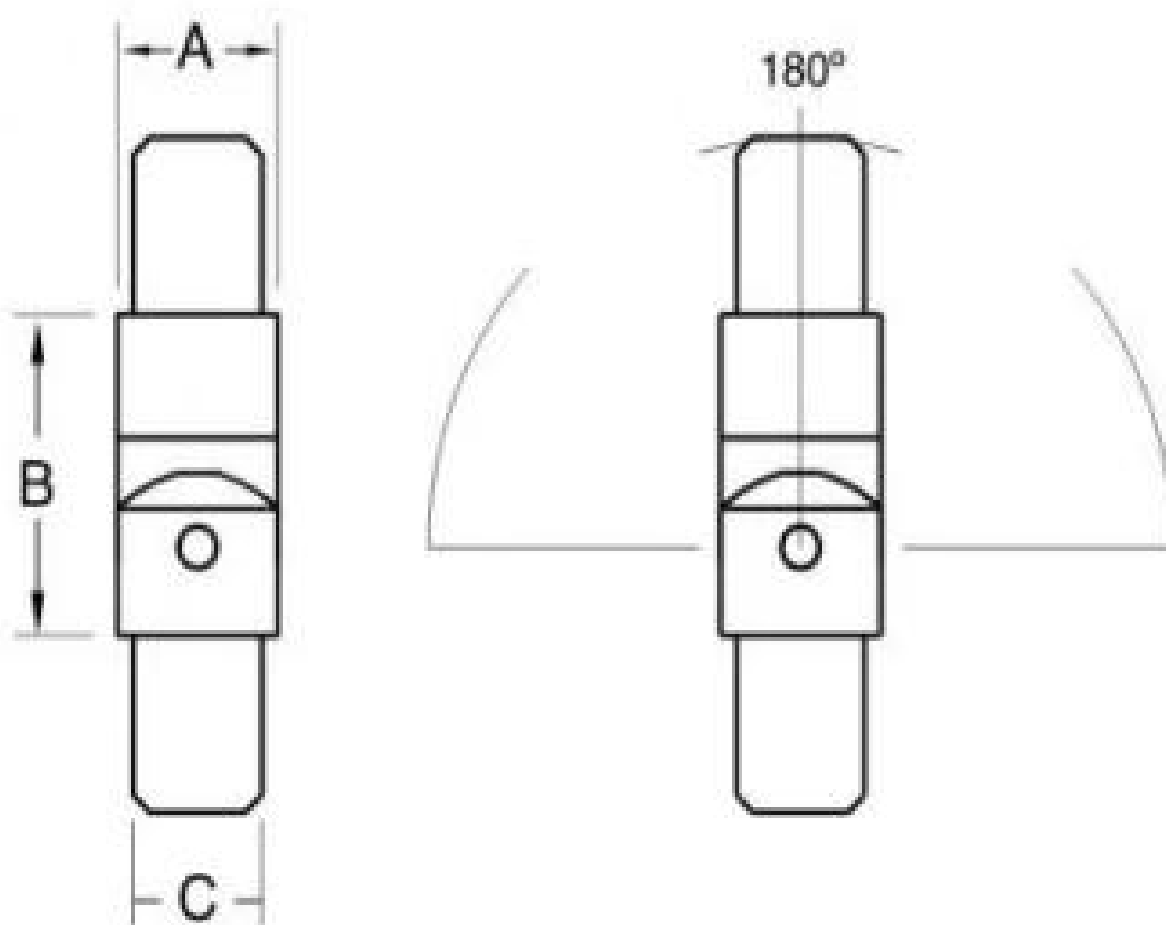

Description: The joint to connect 12mm tubes with graduations between 90° and 180°.
描述: 此接头连接12mm管从90°到180°范围变化.

新编号	旧编号	A	B	C
E305/12	R-12	12	21	10

E305/20

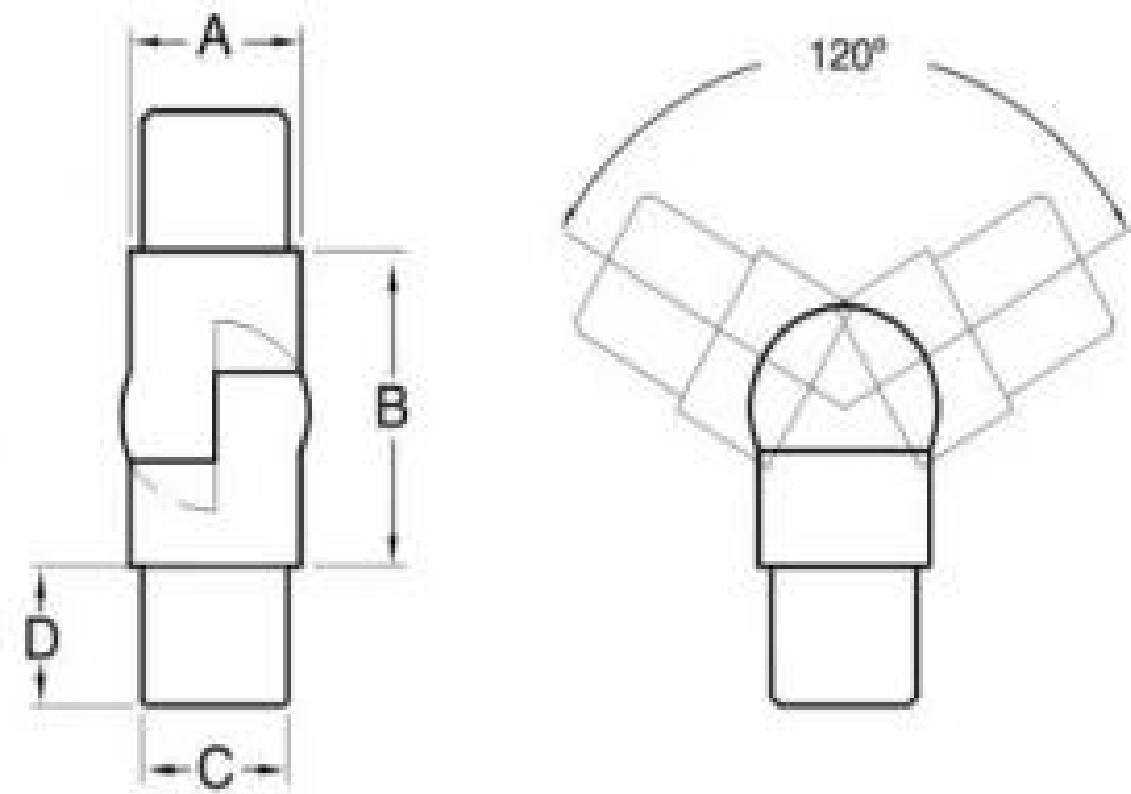

Description: The joint to connect 20mm tubes with graduations between 90° and 180°.
描述: 此接头连接20mm管从90°到180°范围变化.

新编号	旧编号	A	B	C	D
E305/20	R-20	20	34	17	15

--Model No.: E307



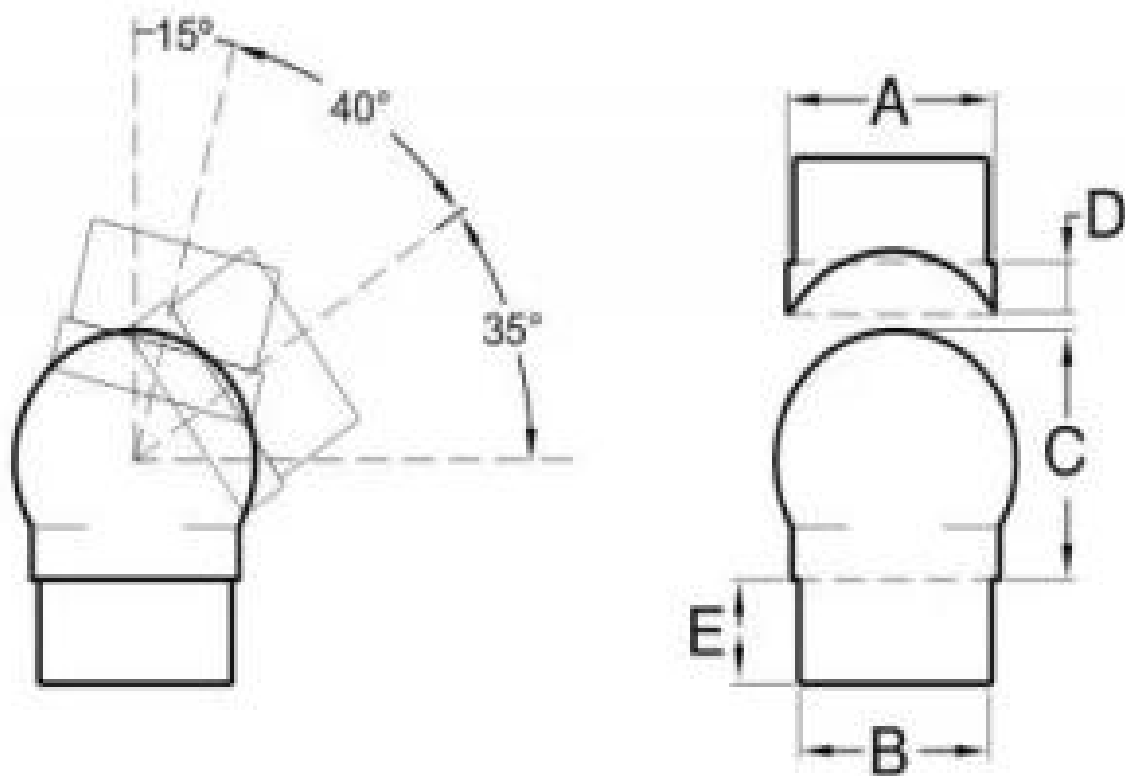

Description: Spherical joint to connect handrail with graduations between 90° and 180°
描述: 球面接头连接楼梯扶手从90°到180°范围变化。

新编号	旧编号	A	B	C	D	E
E306/43	R-43	43	40	48	10	20

3.Details



















4.Delivery & Packing

- Delivery: 3-5 days by express. 10-15 days by shipping
- Packing: one pc into one plastic bag, then into one box.
- Lead time: about 20 days after payment. (It depent on quantity)



packing	plastic bag+box+carton
production lead time	30-45 days ; also depending on your qty.
Shippment	 
	 
	 
payment	 

5.Associated Products

[Square tube connector](#)

Parts for handrail post







5. Factory & Certification





6. Customers





7.Contact



董 萍 Doris Dong

Senior Sales Representative

☎ (86) 135 3050 6265

深圳市南山区南山大道1092号亿利达大厦B区3栋5003

Room 5003, Building 3, Yilida Building, No.1092
Nanshan Road, Nanshan District, Shenzhen, China
postal code 518054

☎ (86-755) 8603 7559

☎ (86-755) 8637 2611

✉ sales04@launch-china.cn

💻 www.launch-china.com

www.chinabalustrade.com

Thank you for visiting. Please do not heasite to contact us for factory direct price and professional advises.