

Wholesale Frameless Glass Railing Bracket [Side Mounted Glass Spigot](#)

Product Description

| | |
|---------------------|--|
| Product Name | Wholesale frameless glass railing bracket side mounted glass spigot |
| Material | Stainless steel 316 / duplex 2205 |
| Finish | Mirror polished / satin brushed |
| For Glass Thickness | 8-13.52mm |
| Height | 143mm |
| Drilled glass hole | Diameter 14mm hole required in glass |
| Payment Term | PayPal, West Union, T/T |
| Manufacture Method | CNC machining (high quality) |
| Packaging Details | 1) One piece into one bubble bag, then into one white box 2) 12 pieces into one cardboard carton Or packing as customers' requirements |
| Application | Balcony, stairs, deck, steps, pool fence frameless glass railing |
| Factory Inspection | Welcome |
| Sample | Available before order |
| Mount | Fascia mounting, side mounted glass spigot fixing into concrete or timber |
| MOQ | No limited. You can order as per your job requirement. |
| OEM & ODM Service | Available |

Side Mounted Glass Spigot Details

1) Side mounted glass spigot photos
Mirror finish





Satin finish





2) Side mounted glass spigot size

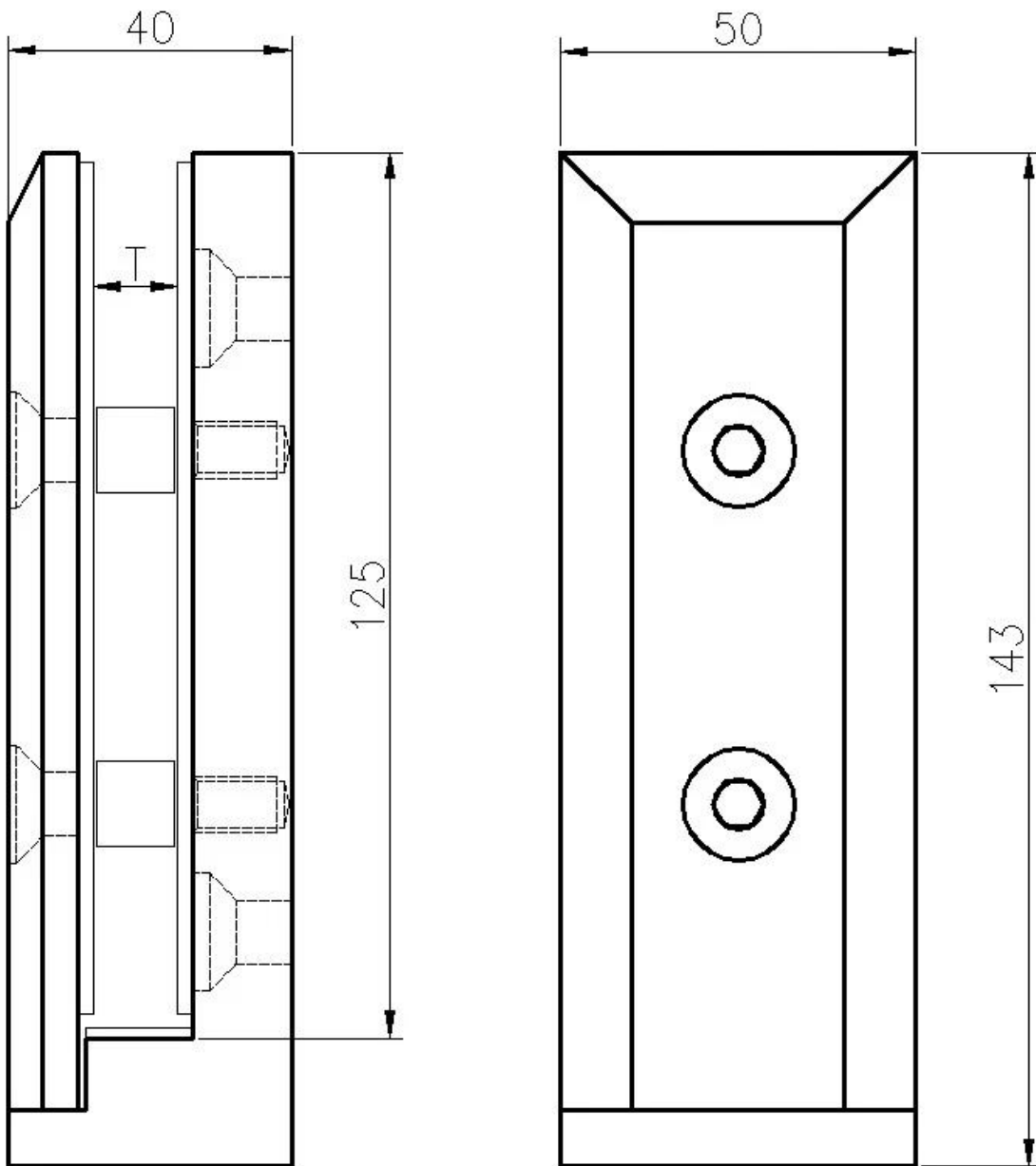

3) Side mounted glass spigot project





Side Mounted Glass Spigot Safety Packaging

1. One piece into one bubble bag, then into one white box.
12 pieces into one cardboard carton.
2. Packing as customers' requirements.





FAQ

1.Are you factory?

Yes, we are factory.

2.Do you offer free samples?

Yes, we offer free samples, but customers need to pay express charges.

3.What materials do you have?

We have the material of stainless steel 304, 316, 316L and Duplex 2205.

4.What is your MOQ?

MOQ of order required is 1 pc.

5.What kind of payment do you accept?

We accept the payment of T/T, LC, PayPal, West Union, etc.

6.What is your payment term?

Our payment term is T/T 100% or 30/70 or L/C at sight .

7.What is your delivery time?

Our delivery time is from 5 days to 30 days based on your quantity.

8.Do you offer OEM & ODM service?

Yes we offer OEM&ODM service.

9.Do you offer after-sales service?

Yes, we offer after-sales service. Any complaint for orders will be dealt with in time within 12 hours.

Contact

Any enquiries or questions, please leave a message. Will get back to you as soon as possible!

For any urgent enquiry, please get in touch below:

-Email: sales04@launch-china.cn

-Tel: (86-755) 8603 7559

-Skype: launch_04

-Mob/whats APP: +86-13530506265



深圳市朗驰商贸有限公司
SHENZHEN LAUNCH CO., LTD.

朗驰国际有限公司
LAUNCH INTERNATIONAL LIMITED.

董 萍 Doris Dong

Senior Sales Representative

☎ (86) 135 3050 6265

深圳市南山区南山大道1092号亿利达大厦B区3栋5003

Room 5003, Building 3, Yilida Building, No.1092
Nanshan Road, Nanshan District, Shenzhen, China
postal code 518054

☎ (86-755) 8603 7559

☎ (86-755) 8637 2611

✉ sales04@launch-china.cn

🌐 www.launch-china.com

www.chinabalustrade.com