

We have about 700pcs SS316 grade square base plate glass spigot with cover plate in stock. The SS316 grade glass spigot is surface mounted on both concrete and timber floor. There is no pre-hole made in the tempered glass panel. It is designed to hold **10/12mm tempered glass** fencing. The production lead time is about 7-15 days based on different quantity.

Product description of square base plate glass spigot

- net weight:2.1kg
- glass thickness:10/12mm
- SS316grade material
- base plate type,surface mounted for installation on the concrete and timber floor
- fast delivery

1.drawing

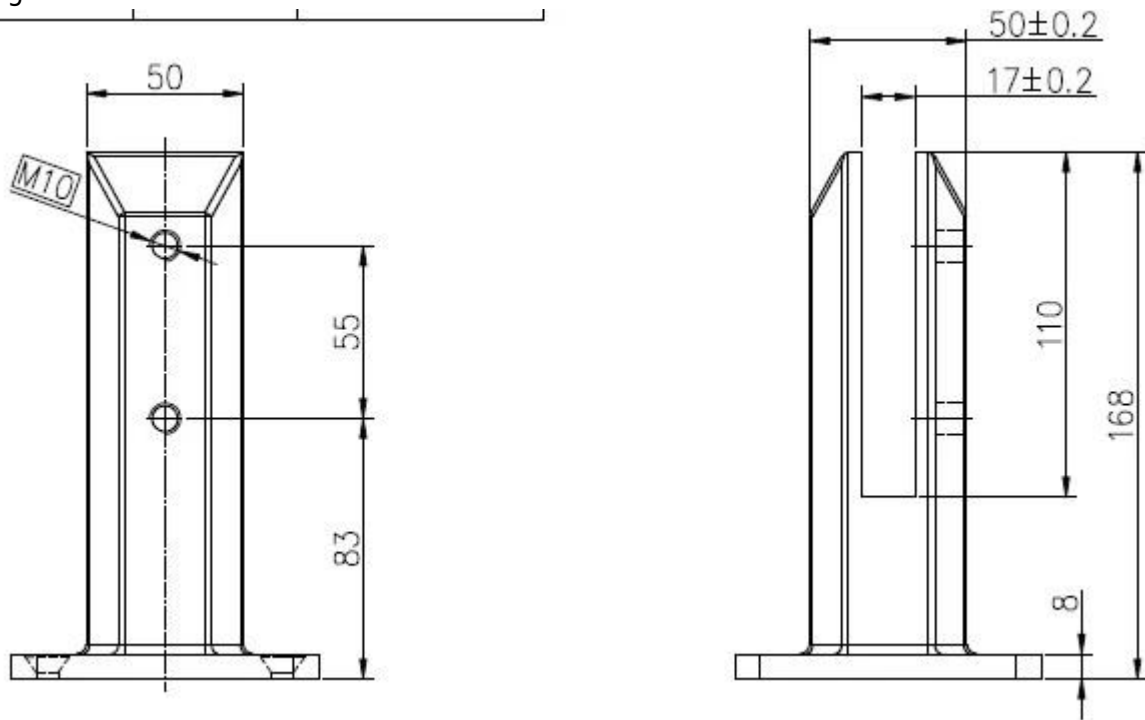

2.brushed finish



3.mirror finish



4.project pic
for balcony,timber decking

frameless glass railing with spigot



for pool fencing,concrete decking



5. we also have [frameless round and square core drill glass spigot](#)





6. [self closing glass hinges](#) and [latches for glass door](#) available



This is Susie Fu ^.^ . Please feel free to contact me if interested. Thanks for your time.