

Best choice of home renovation interior stair glass railing design , 316 stainless steel material .

Features-

1. square stainless steel post 40*40mm /50*50mm
2. 10-12mm thickness clear tempered glass
3. top handrail can be wood or stainless steel (50*25mm)
4. Brushed or poished finish

Photos of stainless steel post for stair railing design-











Photos of cler tempered glass -

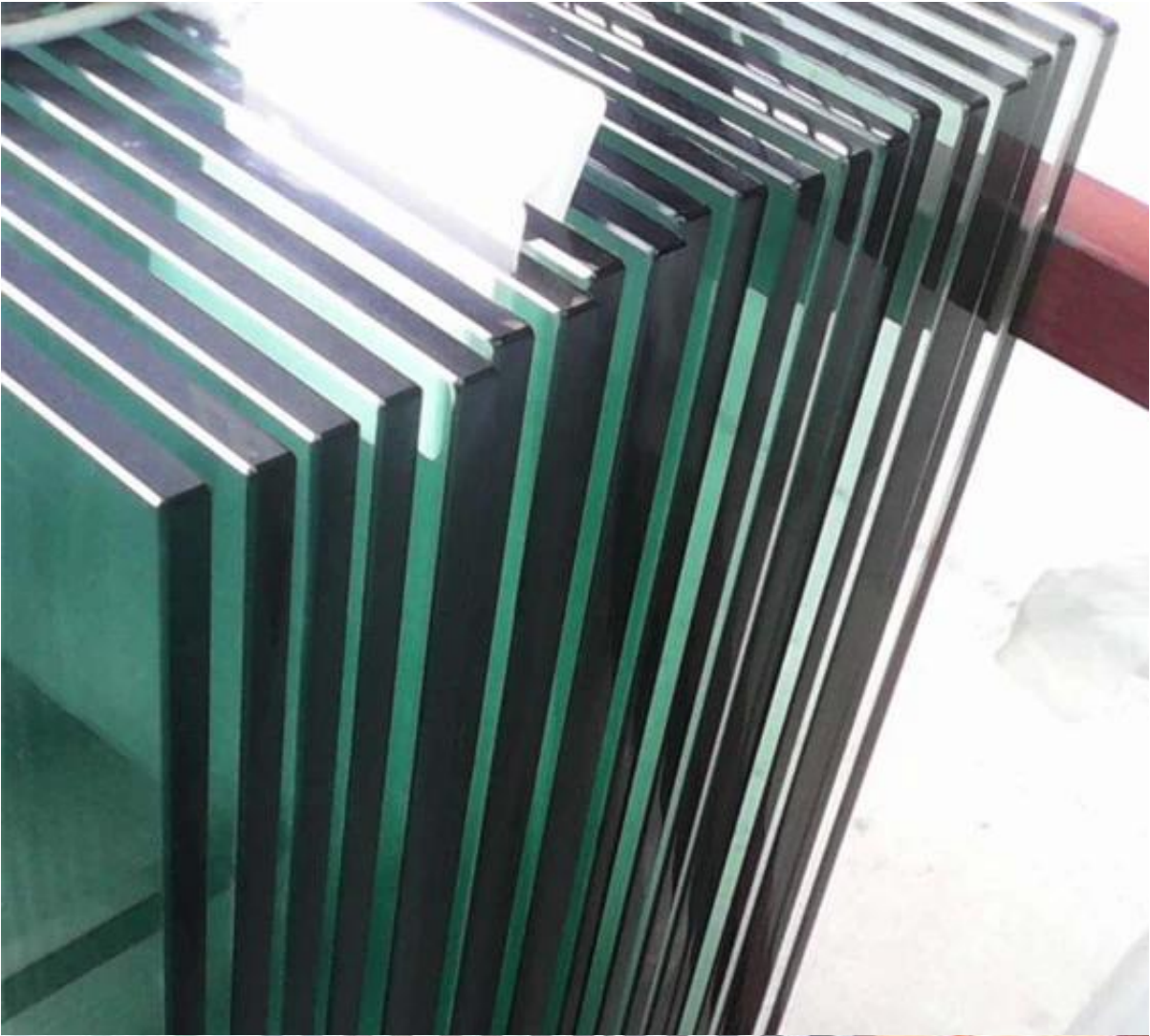



Project photos of stair railing design , stainless steel glass railings-

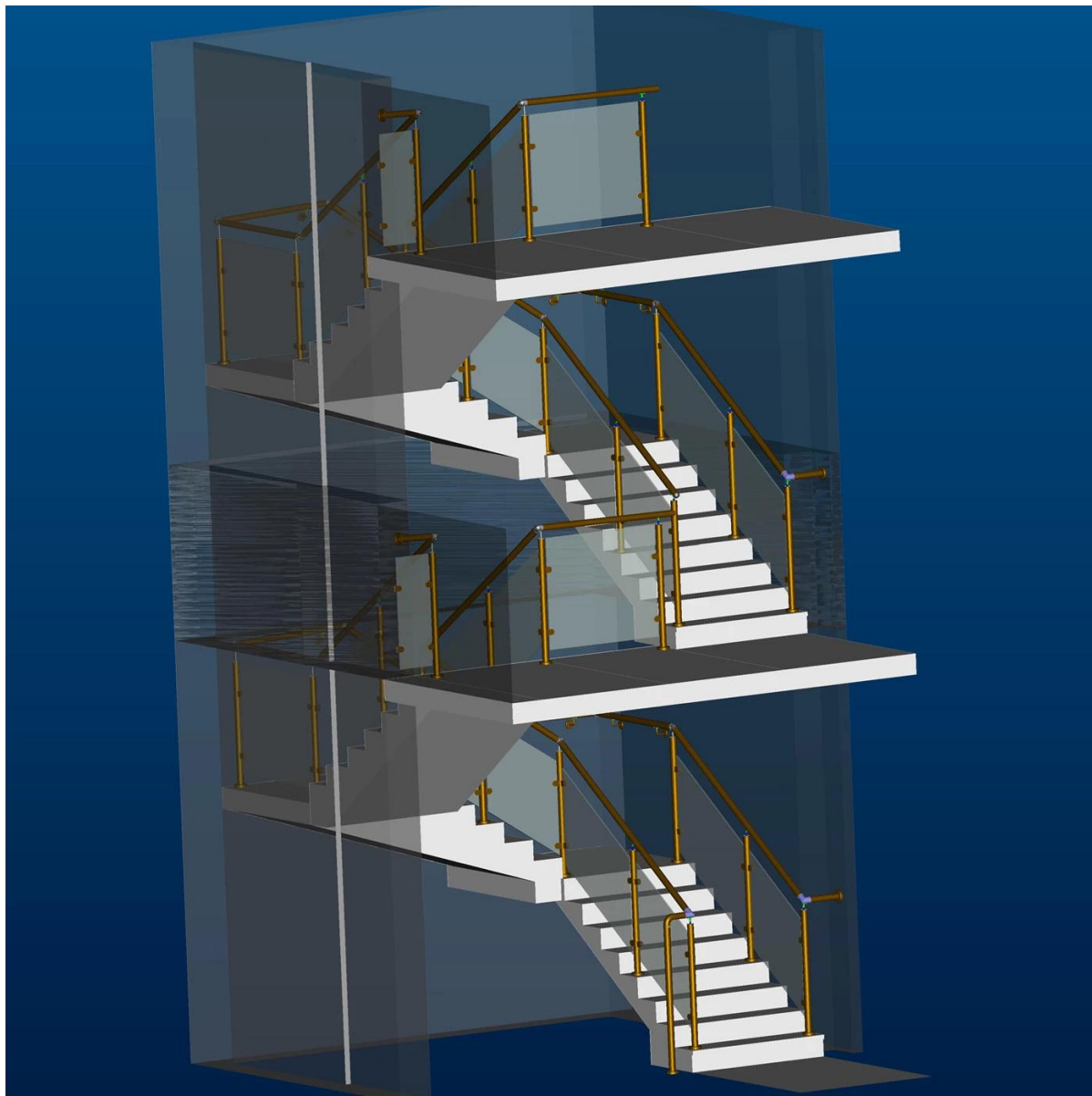







our glass railing can also be used for balcony railing designs -



