

## Stainless Steel 316 Glass Standoff Glass Mounting Hardware

Specifications :

- Material: Stainless steel 316
- Finish: Brushed or Mirror polished
- For glass thickness: 6-19mm thickness
- Solid, high quality, rubber gasket included

**1# Model: 2" Diameter by 1-1/2" ( 50mm x 38mm) Long Base Standoff**









**2# Model:** Diameter 50mm x 44mm Long Base Standoff



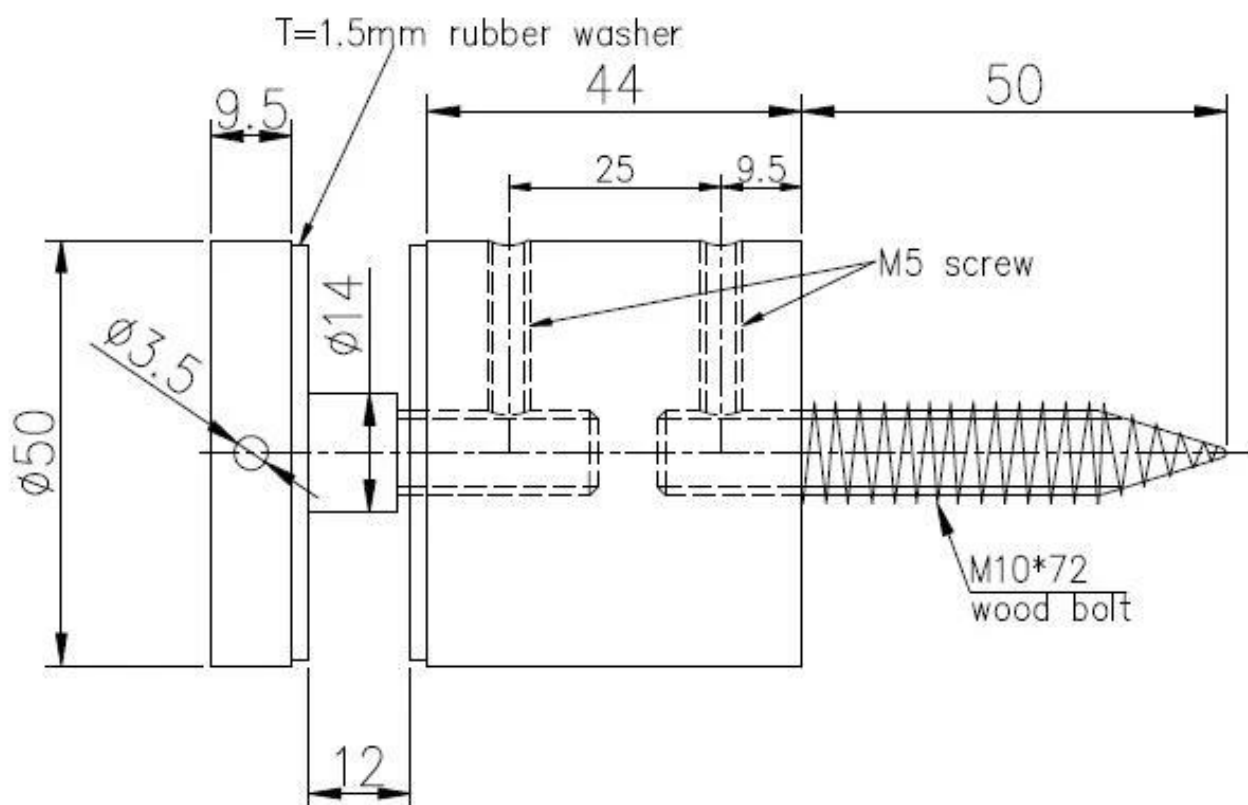

Thanks for your visiting. Any interested or question, please reach me out freely:

Email: [sales05@launch-china.cn](mailto:sales05@launch-china.cn)  
Whatsapp: 0086 13129593615