

Stainless steel Side Mounted Glass Spigot for glass

railings , the side mounted spigots hold 3/8" or 1/2" thickness tempered glass panels and need glass holes for fixing , it is very stable & durable .

Features of Stainless steel Side Mounted Glass Spigot-

Code	SFM
Technique	made by CNC Machining
Glass holes	needed
Material	304/316 stainless steel
Finish	satin , mirror , black
Glass thickness	10-12mm (3/8"-1/2")
Height	143mm
Body	50mm
MOQ	2 pcs
Lead time	1- 3 weeks , depending on stock

Photos of Stainless steel Side Mounted Glass Spigot-













Drawing of Stainless steel Side Mounted Glass Spigot-

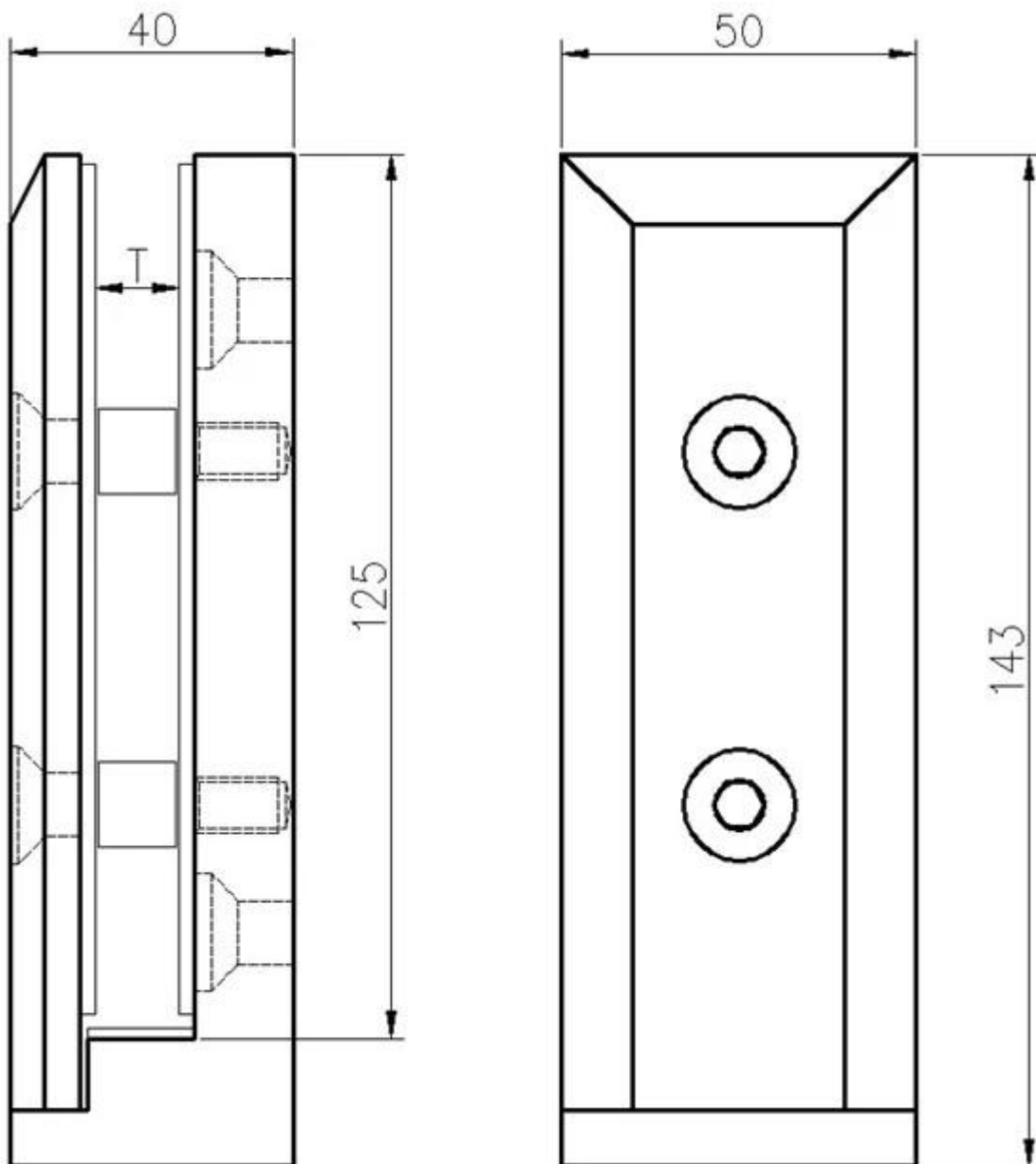

Installation photos of Stainless steel Side Mounted Glass Spigot-









